



# Community Meetings

## *Community Feedback*

July 23<sup>rd</sup> -

Second Pilgrim Baptist Church

July 24<sup>th</sup> -

Pennsylvania Horticultural Society

# BENJAMIN FRANKLIN PARKWAY:

# An Action Plan



# What's your bright idea for the Parkway?

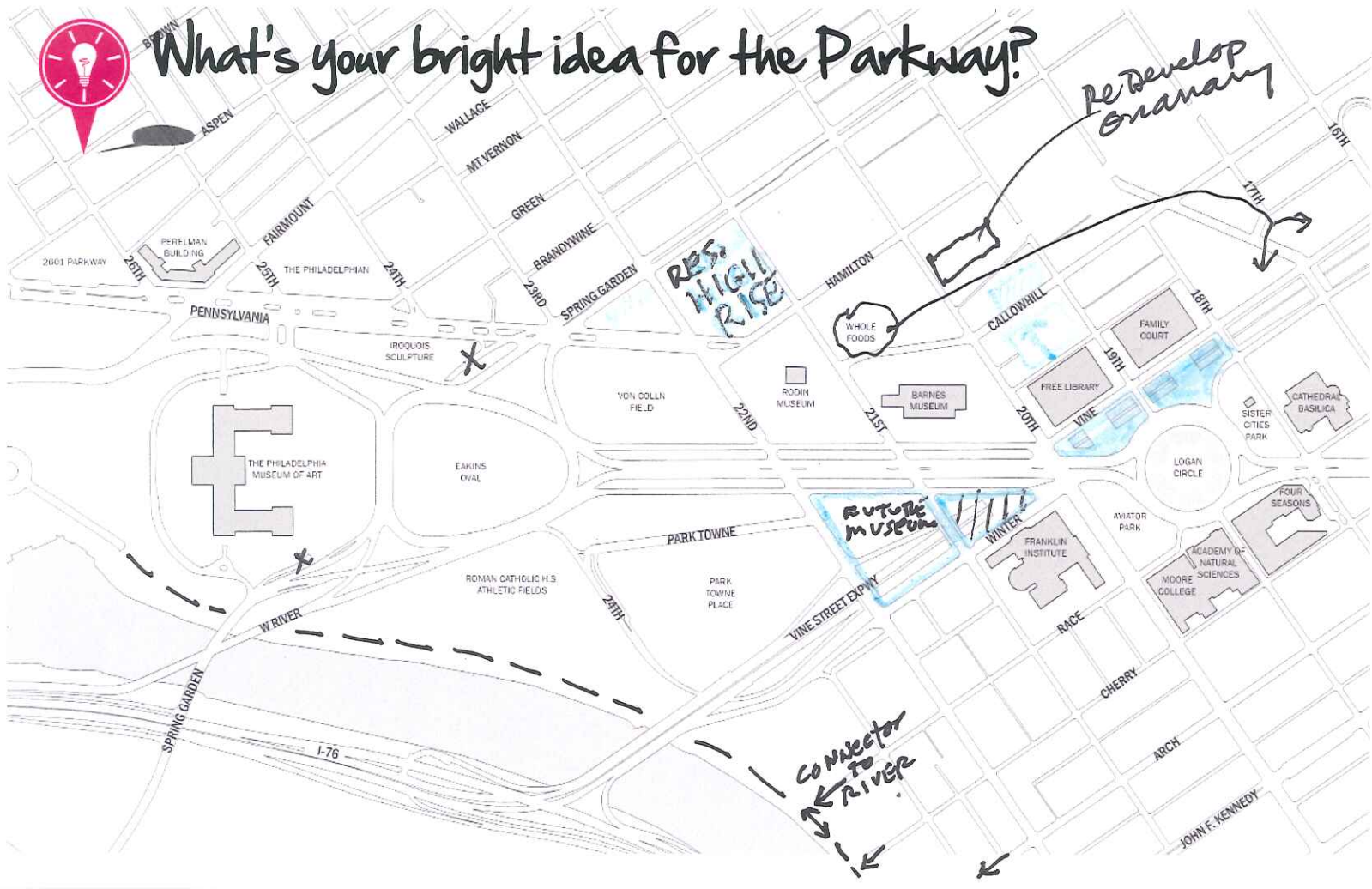

# The Parkway is...





# What's your bright idea for the Parkway?



# What's your bright idea for the Parkway?

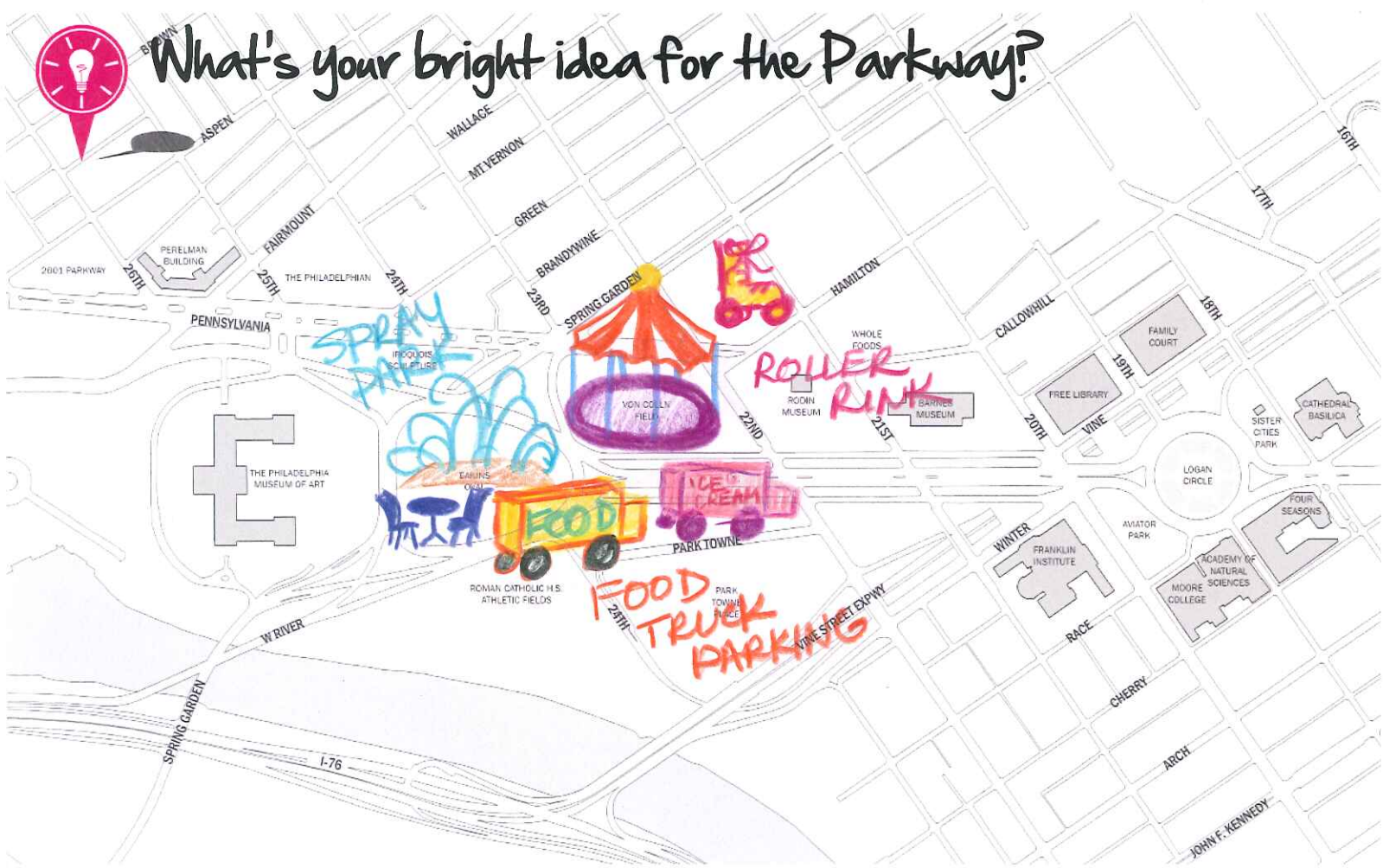



# What's your bright idea for the Parkway?

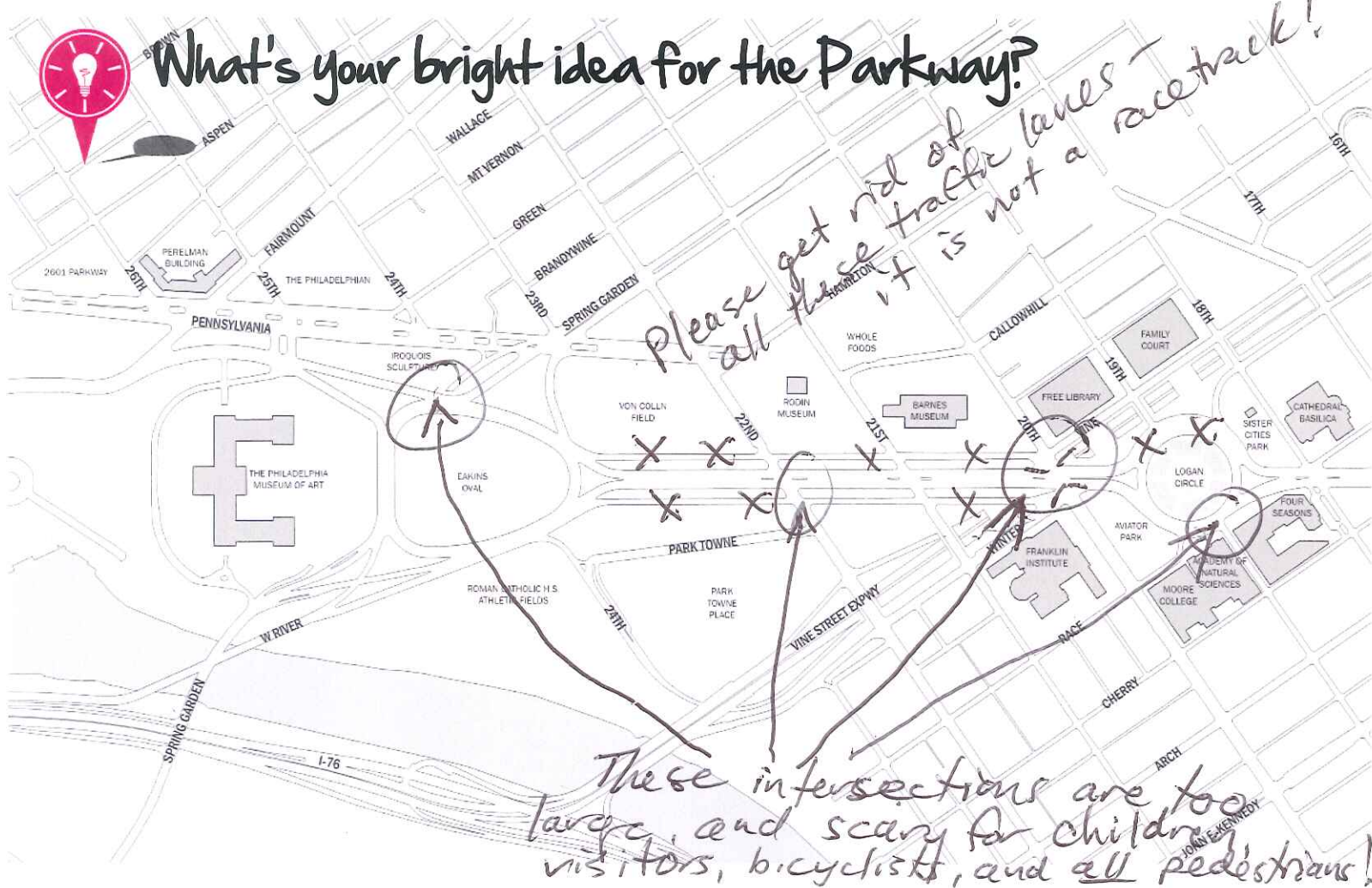

# What's your bright idea for the Parkway?





# What's your bright idea for the Parkway?

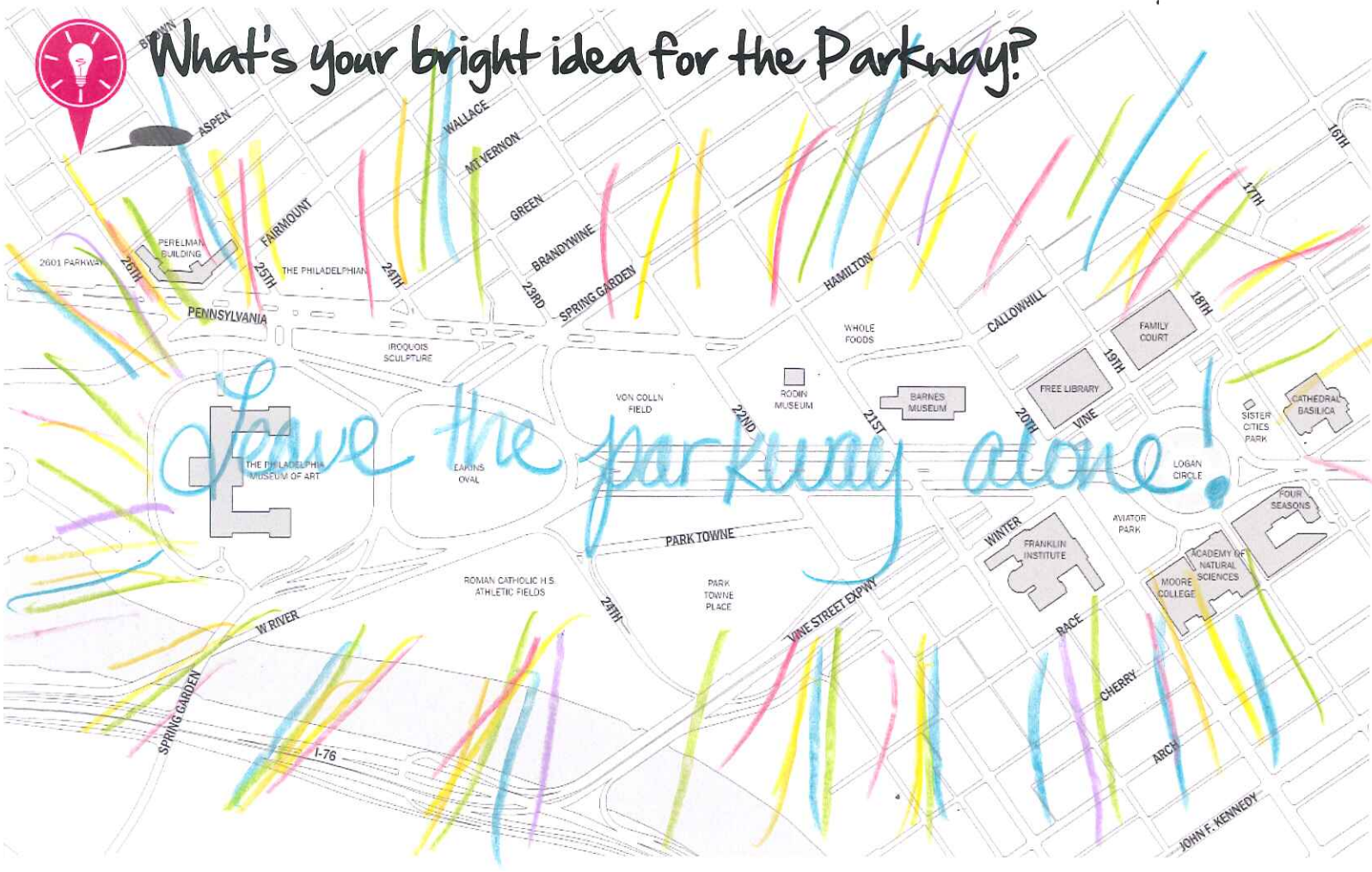

Leave the parkway alone!



# What's your bright idea for the Parkway?

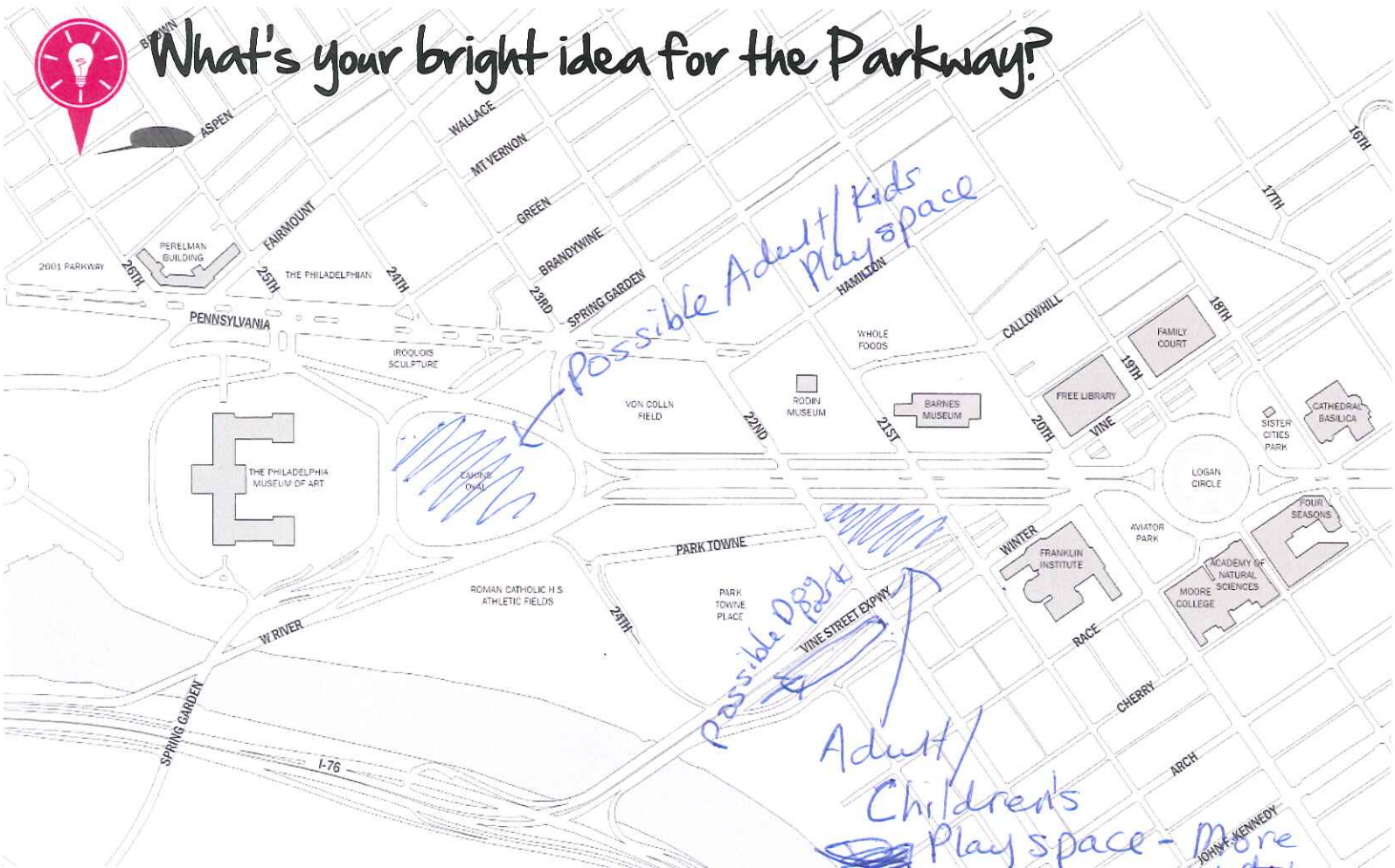

Possible Adult/Kids Play space

Possible Adult/Children's Play space - more



# What's your bright idea for the Parkway?

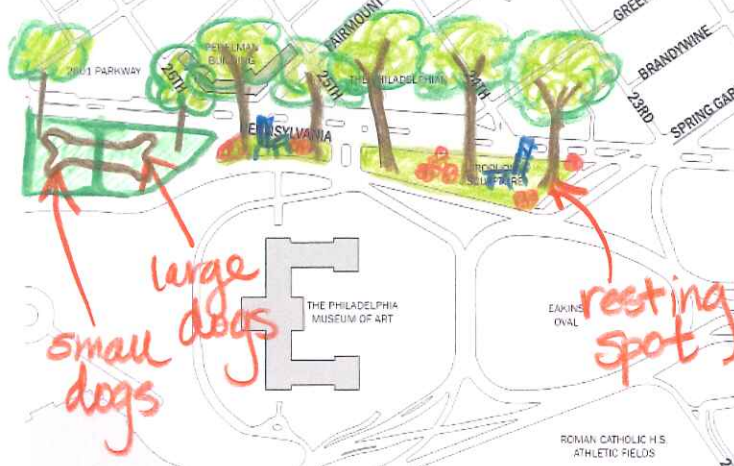

small dogs  
large dogs

resting spot



# What's your bright idea for the Parkway?

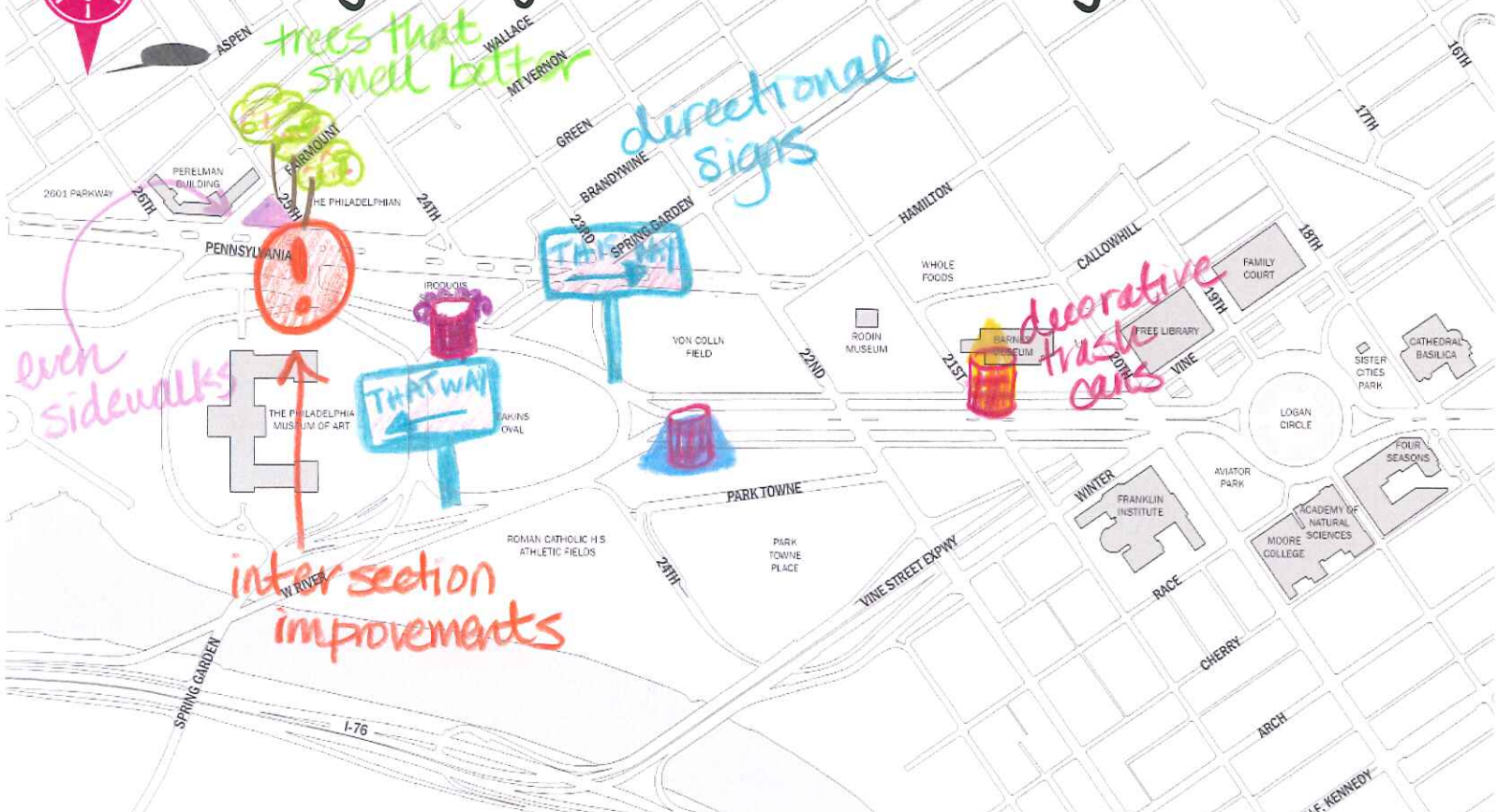

trees that smell better

directional signs

decorative trash cans

even sidewalks

intersection improvements



The Parkway is...

My first impressions!

High ART PARK

COOL OFF PARK

Science PARK

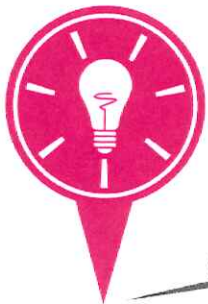

What's your bright idea for the Parkway?

Handwritten lines for notes.

TRAFFIC

CALMING

Handwritten lines for notes.



# What's your bright idea for the Parkway?

Repair sidewalks along Runny Mena Ave & create traffic calming islands at each of the numbered streets between Hallowell + Hamilton (from the Pearlman to the Rodin)!



# What's your bright idea for the Parkway?



Deal with homeless food distribution

Need ability to cross parkway on foot w/out a signal light change

Add Pocket Park

Enhanced playground

Skateboard Park

where do the bikes go from here?





# What's your bright idea for the Parkway?

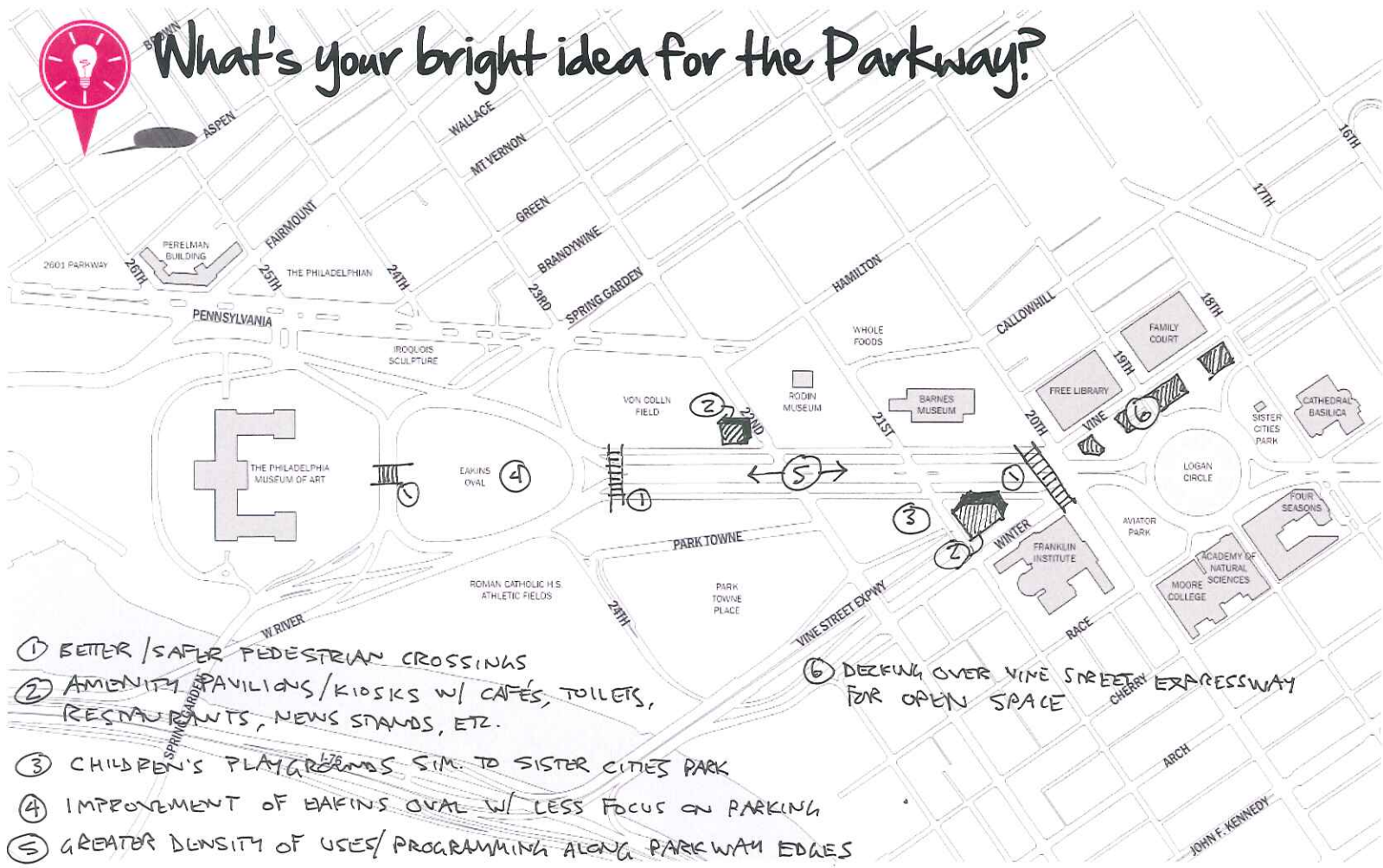

- ① BETTER / SAFER PEDESTRIAN CROSSINGS
- ② AMENITY PAVILIONS / KIOSKS W/ CAFÉS, TOILETS, RESTAURANTS, NEWS STANDS, ETC.
- ③ CHILDREN'S PLAY AREAS SIM. TO SISTER CITIES PARK
- ④ IMPROVEMENT OF BAKINS OVAL W/ LESS FOCUS ON PARKING
- ⑤ GREATER DENSITY OF USES / PROGRAMMING ALONG PARKWAY EDGES
- ⑥ DECKING OVER VINE STREET EXPRESSWAY FOR OPEN SPACE

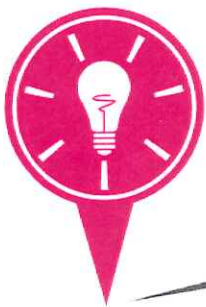

# What's your bright idea for the Parkway?

Green the islands that separate the traffic lanes and possibly make them wider. Hard to cross the parkway without stopping on one of them.

---



---



---



---



---



---



---



What's your bright idea for the Parkway?

MORE PARK  
LESS WAY

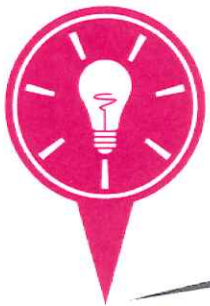

What's your bright idea for the Parkway?

• Better crowd control when there are Parkway events.

• DO NOT Permit "PAID" / ticketed events  
we have many other places for this.

- Residents need access to their homes during Parkway events
- Stop trucks in front of institutions, e.g. Franklin Institute.
- Beautify / Improve <sup>(Sunday)</sup> Pennsylvania Ave.
- Could there be SATURDAY AM STORY BOOK readings for kids
- Could there be CRAFTS OR LEARNING activities on Saturday/Sundays for kids - painting, juggling, making paper & knives, etc.
- BRING BACK Aerobics



The Parkway is... ONE OF THE MAJOR CULTURAL VEINS OF THE CITY. IT NEEDS TO CONTINUE TO FLOURISH & BE SUPPORTED.

NOT ONLY IS IT IMPORTANT FOR THE ARTS BUT TOURISM & THE CITY'S ECONOMY.



What's your bright idea for the Parkway?

Safe walkways to cross the parkway <sup>near the library</sup> <sup>art museum</sup>  
(currently, the lights do not make it possible for someone who cannot walk briskly to cross all the way - i.e. they'll have to stop on the median - potentially in the hot sun)  
Also safe + more paths to walk to the Art Museum

Now that there is also the Barnes Exhibit Museum + the refurbished Rodin Museum, there is even more reason to make the Parkway more pedestrian friendly. Currently there are not sufficient paths/crosswalks to get to the Art Museum (on the side with the steps - facing the parkway)



# What's your bright idea for the Parkway?

• CHILDREN PLAY AREA(S) + DOG PARK(S)  
ON EACH SIDE OF PARKWAY (NORTH + SOUTH)

- BETTER CROSSING OF THE PARKWAY; PARTICULARLY 20<sup>TH</sup> ST.
- ENGAGE BALL FIELD ON EACH SIDE BETTER
- BETTER DEAL WITH (LANDSCAPE + UMINATE) @ PENN. AVE. ON NORTH + WINTER ST. ON SOUTH
- DEAL W/ BACKED UP TRAFFIC @ PARK TOWN PLACE ONTO 22<sup>ND</sup> ST.



# What's your bright idea for the Parkway?





The Parkway is... A very nice place to enjoy your day. We need to make sure it is always accessible to everyone (handicapped).



What's your bright idea for the Parkway?

① Sculpture Park - like Neshoen in DC where the Calder Museum would have gone or in Capens Oval - (ditch parking there!)

② Bike Share Rentals - near Boy Scout Bldg.

③ Street art - that is, on the street like Banksy, etc. - changing

④ More temporary art installations - Pop Up art (but juiced)

⑤ Art. Vendors & Music like at Chestnut St Park



What's your bright idea for the Parkway?

MAKE SURE DEVELOPMENT OF  
1801 VINE ST. BUILDING (FAMILY COURT)  
IS TRUE TO ORIGINAL "CITY  
BEAUTIFUL" CONCEPT OF B.F. PARKY.



What's your bright idea for the Parkway?

SAVE PHILADELPHIA'S STATUES  
OF FOUR GREAT UNION GENERALS  
BY MOVING THEM TO THE PARKWAY

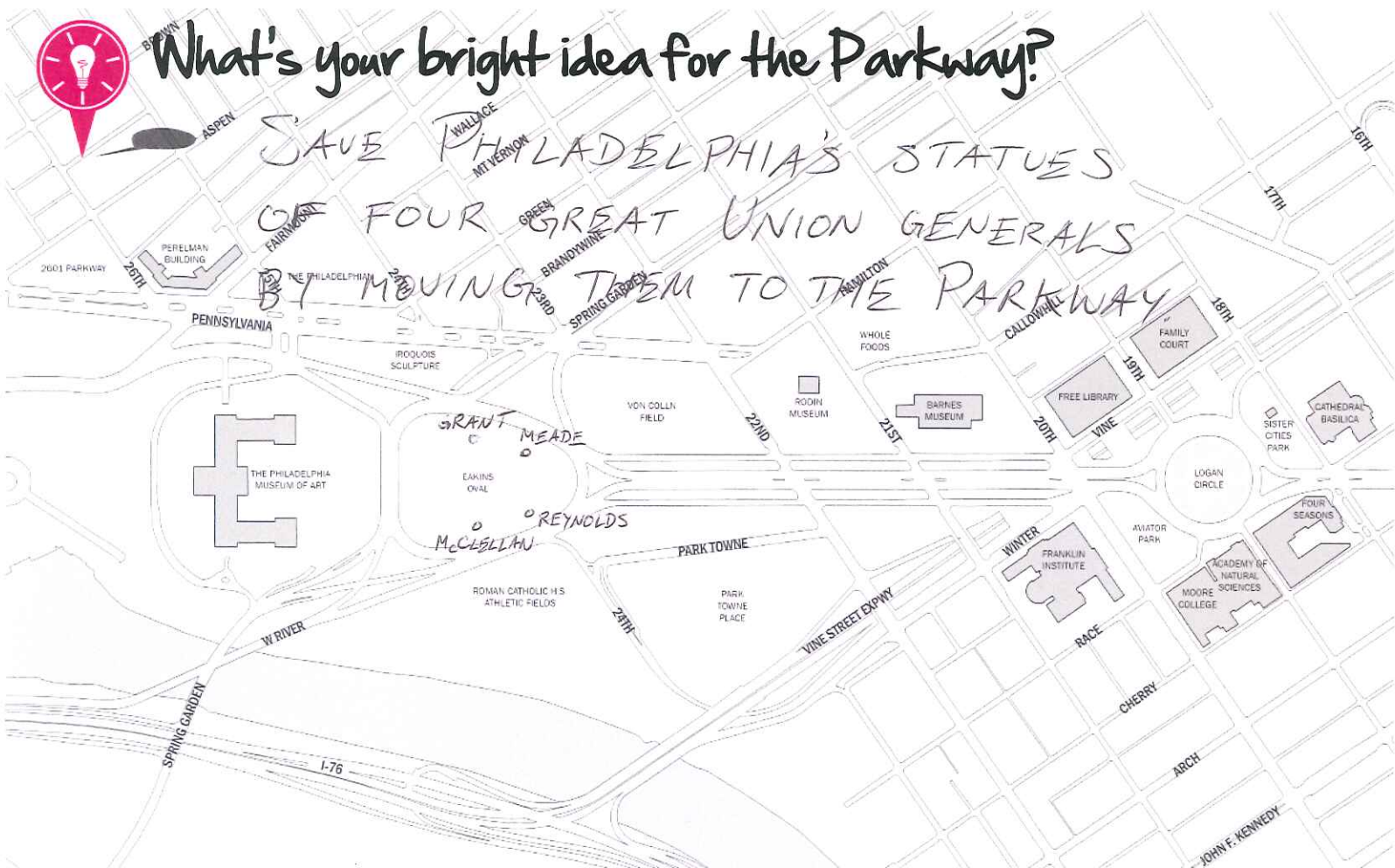



## What's your bright idea for the Parkway?

Bathrooms

Outdoor fitness (incl

playground

Tai Chi)

after initial installation how  
will venue be maintained

old fashion band stand for <sup>small</sup> musical  
presentations

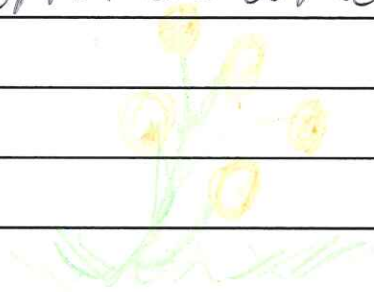

## What's your bright idea for the Parkway?

Cut back on the events. Too many charity  
walks/runs, too many parades. - How about

having some of these out in the centennial  
Park, at Memorial Hall? No building involved  
just the political will.

Restart the fountains on the Art Museum steps.  
Make 20<sup>th</sup> street pedestrian crossing at the Parkway  
a 60 second light.



What's your bright idea for the Parkway?

Make sure the churches' access are protected, esp. during festivals + parades



What's your bright idea for the Parkway?

WALKING FROM FAIRMOUNT AVE TO THE ART MUSEUM + THE PARKWAY (FRANKLIN INSTITUTE + ACADEMY OF THE ARTS) CAN BE DIFFICULT + DANGEROUS FOR PEDESTRIANS - REDESIGN THE TRAFFIC FLOW + CLOSE OUTER LANES TO CARS + ALLOW ONLY PETS + CYCLISTS. ALSO BRING THE NIGHT MARKET TO THE PARKWAY (FOOD VENDORS)





The Parkway is... A CIVIC SPACE FOR THE ENJOYMENT OF PEOPLE. THE TRAFFIC AROUND EAKINS OVAL ~~NEEDS~~ MUST BE CALMED, AS IT TENDS TO MAKE THE NORTH END OF THE PARKWAY A PLACE ONE WANTS TO ESCAPE. WALKING AND BIKING ARE UNPLEASANT AROUND ~~E~~ THE OVAL. TURN THE FOUNTAINS BACK ON AND REMOVE THE PARKING LOT IN THE OVAL! WHILE I LIKE ALL OF THE SUGGESTIONS, DOING SOMETHING <sup>(ANYTHING?)</sup> WITH THE OVAL SHOULD BE A TOP PRIORITY.



What's your bright idea for the Parkway?

Bikes

moving chairs

toilets

cafes along Pkway

kiosks

cross walks

water / gardens / play-walk area



The Parkway is...

MORE SPACE FOR  
THE ARTIST TO BE  
CREATING



The Parkway is...

NO PLACE FOR RETIREES  
THINGS AFTER 5PM IS  
A DEAD ZONE



## What's your bright idea for the Parkway?

HAVE YOU EVER BEEN TO MADRID?  
DURING THE SUMMER MOS THE  
CASTELLANA HAS A NUMBER OF TEMP.  
BARS + VENUES THAT ALLOW FOR ROAMING  
ACTIVITY UP + DOWN ITS LENGTH - THERE'S  
ALWAYS PEOPLE ON THE STREET HAVING  
A GOOD TIME - WHILE CAFE CRET + SIS BITTES  
ARE NICE THEY DO NOTHING TO PULL PEOPLE DOWN  
THE PKWY - AND THEY DON'T SERVE



## The Parkway is...

or rather extends beyond south st. to  
hopefully the historic Fairmount  
Water Works - as a central  
part of the park's history and a  
gateway to the Schuylkill Banks and a  
tremendous public resource, it would  
be a waste not to include in the  
discussion.

Karen Young  
Director, Fairmount  
Water Works



## What's your bright idea for the Parkway?

→ food or craft vendors / fairs (temporary)  
that can people along the  
length of the Parkway and  
manifest best pedestrian routes along.

- European style cafe / coffee kiosk with street  
level seating → again to bring people to  
the Parkway and keep them engaged  
and present to drive additional workshops.



## What's your bright idea for the Parkway?

Large events regular <sup>permanent</sup> toilet facilities  
Participatory - semi-permanent -  
are not the solution

'temporary' imaginary playground should be  
permanent

More people = more cars yuck Not  
end parking



# What's your bright idea for the Parkway?





## What's your bright idea for the Parkway?

— ~~Re~~ Reconcieve it. Think of it not as a way to bring the Park to CC, but the opposite — bring CC to the Park.

— Traffic: You will not be able to calm until you decouple either Kelly or MLK from Eakins Oval (and hence the Parkway).

— Parks: Less, but higher-quality, green space. Focus rec activity at LOVE, Logan, Eakins, Treat Eakins as the gateway to Fairmount Park. Relocate ballfields along Kelly.

— Urbanization: develop properties facing upper Parkway.

— Etc. Close lower Parkway (convert into greensward/mall). Square Logan Circle. Use City Branch to provide rail mass transit

Immediate Implementation: Active park uses around Art Museum



# What's your bright idea for the Parkway?

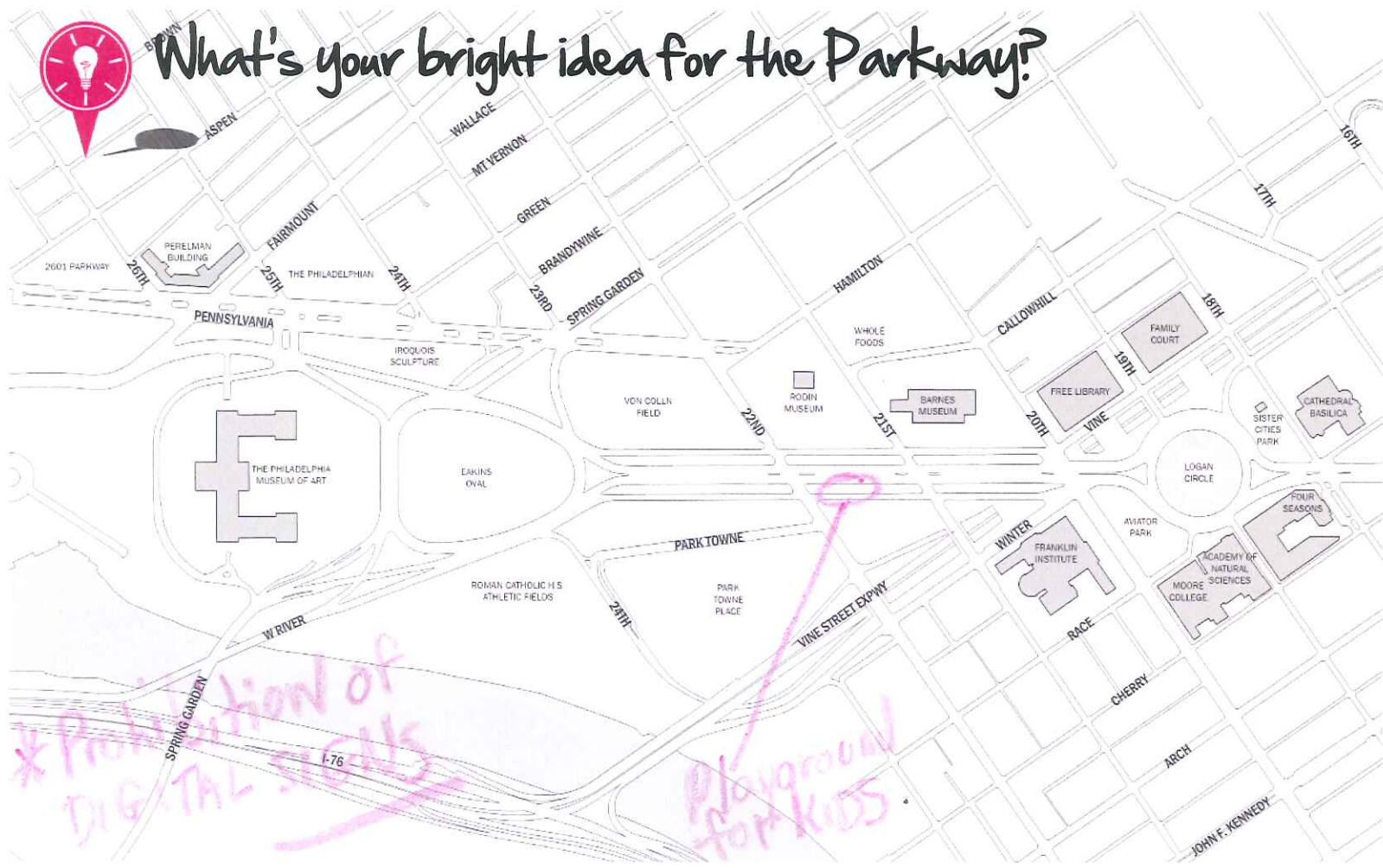

\* Prohibition of DIGITAL SIGNS

Playground for kids



What's your bright idea for the Parkway?

- ① Playground / Dog Parks
- ② Traffic Calming
- ③ Sign Controls





# What's your bright idea for the Parkway?

*Café as in Jardins  
des Tuileries. SERVE  
BEER & WINE*

*Keep!*





## What's your bright idea for the Parkway?

Do NOT make it into an amusement park, We live here

Make it possible to cross it in one go. OR enlarge the median to accommodate a walker and a baby carriage, the lights are timed to strand pedestrians in the center.

No crappy retail



# What's your bright idea for the Parkway?

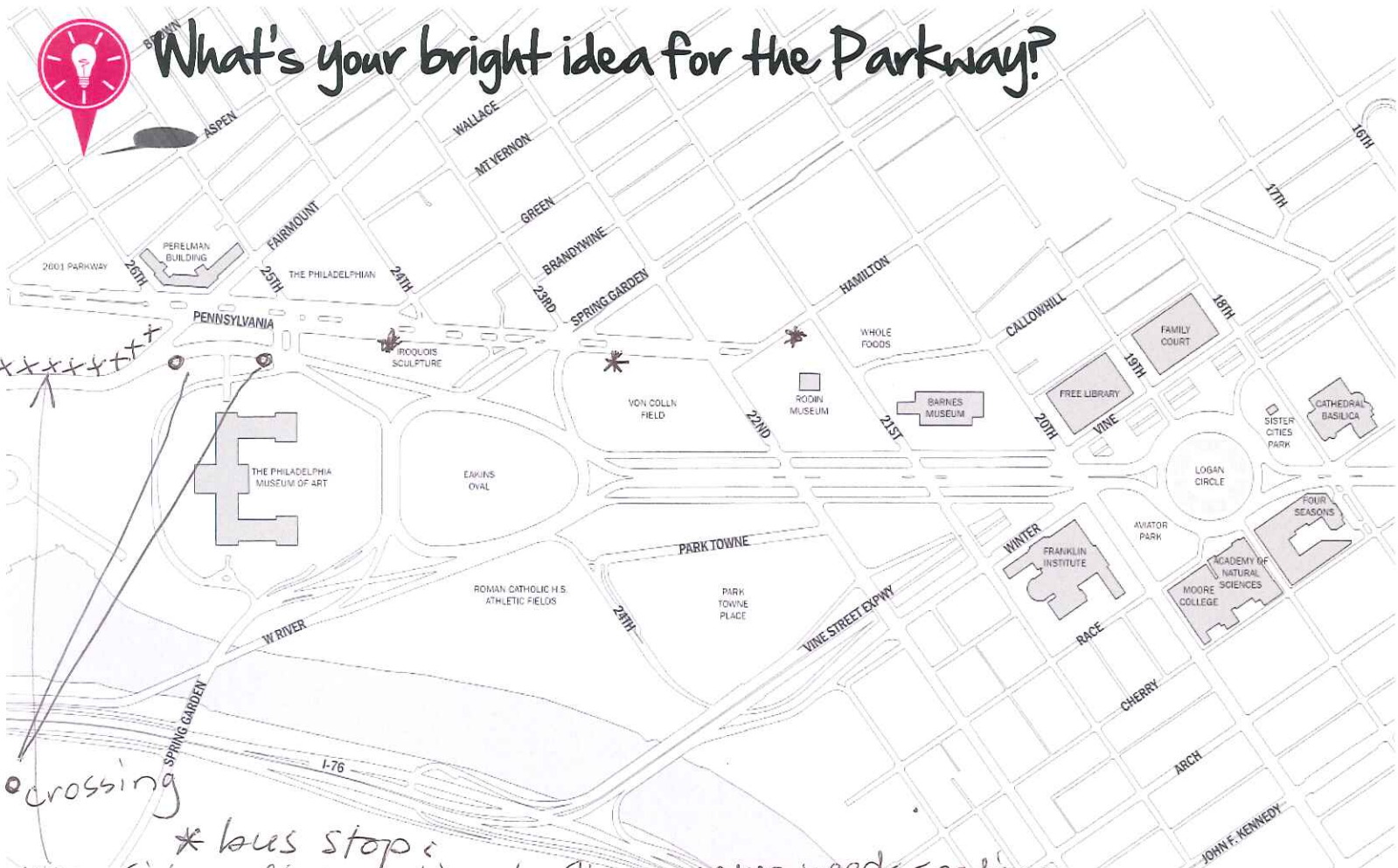

\* bus stop  
xxxxx Sidewalk past Lincoln Statue; area needs seating.



## What's your bright idea for the Parkway?

\* The ~~bus stops~~ bus stops along the Parkway on Penn. Ave are "hidden" + trashy looking. (#32 + 38 stops, 48 + 7 stops)

o Crossing for cyclists and pedestrians is dangerous, especially near the Joan of Arc statue.

xxxxx The sidewalk to the Lincoln statue is crumbling + terrible for bicyclists, especially taking this route to E. Fairmount Park. (reservoir loop)

Have an annual Ben Franklin kite flying <sup>making +</sup> <sup>event</sup> on Eakins Oval.



# What's your bright idea for the Parkway?



*close*

*lets*

*• Bike Friendly*  
*• Walk Friendly*  
*• Safety Patrols*



What's your bright idea for the Parkway?

- outdoor cafes! with outdoor seating

- moveable chairs to make own social space

- MAKE BFP 4 lanes  $\frac{1}{2}$  middle is restaurants / outdoor section



# What's your bright idea for the Parkway?

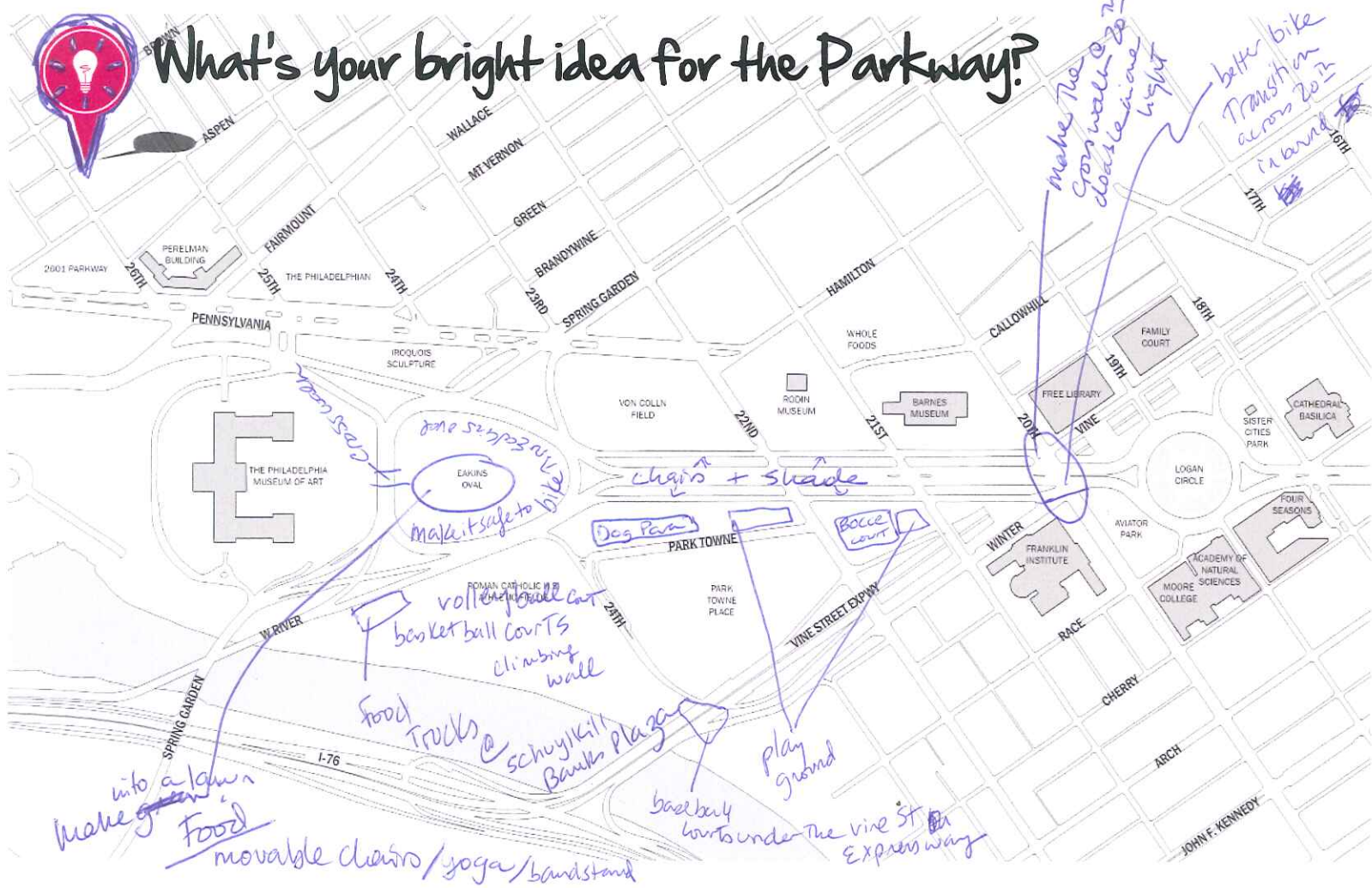

into a lawn  
make green  
Food

movable chairs/yoga/bandstand

volleyball court  
basketball courts  
climbing wall

Food Trucks @ Schuylkill Banks Plaza

baseball courts under the vine st Expressway

chairs + shade

Dog Park

Bocce court

play ground

crosswalk @ 20th  
crosswalk @ 20th  
higher

better bike transition across 20th  
bandstand



# What's your bright idea for the Parkway?

Parkway ~~softly from~~ offers very little to the neighborhood

Dogan Square neighborhood ~~has next to~~ needs

more recreation spaces. Please incorporate

The LSNA - Parkway Long Term Plan.

↳ Dog park!! ⇒ we really need one!

playground for young kids

bocce court

Food !!

Basketball courts / Cricket

Re-stripe ~~park~~ Fathens oval for bikes

~~Re-division~~ Get rid of parking lot - make green space

Cyclonia - Summer Streets in conjunction w/ Bike Race

~~Fix~~ Fix the crosswalk lights

@ 20th so that

you can cross safely

in one light to get to

The library!!

↳ priority given to ~~parents~~ visitors





# What's your bright idea for the Parkway?

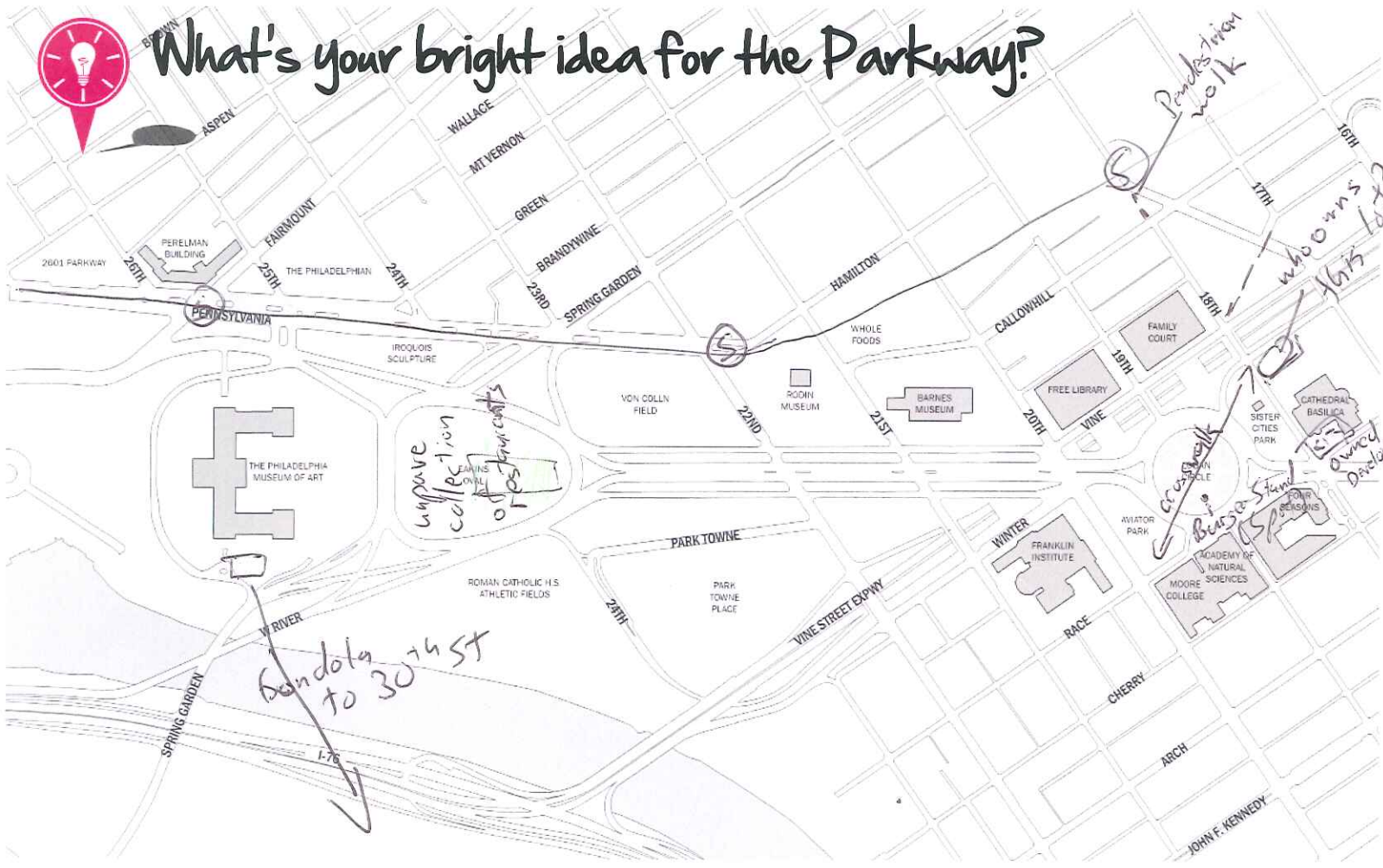

improve collection of artworks

Bendola to 30th St

Pondola to walk

who own in 16th St

crosswalk

Bernstein

owned Develop

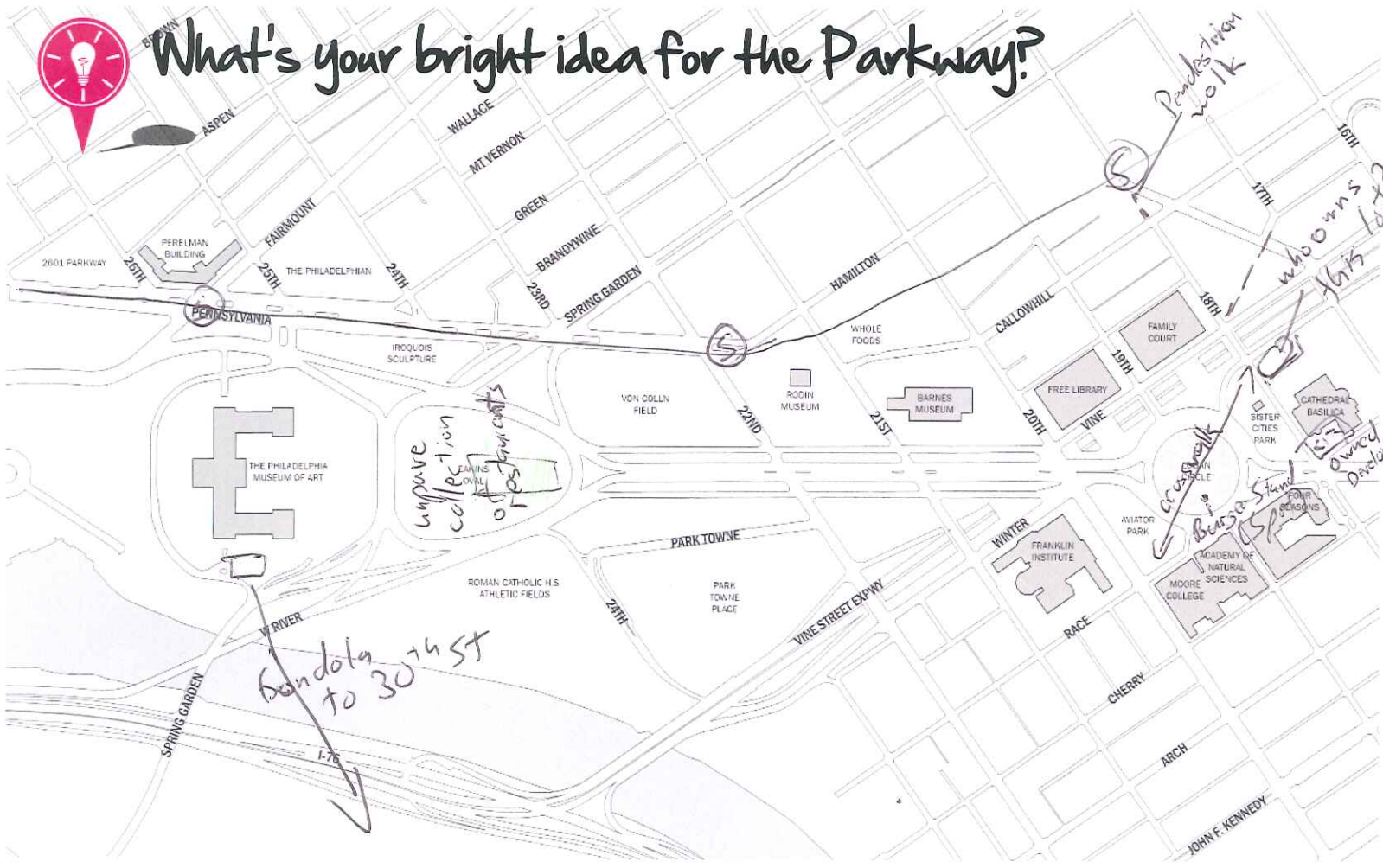



## What's your bright idea for the Parkway?

- ① Move Crosswalks to enable legal SW/NE foot traffic & crossings to circle
- ② redevelop city owned lot just south of church
- ③ collection of restaurants @ Ekins Oval. something for kids. emphasis on views  
carousel?
- ④ utilize city branch for transit service (ie FRA waiver Stadler DMU/EMU)
  - investigate potential for TOD along cut including Inby site
  - stops: O RTM, Broad, CCCP (RDA site?), 21<sup>st</sup>, Fairmont/museum, 29<sup>th</sup>
  - branch to West Park via 5th tunnel
- ⑤ Restore Logan Sq.
- ⑥ Burger Stand in Logan Circle (like SPOT burger)



# What's your bright idea for the Parkway?

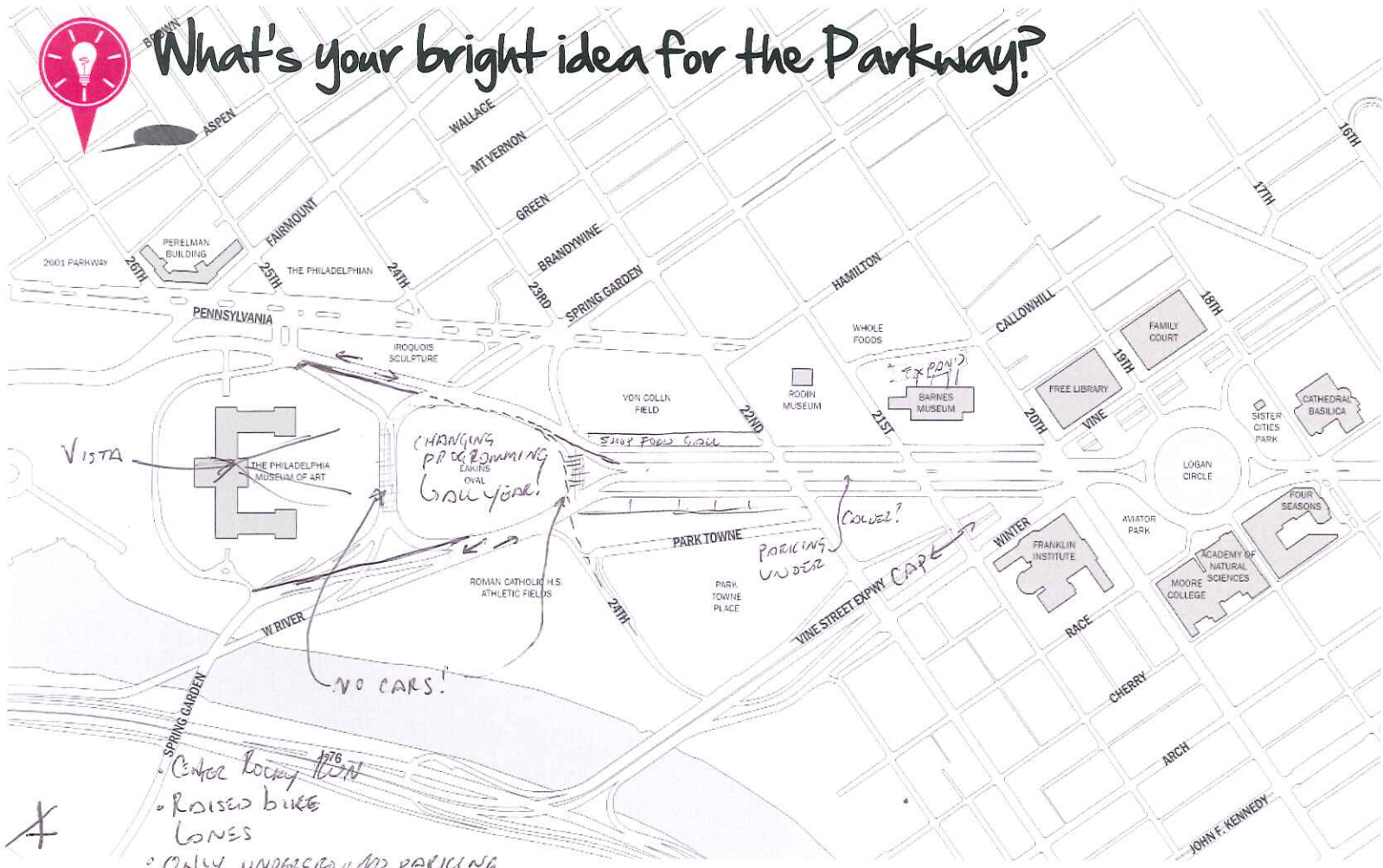

- Center looking West
- RAISED BIKE Lanes
- ONLY UNDERGROUND PARKING



## What's your bright idea for the Parkway?

- Create a real apron/public square at the PMA by closing the street there. Much to do for traffic, but a better idea.
- Evans Oval - All year rounds changing programming  
→ Open Air Cinema, plays, festivals, flea markets, dancing, etc.
- Real raised bike lanes
- A center "Rocky Run" free of traffic
- Free Wifi
- Cafes
- Beer gardens next to playgrounds
- Trash & Recycle bins
- Random acts of drama ~ street performers
- Underground parking only
- Restrooms
- Institutions engaging at the edge ...

Compton@gmail.com



# What's your bright idea for the Parkway?

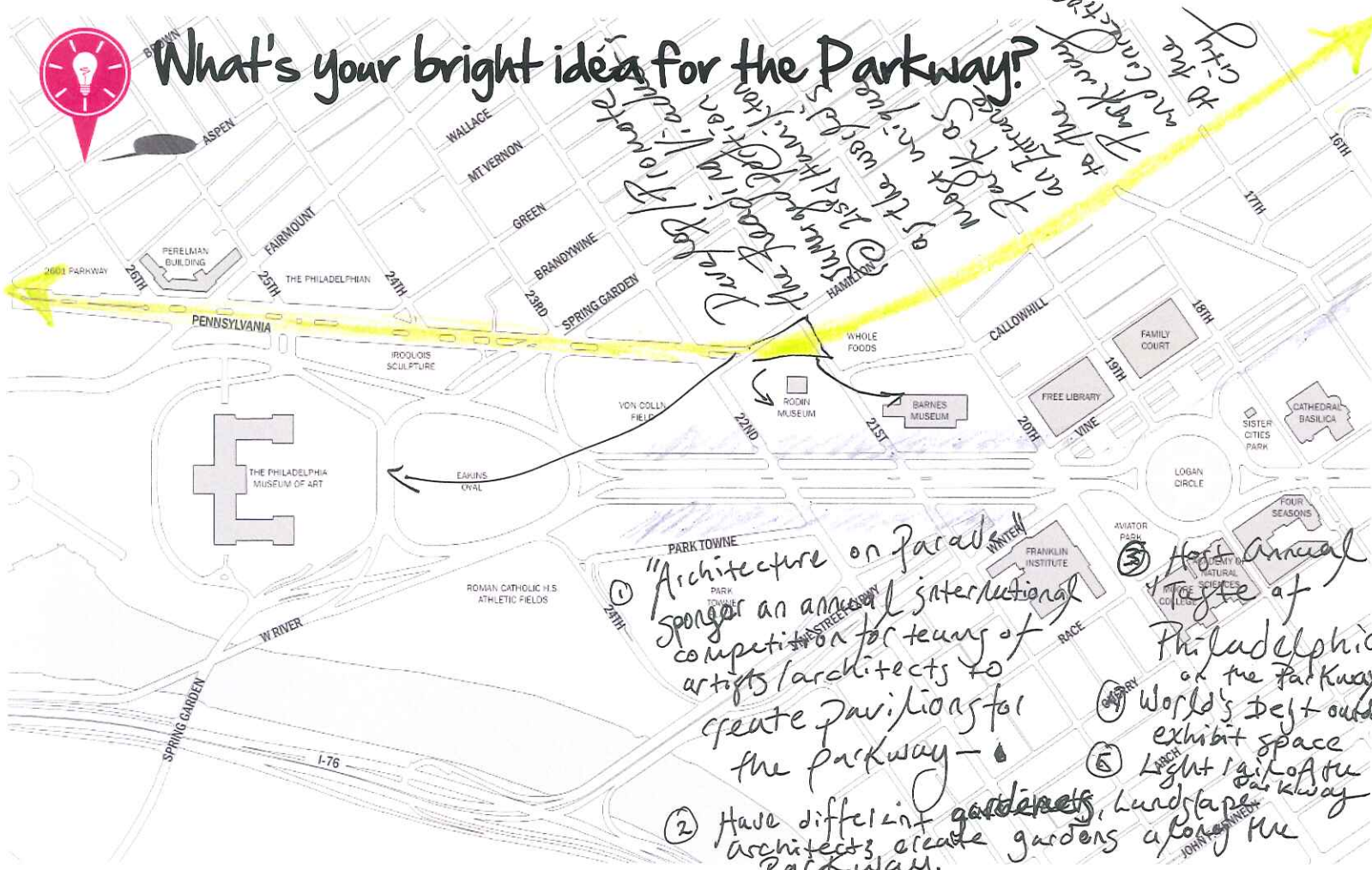

to the city and center to the Parkway  
 to the Parkway  
 an entrance to the Parkway  
 park as  
 next to the world's  
 the top of the world  
 the top of the world  
 the top of the world

- 1 "Architecture on Parade" sponsor an annual international competition for teams of artists/architects to create pavilions for the parkway -
- 2 Have different gardens, architects create gardens along the parkway.
- 3 Host Annual "Night of Philadelphia" at the Parkway
- 4 World's Best outdoor exhibit space
- 5 Light up the Parkway



THE PHILADELPHIA MUSEUM OF ART

PENNSYLVANIA

26TH

FARMOUNT

ASPEN

WALLACE  
MT VERNON

GREEN  
BRANDYWINE

23RD  
SPRING GARDEN

VON COLLN FIELD  
RODIN MUSEUM

EAKINS OVAL

ROMAN CATHOLIC HS  
ATHLETIC FIELDS

W RIVER

1-76

WHOLE FOODS

BARNES MUSEUM

22ND

21ST

PARK TOWNE

FRANKLIN INSTITUTE

24TH

RACE

AVIATOR PARK

JOHN PENNEDY

CALLOWILL

FREE LIBRARY

19TH

VINE

LOGAN CIRCLE

FOUR SEASONS

SISTER CITIES PARK

CATHEDRAL BASILICA

17TH

16TH



## What's your bright idea for the Parkway?

- I know these signs probably exist, but I always have a challenging time crossing streets on the Parkway and how to get to the Schuylkill River trail - Better Signage →



# What's your bright idea for the Parkway?

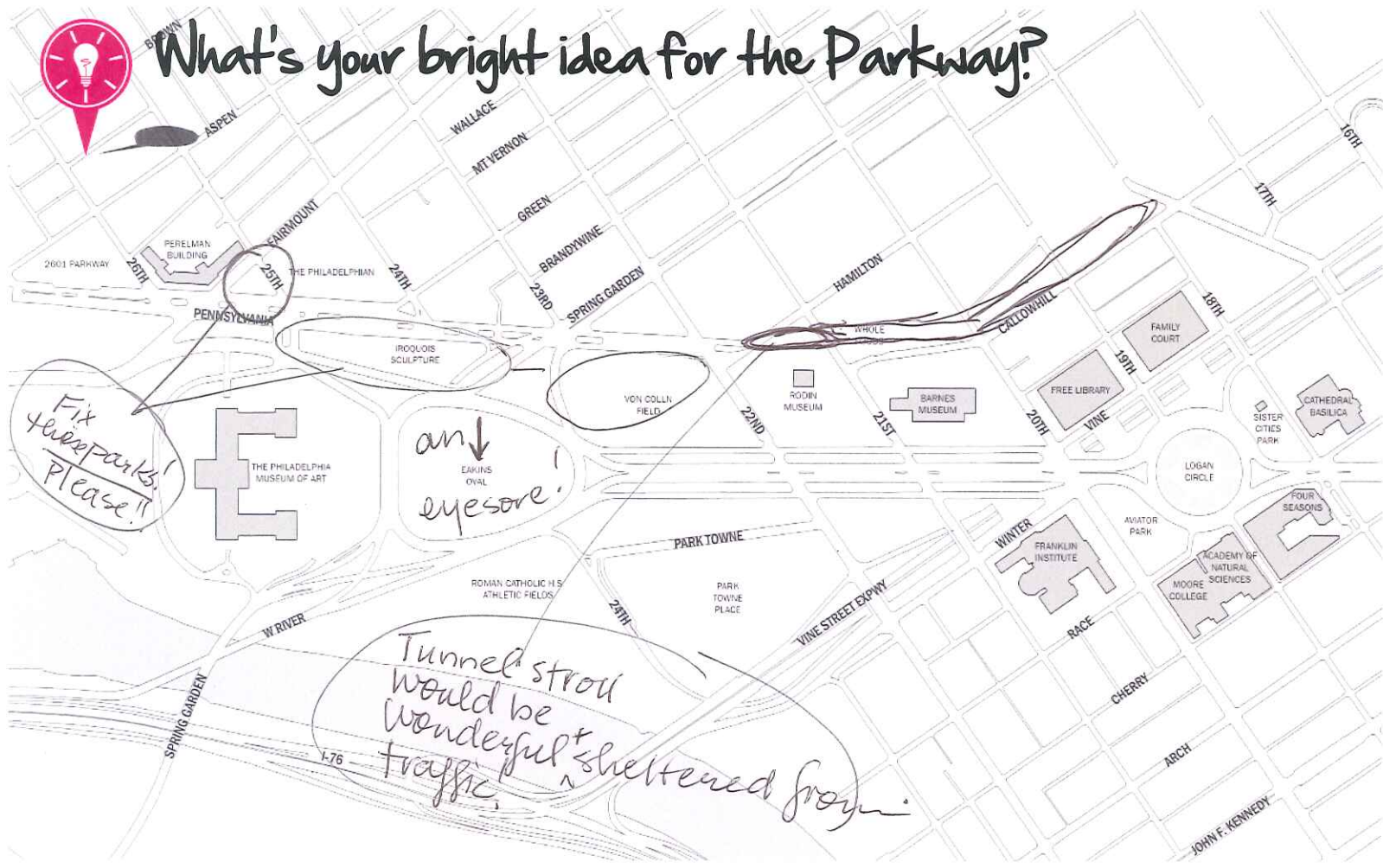

Fix these parks please!!

an eyesore!

Tunnel stroll would be wonderful + sheltered from traffic.

Sister Cities park brings all ages together... we need more of this along the Parkway!



## What's your bright idea for the Parkway?

Triangle Park at 25<sup>th</sup> St across from the Philadelphian & Perelman needs beautification! New landscaping + seating would improve the appeal to museum-goers and local residents.

The benches along Penn Ave. are decrepit and uninviting. Strollers (tourists & locals) need something like small "<sup>green</sup>waystations" like around the Rodin museum to stop and take a break or meet friends (<sup>or Azalea garden</sup>).

Small plantings with benches near the Iriquois Station would make the area more of a gathering place more than a dog park.





The Parkway is... *lacking transit options. So, extend PATCO*

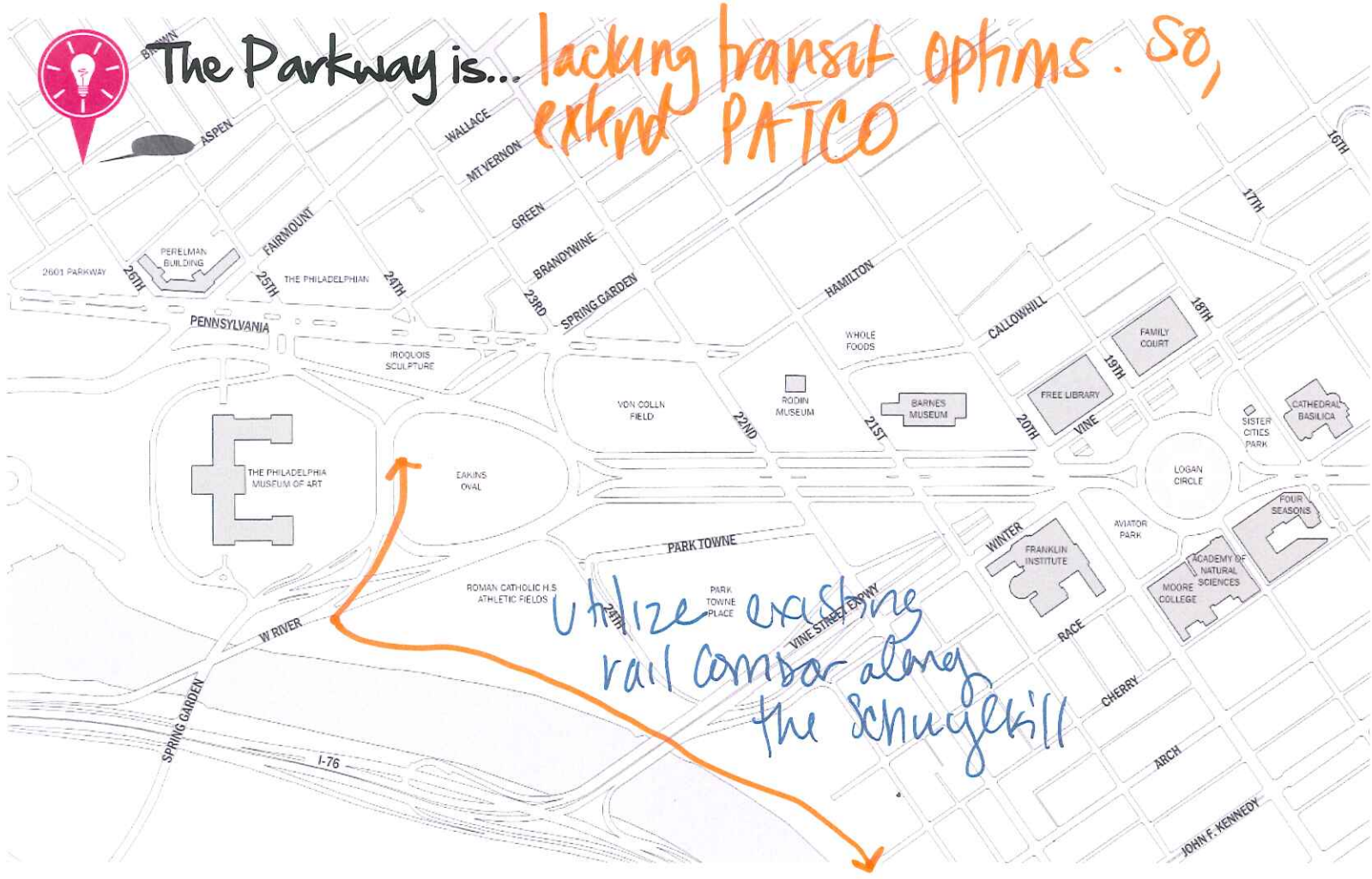

*utilize existing rail corridor along the Schuylkill*

# The Deal ..

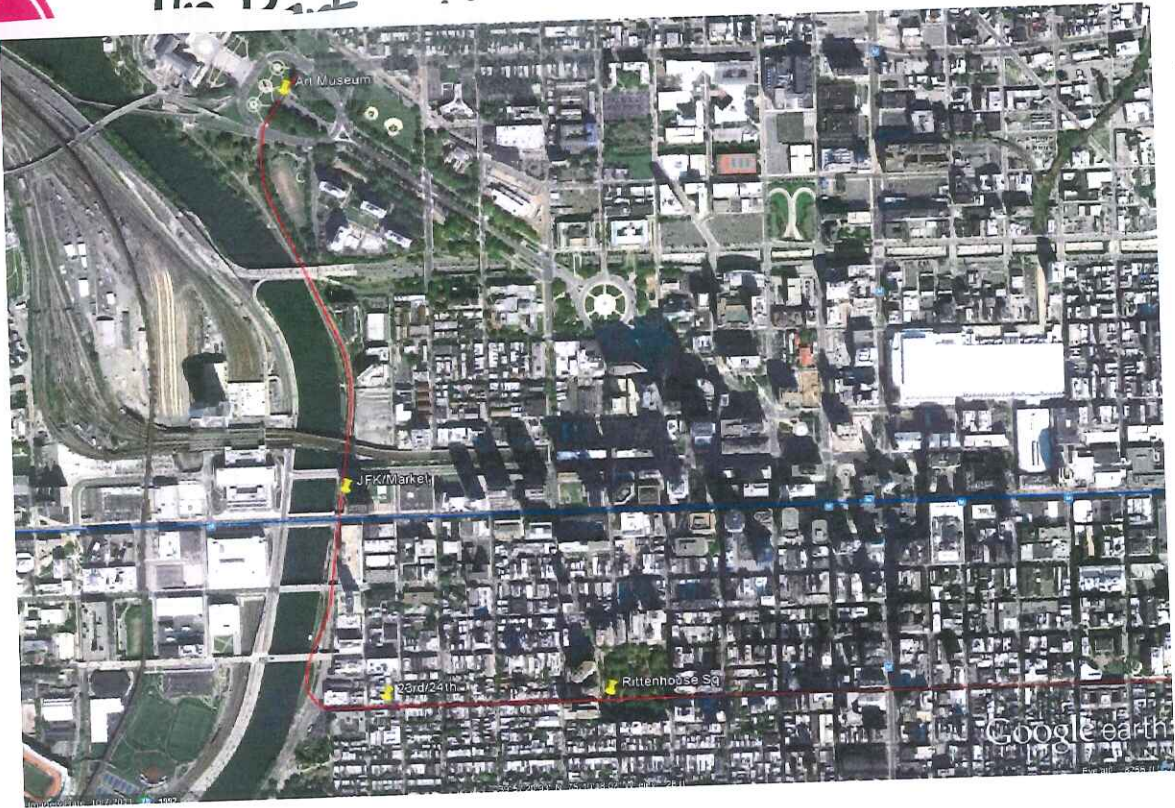

---

---

---

---

---

---

---

---

---

---

---

---

---

---

---

---

---



# What's your bright idea for the Parkway?

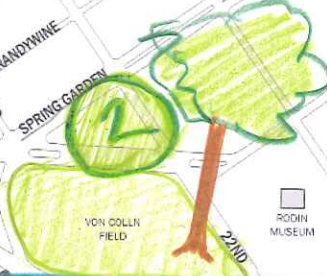



## What's your bright idea for the Parkway?

① too many cars, looks like a gas station

② events turn parkway into a moat rather than welcoming greenbelt

③ not necessary to "fill" everything, keep open spaces



The Parkway is...

Make these edges more lively!

Activate Me!

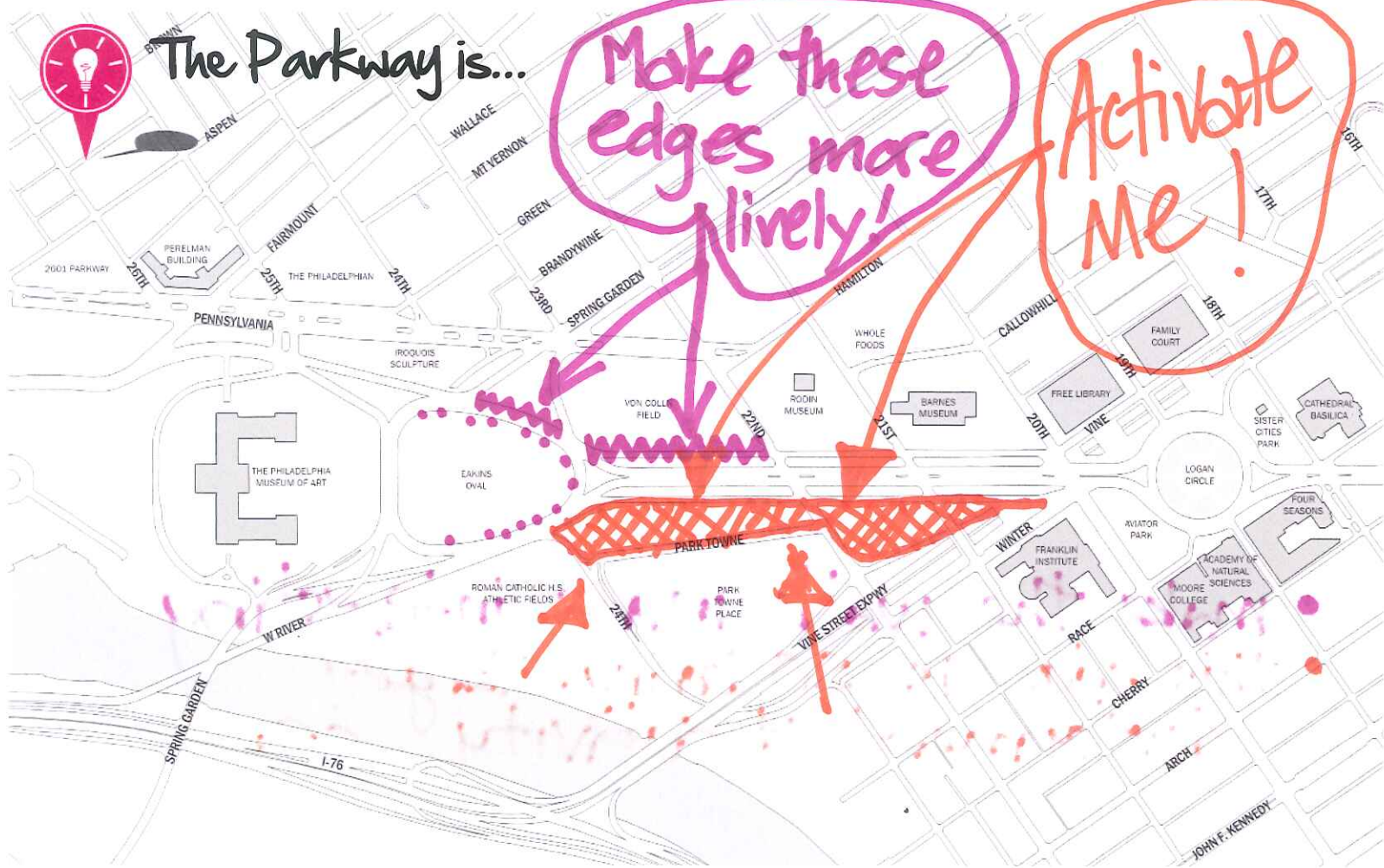



The Parkway is...

- make the walk more interesting
- this edge is SO boring. Target development & activity here



# The Parkway is...

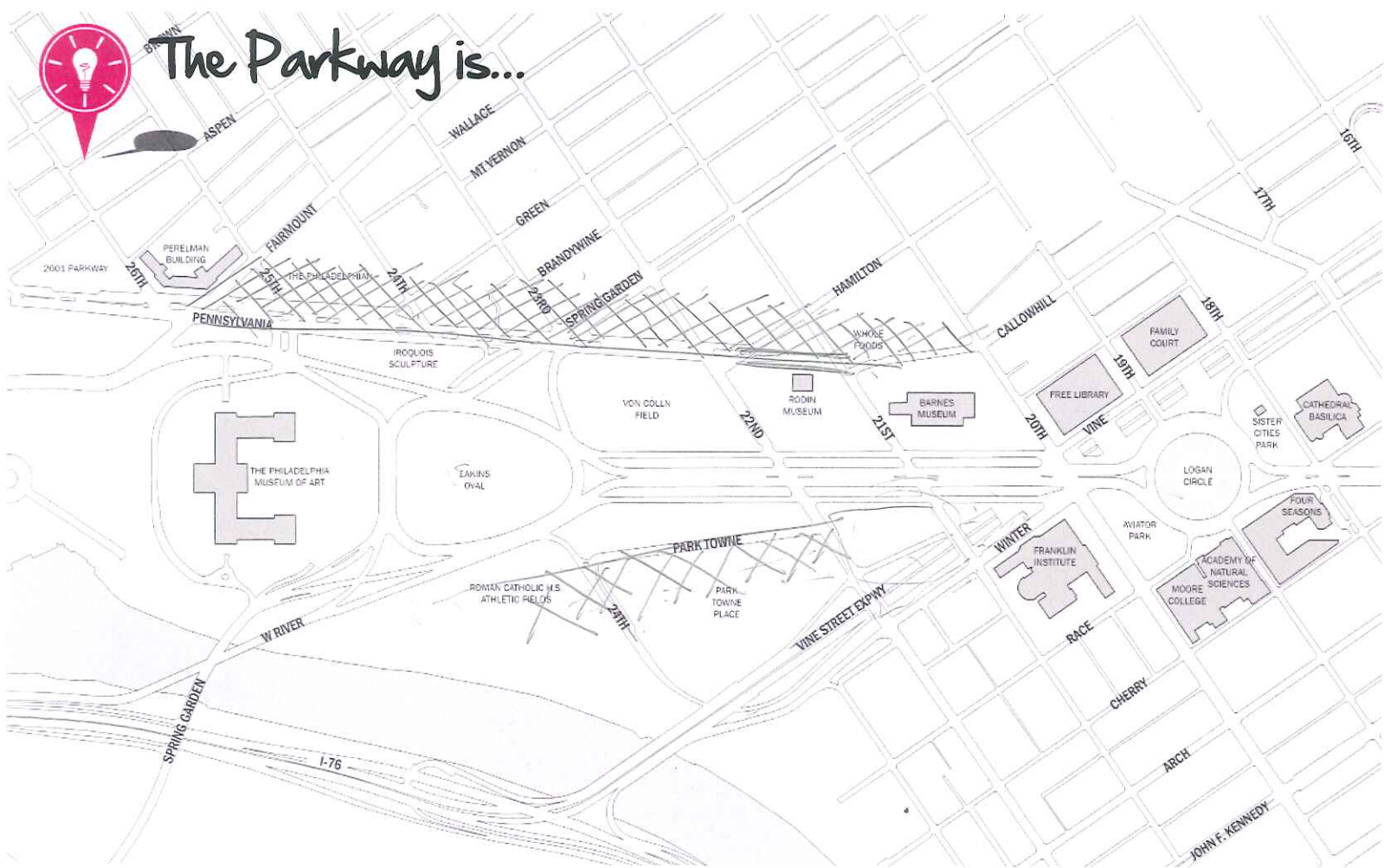



## The Parkway is...

CREATE STRONG RESIDENTIAL  
EDGES, WITH CONVERGING  
BLVDs IN FRONT OF THE  
APT BLDGS





The Parkway is...

THE PARKWAY PARKLET!

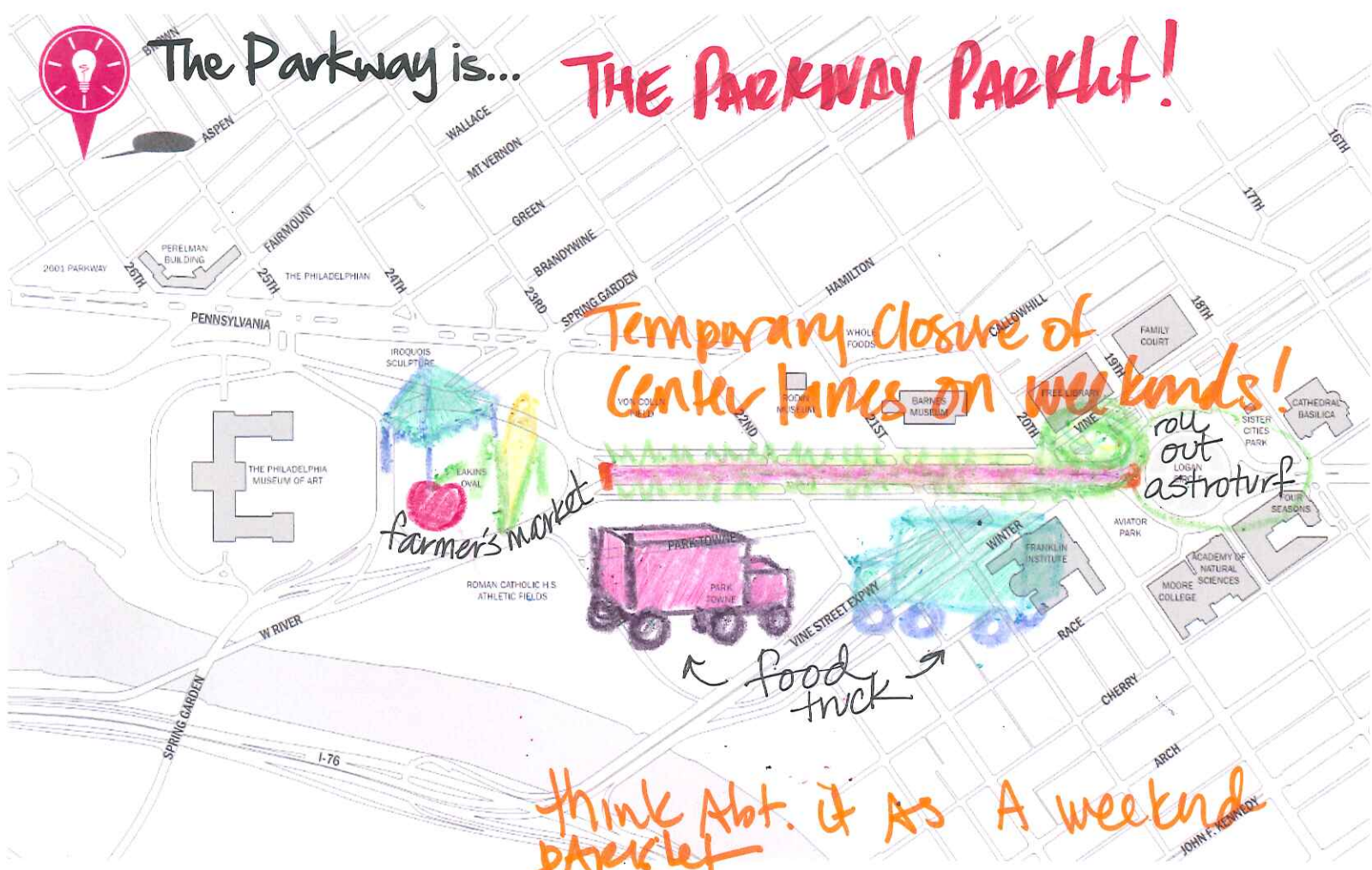

Temporary Closure of Center Lanes on weekends!

roll out astroturf

farmer's market

food truck

think Abt. it as A weekend parklet



## The Parkway is...

First of all, most of the people I discuss the Parkway with all agree that the first and most important problem to solve is the CARCENTRIC and PEDESTRIAN unfriendly way that things are now. My family and I live four blocks away from the Parkway and know how difficult it is to cross the Parkway with drivers in their cars turning faster than they should and many of them talking on cell phones, as they drive. Also, going through red lights, disregarding pedestrians, speed limits and signs. Some of the tourists look terrified, especially at the corner of 20<sup>th</sup> and the Parkway facing the Franklin Institute. THIS IS NOT A PEDESTRIAN USER-FRIENDLY PLACE, which is too bad given the cultural gems that we are fortunate to have here in our city and on our parkway.



## What's your bright idea for the Parkway?

- LOVE CIRCLE gets trashed on a regular basis and I've overheard tourist saying they wouldn't come back there again. Also, the ground blocks are cracking and should be repaired ASAP before someone is injured by a fall.



## What's your bright idea for the Parkway?

LOVE CIRCLE, SWAN FOUNTAIN, Green Area near Sister City and AVIATOR PARK are all in need of better supervision. I have had to call the police a number of times because of guys screaming at each other and threatening each other's lives, exaggerating I'm sure but nonetheless this has a negative effect on the community and tourists. I talked with one of the charming CCD officers keeping an eye on things at SISTER CITY PARK and asked him why they couldn't do the same for those places, he of course said they had not been assigned to those places; therefore he did not have any authority to let people know what they could and could not do.

The Police try to keep things in order but could use some help from the CCD or someone supervising and making sure people there are obeying the rules and behaving in a civilized way. These problems apply to all places mentioned above except for Sister City, which is run very well!



## The Parkway is...

THE PARKWAY IS AN ICONIC, CULTURALLY SYMBOLIC PLACE IN PHILADELPHIA AND SHOULD BE TREASURED AND TREATED AS SUCH.



# What's your bright idea for the Parkway?

---

---

---

All Parks, Play Areas and Activity Areas must be maintained and supported  
It should be designed in an integrated way, where children and adults can be  
nearby each other or in the same area engaged in activities that please all.

---

---

---

---

---



# What's your bright idea for the Parkway?

## CAFES and LIFE on the PARKWAY

- Couldn't we have the center be an island of green space like Las Ramblas in Barcelona?
- Cafes that serve food, coffee and alcoholic beverages
- Spaces designed with Gazebos, Umbrellas and various spots with shelter
- Spaces dedicated to social activities, entertainment and play
- Pink Pong games
- Outdoor Chess games with their own tables and chairs
- Bike Sharing
- Boules
- Sitting around a pond or fountain reading, meeting people and relaxing.

---

---

---

---

---

---

---

---

---

---



# What's your bright idea for the Parkway?

## CAFES and LIFE on the PARKWAY

- Dog Parks
- Movable chairs as well as benches that work with the style and Design of our Parks and Parkway
- Art Permanent and Temporary
- Outdoor exhibits and shows as well as adding another gallery perhaps.
- Venues for Outdoor Cinema and or Concerts which are shown once a week, weather permitting
- Puppet Show Venues and regular shows for children
- Sandboxes
- Playground equipment for children of different ages
- Places for playing small ballgames for both adults and children
- Greenhouses and community gardens
- WIFI
- Changing the parking near Eakins Oval into Park area, giving it continuity and more space for the activities mentioned above.

---

---

---

---

---

---

---

---

---

---

---

---

---

---

---

---

---

---

---

---