

# November 18, 2009: Race Street Pier Public Meeting

## Compiled Trends

### **SCHEME 1: THE LAWN**

*AN EARTHWORK HILL, RINGED WITH SEATING AND SHAPED TO SLOPE DOWN TO THE RIVER, FORMS THE CENTERPIECE TO A NEW SOCIAL PIER. A WOOD SEATING TERRACE FACES SOUTH.*

#### What excites you?

Many of the groups were thrilled with the concept of the decking and dock-like feel of this scheme. They liked that this scheme provided exposure to the river and enabled people to ‘touch’ the water. They felt that it would be “exciting” to be on the edge and that this edge could become a “destination.”

People responded positively to the wide variety of seating options (in the deck area, on the sunning lawn) and variety of ‘spaces’ created on the pier (the sunning lawn, the grove, the deck). It was felt that this would become a “great gathering place” throughout every season.

Multiple groups responded positively to the “openness” of the design – particularly at the end of the pier at the social seating area. People felt that the open spaces would be great for people watching, safety. The groups thought that this plan was very “welcoming” and “democratic.” The combination of the grove of trees at the front demarcated the entrance and also allowed for very natural open spaces on the interior of the pier.

#### What concerns you?

A major concern expressed by all groups is the lack of shade beyond the grove. People have concerns regarding the heat and indicated that they are looking for shelter from weather.

Four of the six groups indicated that the design was: a bit “boring”; “simplistic – does it draw people to the waterfront, won’t become a landmark”; “visually bland – could it be more dynamic?”; not as elegant as the other choices”; and “no ‘wow’ factor.”

A majority of the groups expressed various concerns regarding safety. Questions focused on the safety of the steps, the need for lighting throughout the site, the ability to monitor the pier, the density of the grove and how the grove may enclose the park at the entrance.

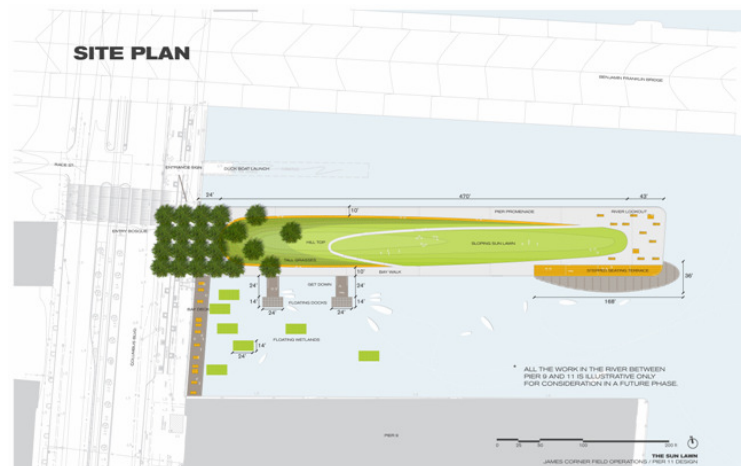

## SCHEME 2: THE DECK

A ROLLING WOOD DECK IS SHAPED TO DRAMATICALLY BRING THE VISITOR UP AND THEN DOWN TO THE SPACE OF THE RIVER. ENCLOSED IN THE SOUTHERN "COVE" IS A SOCIAL "BEACH" WITH UMBRELLAS.

### What excites you?

The majority of the groups responded positively to the beach element of the design. They liked the idea of a "beach in the city" and the variety in materials that the sand added to the site. It was felt that the beach provided an intimate space that was well paired with the deck and the more open areas. It was felt that the beach gave the scheme a great deal of "character / adventure" and that the design was "innovative, unique" and made the Race Street Pier a destination.

Every group responded positively to the change in elevation incorporated into this design. It was felt that the bi-level design offered a great connection to the water while also providing for a variety of experiences and clearly defining the space. The participants liked that the beach offered something more passive while the upper level was more social and active.

The participants had an overwhelmingly positive response to the inclusion of trees that extended the length of the pier. The placement of the trees in the center allow for park users to make a choice between the shady areas of the pier and the sunny areas of the pier. It was also felt that the shade helps to make it a destination.

### What concerns you?

While everyone responded positively to the beach, they also expressed many concerns. For example, it was felt that the sand might be too high maintenance; that the sand might blow away; that the sandy area would be subject to vandalism; that this design puts all its eggs into the novel basket of the beach and that the novelty might wear off quickly; that the sand would seep into the river and damage habitat, ecology, etc. Ultimately...they liked the idea of the beach but wondered if there were better locations for it in other areas of the riverfront or other areas of the city (or if we should just keep the beach at the Jersey Shore?!).

Four out of the six groups also discussed the size of the defined spaces. Some groups felt that the beach took up too much space and limited flexibility and spontaneity which was something that they liked about the other schemes. Others felt that the beach and the small green space were too small to be truly effective / utilized. Also, many participants felt that there was too much decking and too much hardscape.

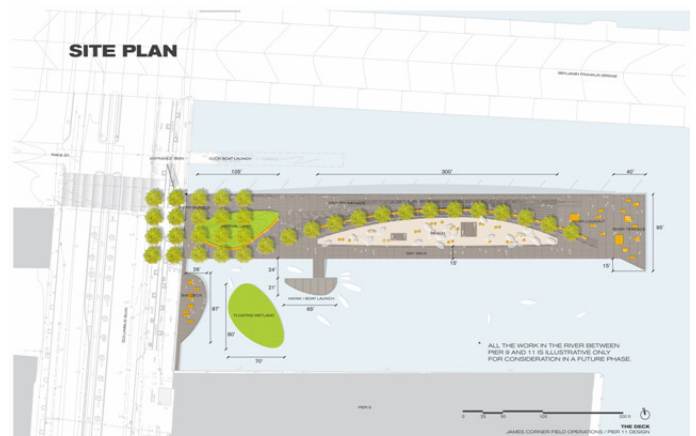

### SCHEME 3: THE SLICE

A DRAMATIC RAMP RISES ALONG THE NORTH FACE ALONGSIDE THE BRIDGE, DRAMATIZING THE SENSE OF ARRIVING IN THE SPACE OF THE RIVER. A LOWER TERRACE SUPPORTS A LAWN WITH GENEROUS SEATING AND SOCIAL SPACE.

#### What excites you?

Similar to responses in Scheme 2: The Deck, participants responded well to the elevation and bi-level design. They felt that the stairs provided a great seating option and that the elevation provided a good division of space as it allowed the pier to be both “urban” and “wild.” Also, every group responded positively to the fact that the elevated end of the pier would create new skyline views back to the city and up and down the river. Participants felt that this scheme provided strong connections between the city and the river. Overall, the groups felt that the elevation helped to make the pier feel bigger.

Many groups also indicated that they felt that this design was most “dramatic”, that it serves as a great “benchmark” design for future waterfront parks, that it represents “thinking outside of the box”, that the scheme is “flashy and energetic”, that it creates a “center square feel” on the waterfront, and that in its “angular design” it remains a very urban park.

The focus on lighting as a design element was well-received. People felt that the lighting might help with security and make the pier more useable through the day and into the night. In particular, the groups like that the lighting was discussed as being solar and they liked that the lighting might become a form of public art and that the lighting would help to reflect the water.

#### What concerns you?

This scheme had fewer trends regarding concerns – it seems as though each group had a much wider variety of comments and issues. Some groups questioned safety, some questioned maintenance (particularly regarding the lighting), and others felt that the lawns were too small to be usable.

But, the one common theme was concern regarding the narrow point on the elevated side of the pier. It was felt that the end of the pier might be too tight and that it creates an awkward, trapped corner that will become dead space. And, while everyone loved the idea of experiencing new city and river views they wondered if the action of heading out to the narrow point is a one-time thing and that the elevation is not enough to keep you there or make you come back. The groups each reiterated that it is important that the high point does not become an isolated section of the pier.

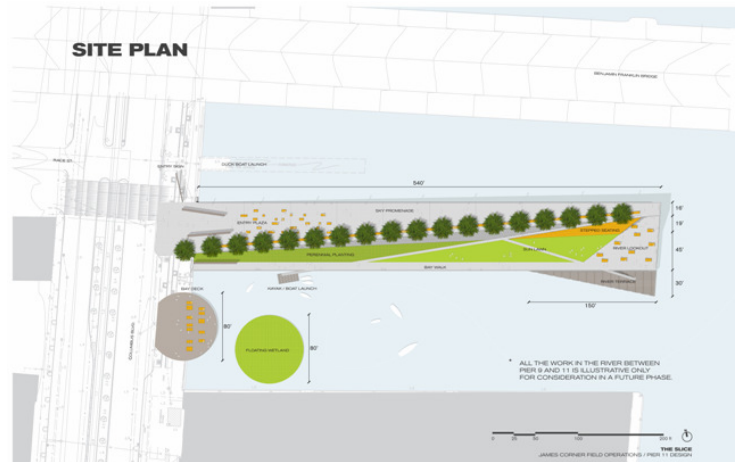

# **November 18, 2009: Race Street Pier Public Meeting**

## **Facilitated Comments – Six Small Groups**

### **SCHEME 1: THE LAWN**

\*indicates duplicate response within group

#### What excites you?

##### **Group #1**

- Big green space – much needed
- Expansive quality
- Multiple season use – versatile
- Can touch the water
- Like the slope – can it be higher?
- Simplicity of path design
- Contrast between grove and lawn
- Achievable, elegant, great start
- Nice buffer from street in the design of the grove; it offers an escape from the city
- Options for variety of uses
- Distribution of seating at the end – exciting to be at the edge

##### **Group #2**

- Most natural, lots of plants
- Lots of seating
- Open-ness
- Lower access
- Entrance – clearly demarcates pier

##### **Group #3**

- Docks
- Great gathering place
- Places to sit
- Openness / lack of clutter
- Open deck
- Seating

##### **Group #4**

- Strong buffer
- Easily maintained
- More natural
- My favorite
- Closer to river
- Steps allow for performance space on lower deck

##### **Group #5**

- Scale of greenspace is great
- Density of trees at entrance/Openness at end of pier
- Feels comfortable, not forced
- Likes topography

Best scheme to support trees and plants  
Trees block view of I-95  
Cantilever deck  
Balance of soft and hard scapes  
Best scheme for safety – the openness a big plus  
Likes promenade all the way around pier\*  
Best scheme for performances  
Likes social seating steps – people watching important

#### **Group #6**

The curves  
Lots of exposure to the river  
Focus on the end – the deck as a destination  
The views  
The sunning lawn /grass  
Most democratic  
Large space that is connected to all 4 sides  
Lots of different users / different purposes  
Slopes down / takes you directly to the river  
Not pretentious – it is welcoming  
No bottlenecking – completely accessible  
Wide open spaces are good for people watching

## **SCHEME 1: THE LAWN**

### *What concerns you?*

#### **Group #1**

Looming bridge and no trees to buffer  
Does the grove separate too much?  
Is the end of the pier too exposed?  
Lack of shade past grove  
Make sure the seating placement is conducive for interaction  
Overall safety and monitoring concerns for all schemes  
Could the mound move east to catch more sun – to the north side of the pier?  
Shade studies – consider sunny spots.  
Most simplistic of the three designs – does the scheme the power to draw people to the waterfront?

#### **Group #2**

Lack of shade – heat concerns – no shelter for weather  
Can you launch a kayak from it?  
Will there be somewhere to buy refreshments?  
Will green space be used differently in different seasons?  
Drainage issues – wind barrier needed?  
Safety – sense of security at entrance  
A little boring



### Group #3

- More protection from storms/trash
- No shade
- Maintenance issues
- Long grass / security
- Conflict with lawn use
- Is fishing allowed?
- Are animals allowed?
- Look into long term values / build out
- No focal point / nothing to draw you to the end
- No intimate spaces

### Group #4

- Trees would block view – possibly move to north end or thin out
- Consider more shading further in
- Trees may be used as guiding tool
- Concern about river cleanliness
- Not enough access to river for boating, etc.
- Maintenance of lawn – dog access?
- Visually bland – could be more dynamic
- Too open – needs more intimate spaces
- Too much lawn – not useful year round
- Consider native plants – could bring wildlife for interest
- Safety of steps

### Group #5

- Not enough shade
- Transition/seam between lawn and decking
- How will lighting be addressed – good place for night use – needs lighting
- Not a good opportunity for kiosks at end of pier

### Group #6

- No 'wow' factor
- No wind break
- Less connectivity to the city
- Should spread shade and foliage out
- Would like it to be more wild (like it is now); the scheme is too manicured
- Not enough of a destination – it would not draw tourists
- Not as elegant as the other choices
- Not as much potential to be a landmark
- Concerns about irrigation for lawn care

## SCHEME 2: THE DECK

### What excites you?

#### Group #1

- North + South side integrated better in this scheme
- Like the seating options
- Very distinct
- Row of trees
- Well defined space
- Easier maintenance
- Conducive for farmers market
- Slope down opens up to both sides of pier
- Best connection to the water – different experiences

#### Group #2

- Sheltered cover, all seasons useful\*
- The beach in the city\*
- Variety of material and shade
- Variety of both passive and active recreation
- Kid-friendly
- Trees down the center
- Elevation change

#### Group #3

- Beach, sand
- Walking around the pier
- Shade – with umbrellas on the beach and with seating
- Boat launch
- Maintenance of pier
- Trees to river
- Lawn of first trees
- More natural feel for trees
- Trees part of walk

#### Group #4

- Most character/adventure
- Shade opportunities\*
- Protection from rain
- Good beach
- Seating at end
- Naturalized island
- Like bi-level idea
- Grove feels like a park
- Grove blocks a not great view of city

#### Group #5

- Like the sand as a material
- Trees and umbrellas – shade – make it a more of a destination
- Allows choice between sun and shade

Likes the intimacy of beach alcove and bay area; not as exposed to elements  
More accessible than others – no steps and steep levels

#### **Group #6**

Innovative, unique = destination  
Change in surface/ times of year – helps to make it a destination all year  
Deck (materials) – speaks to the pier  
More foliage throughout the year  
Likes trees coming up through the deck  
Use of water as exploration space  
Extra elements: wetland, etc.  
Invites a multitude of uses  
Compromise between other places in terms of the levels  
River terrace provides more space for socializing

## **SCHEME 2: THE DECK**

### *What concerns you?*

#### **Group #1**

Limited potential for recreation  
Not enough green  
High point focuses on north face of Pier 9 which is not that attractive  
Could be more subject to vandalism  
Hand rail blocks off access to river  
Lack of diversity of plantings  
Not enough for children  
Trash in the sand; replace beach area with grass  
Consider development options for Pier 9, if developed or not  
Can you incorporate tall grasses?  
Consider restroom access for all schemes in close proximity to site

#### **Group #2**

Is there space for beach volleyball – active recreation  
Barren – needs more trees  
Want more trees  
Sand might blow away? Too high maintenance?  
Beach is too small? Territorial space issues on beach? Could there be some greenspace?  
Skateboarders  
Too much wood  
View on pier 9 side is less enticing  
Could be other locations for beach than on pier  
Miss the terrace design

#### **Group #3**

Not enough lawn  
Sand may become an issue  
Noise of train



Does not allow flexibility / too programmed  
Dog issues  
Beach would be good in summer but could be an issue in other seasons  
Beach bathers  
No space for loose interaction / not great gathering spaces  
No draw to the end of the pier / accent point  
Grass may be better than sand

#### Group #4

No water access, so is a fake beach  
Artificial surface  
Too much decking  
Maintenance of sand and umbrellas  
Umbrellas create isolation  
Litter box for cats?  
Trees block river view – shade should be further out  
Thin out trees for view?  
Don't like idea of beach at river\*  
No access to water for boats, fishing, paddling  
What kind of wood? Is it sustainable?  
Lawn is under more pressure of use

#### Group #5

Too remote from center city for a beach unlike Paris' beach in heart of city  
Materials in beach escaping into river seem like they could hurt/impact ecology/habitat  
What is appropriate attire for urban beach?  
Design puts all eggs in one basket – what if beach doesn't really work?  
Fixed site furnishings – non moveable  
Do we need beach when Jersey shore is so close?  
Over programmed/less opportunity for spontaneity  
Seems like lots of small elements not tied together

#### Group #6

Limited pet access  
Maintenance of sand – has the potential to be underused during different seasons  
Too much of a novelty\* / trendy / gimmicky – not enough of a public space  
Not enough green space / Too much hardscape  
Would beach space be used appropriately? Does not integrate the waterfront as well as Scheme 1 (in terms of the slope down to the water)  
Beach is too small and misplaced  
Elevated portion not high enough or split in the right place  
Too narrow, too restrictive – plus, the pier is already narrow  
Turns its back to the bridge side  
Too many different possible uses of beach – could collect trash in sand and trash would build up quickly  
Brings too much focus to beach and not enough focus on the river  
Safety issues re: glass  
Drainage concerns  
Terrible in winter

## SCHEME 3: THE SLICE

### What excites you?

#### Group #1

- Elevation on the end
- Views of the city
- Great mix of different elements
- Stairs are great -- like how it functions as seating , nice configuration
- Deck extension – good view
- Surface lighting is great – consider in other schemes
- Layers and heights – division of space
- Artwork at entry point
- Combines best elements of Scheme 1 and 2
- Row of trees = a good buffer
- Feels bigger
- Brings people down to the water
- Solar lights
- Flashy, attention getter, energetic
- Most attractive of the three
- Honors the historic use
- Trees take people out all the way to the end – fall will be spectacular
- Also, attractive from other side
- Experience from the bridge would be great – relates to the bridge well
- Best placement of grasses and trees
- Tree placement provides shade and buffers the bridge
- Would like a waterfall

#### Group #2

- Drama\*
- Nighttime interest\*
- Elevation – variety of experiences
- More inviting entry
- Combination of materials
- Solar lighting
- Steps on lawn
- Works best with shape of pier
- Hight elevation at end
- Year-round appeal
- Covered and sheltered from wind

#### Group #3

- Lights
- Cement
- Improved safety
- Stepped seating and abundant seating with a lot of options
- Lawn
- Many uses / alternatives

Good benchmark – iconic  
Height and views  
No cluster of trees in front  
Flower plantings  
Lawn has a ‘center square’ feel  
Thinking outside of the box – people loved this design

**Group #4**

Bi-level; two spaces at end of pier  
Height creates view of city and river  
The slope up  
My favorite  
Variety of materials and conditions/experiences  
Clear view to river  
Nice modulation  
Open, inviting entrance  
Angle of lower deck angled to view across river  
Like solar powered lights  
Pavement lighting element  
Light important to reflect water  
Like relationship to bridge

**Group #5**

Strongest scheme for a vista  
Panoramic view  
Likes topography and variety of spaces  
Likes stairs for gathering, people-watching  
Flow from side to side  
Likes openness of entry but it needs a “hook”

**Group #6**

Multi-use but also keeps the green space  
Dramatic: experience whole width of pier  
Trees on perimeter, not in middle  
Lighting ideas  
Ties well with the city / brings city out to park – the connection is strong  
Opportunity for different types of planting spaces and use spaces  
Good skyline views  
More of a destination  
Connecting 2<sup>nd</sup> Street to the river (with lighting)  
Lighting attracts nighttime use  
Multi-levels / combination of urban and wildness  
More interesting / places to explore  
Angular! Very Urban  
Wheelchair-inviting / dynamic / accessible

## SCHEME 3: THE SLICE

### What concerns you?

#### Group #1

- Disconnect on north side – further out on pier, too high
- Highest point is too skinny blocks views northward – too narrow
- Places for bikes to be locked (in all three schemes)
- Skinny, triangular lawns are not that useful
- Entry point is too open, does not buffer the road
- Can a grove of trees be included?
- Avoid sunken areas

#### Group #2

- Lack of shade\*
- No grove entry
- How big is lawn? Can there be more greenspace?\*
- Comfort of seating, especially wooden

#### Group #3

- Needs some access to the water
- Could the upper left become dead space? Perhaps it would need some sort of programming in this area.
- Green space in the entire plaza
- Concern about tightness / high area
- People jumping off the high area
- Unbalanced
- What does the height look like from Delaware Avenue? Looking at it from the street (looking east) and looking at it as if you were travelling south down Delaware Ave.
- Need a better transition between the high and low points – don't isolate the high point
- Safety

#### Group #4

- Safety\* - ex. stairs as hiding places
- Vegetation buffer on north side
- Too much concrete\*\*
- Too “mosaic-y”
- Trees block areas – move north to avoid isolation
- Trees may block view to river?
- Add possible water feature?
- Too harsh – too much “city”
- Practical concern about solar lights – are they reliable?

#### Group #5

- View back to city not so important; the height you get is a one-time thing and doesn't have as much social value; won't keep you there
- Too tight at the end/balance of space usage is odd
- Canopy will block views
- Might feel “trapped” once you reach end of pier
- Make it very bright

Lawn is too small  
Some awkward corners  
Not enough green on north side

**Group #6**

Potential for shady nighttime activities (lighting makes it inviting)  
Safety  
Big commitment to light / nighttime use. But will still close it?  
Maintenance of lighting  
Trash thrown into river  
Competition to be on top part could cause clogging!  
Need indication of how windy it would be / wind needs to be considered  
Feels too linear / mall-like  
Needs groves of trees  
Needs more interesting / multi-level planting plan  
Lit pathways are a waste in the daylight...too much hardscape / needs green  
Embankment wall needs green  
Worried about stormwater runoff from upper level to lower level

**NOVEMBER 18, 2009  
RACE STREET PIER PUBLIC INPUT SURVEY**

**1. Please rate the following design elements on a scale of 1 (strongly dislike) to 5 (strongly like):**

DESIGN ELEMENTS	RATING				
	dislike				like
1 Grove of trees as a City to River threshold (LAWN and DECK)	1	2	3	4	5
2 Large, open, multi-purpose lawn (LAWN and SLICE)	1	2	3	4	5
3 Urban beach (DECK)	1	2	3	4	5
4 Pier perimeter walk (ALL SCHEMES)	1	2	3	4	5
5 Wood decking as primary paving material (DECK)	1	2	3	4	5
6 Solar light surface as primary paving material (SLICE)	1	2	3	4	5
7 Perennial and Grass Plantings (LAWN and SLICE)	1	2	3	4	5
8 Seating Steps and River Terrace at the end of the pier (LAWN and SLICE)	1	2	3	4	5
9 Seating Opportunities along the pier and Social Seating arrangements at the end of the pier (ALL SCHEMES)	1	2	3	4	5
10 A Two-Level Pier; a Lower Level that relates to the River and an Upper Level that relates to the Bridge (DECK and SLICE)	1	2	3	4	5
11 Sky Promenade (Sloped Ramp) to dramatize the procession out to the end of the pier (SLICE)	1	2	3	4	5
12 Raised elevation at the end of the pier to offer views back to the City skyline (SLICE)	1	2	3	4	5
13 Other (please specify)					

**2. What do you most want to do at the Race Street Pier?**

**3. Please rate the Versatility / Park Use for each scheme on a scale of 1 (strongly dislike) to 5 (strongly like):**

PIER SCHEMES	RATING				
	dislike				like
1 Versatility / Park Use of Scheme 1 - THE LAWN	1	2	3	4	5
2 Versatility / Park Use of Scheme 2 - THE DECK	1	2	3	4	5
3 Versatility / Park Use of Scheme 3 - THE SLICE	1	2	3	4	5



Question 1: 91 Surveys Completed							
Please rate the following design elements on a scale of 1 (dislike) to 5 (like)		Strongly Dislike				Strongly Like	
Design Elements		1	2	3	4	5	Weighted Point Total
1	Grove of trees as a City to River threshold (Lawn and Deck)	7	16	18	22	21	272
2	Large, open, multi-purpose lawn (Lawn and Slice)	1	3	12	28	43	369
3	Urban beach (Deck)	32	31	15	5	5	155
4	Pier perimeter walk (All Schemes)	0	0	1	22	65	418
5	Wood decking as primary paving material (Deck)	4	10	31	21	20	293
6	Solar light surface as primary paving material (Slice)	4	10	10	17	48	354
7	Perennial and grass plantings (Lawn and Slice)	1	1	4	32	50	394
8	Seating steps and River Terrace at the end of the pier (Lawn and Slice)	0	2	6	22	58	400
9	Seating arrangements at the end of the pier (All Schemes)	0	0	8	17	52	354
10	A Two-Level Pier, a Lower Level that relates to the River and an Upper Level that relates to the Bridge	3	11	12	24	38	338
11	Sky Promenade (Sloped Ramp) to dramatize the procession out to the end of the pier (Slice)	4	7	12	18	46	351
12	Raised elevation at the end of the pier to offer views back to the City skyline (Slice)	4	8	7	21	49	364

13 **Other (please specify)**

- No skinny triangle lawn areas w/ dead spaces in the corners
- Keep in mind our piers will be underwater soon
- Whatever is environmentally safe and would enable city dwellers to connect with nature, open space and water
- I don't like the park name, why not call it the BF bridge part?
- Concern about light - dark sky vs. city lights
- Race Street needs noise mitigation on 95 to be successful in attracting people (2nd to front)
- Walk away from second + race to the pier. How will that work + will it coordinate w/ the design scheme
- Ability to get down to the river (1+3 schemes)
- Stormwater, water quality, flooding, celebrate water
- Space to allow fishing, boat tie-up, red signal at Spring Garden and Delaware Ave for pedestrians
- Like the trees along center of #2, but don't like the beach concept
- Don't build w/o river access
- Night + day, art installation via lighting in the entire pier. Pier as installation to light waterfront
- Bike racks, parking, public transportation, shade during summer?
- Dog access + access to water
- More shade/ sculpture elements for more gardens/endpoints
- Like option for boating

---

Access to water + wetlands

---

Tie this to the city

---

Attractive lighting- security/adding a water element (water sculpture/spray)

---

Water features - keep the wonderful building across Del Ave- incorporate it into design

---

The floating vegetation is a good idea/ views of city

---

Give Philly something unique, that visitors would want to see

---

City should buy old firehouse and use it for bike rental kiosk and bathrooms, police for river trail

---

Water feature

---

More shade area - the ability to transform space for different events

---

Shade

---

Provisions for bikes/security/safety concerns? Commercial space? Fishing/ lighting?

---

## Design Element Rankings

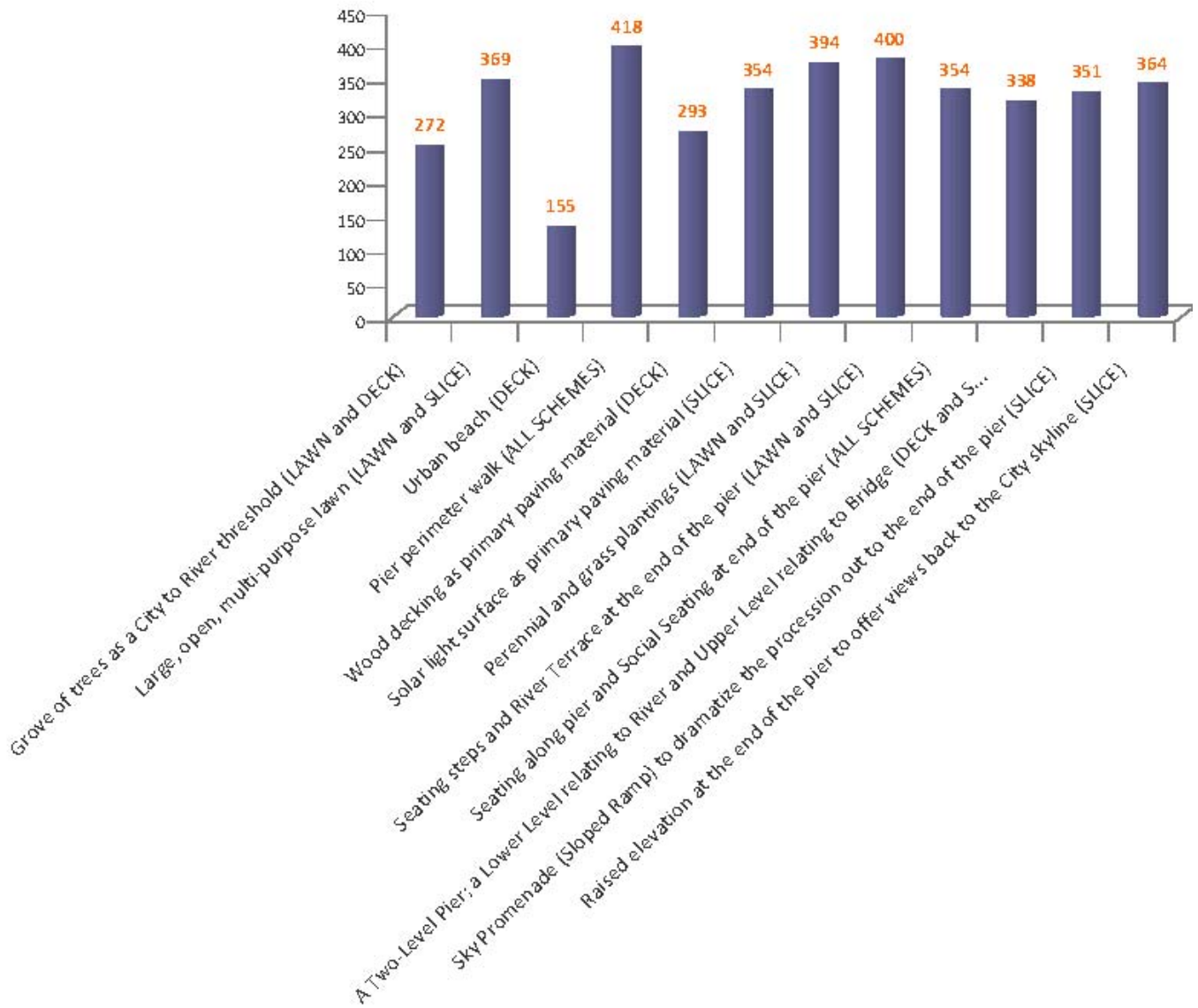

## Question 2

### What do you most want to do at the Race Street Pier?

Views, feel/sense water and sun

Experience the river & enjoy the river views

Be nearer the river. Launch small human power craft

View of Philly, seating, great walkability, trees plants

Be near the water

Would like to enjoy all piers close to RSP + be able to walk to the others +enjoy the river

Passive recreation, sitting & resting by the river - maybe local artists and/or vendors on weekends

Lounge and watch the river

Picnic

Multi-levels to provide additional view experiences

Sit on the grass & read, picnic w/ friends

Walk, relax, enjoy the view, sit & read

Enjoy the river w/o too much concrete, w/o, dog crap, w/o skateboarders or cyclists. Enjoy the quiet and piece of the water. No trash

Enjoy open space

Relax & enjoy water view, walk dogs

Leisure, walking ,enjoying the water, walking dogs

Relax, read, talk

Sit on a bench & read

Vista (view)

Relax

Kayak, clean storm water outfalls, celebrate water

Hangout, maybe attend a special event, grab quick bite to eat from a food cart or two

Engage in a dynamic public space that changes dramatically +across the season and begins the connection of the public to the water

Public marina for small boats or launching area

Relax, be outside, sit on grass and under trees, and view skyline- no concessions

Paddle up on a kayak

kayak, store a kayak

I want most of all to be able to walk my dog there, to be comfortable and safe

See the river/relax

Use the water + recreation

Hang out with friends, destination when walking from CC. connection to river like boating & fishing

Dog walk+ wildlife viewing, rock wall, plenty of shade

Hangout, check out the view

Sit in sun and read

Relax, people watch, look at river

Take walks, have picnics with friends, watch performances

Walk/see the water

Nice walk/possibly small performances

Observe surroundings

View river

Use it as a comfortable place for social leisure outdoors

Walk at lunch time. Relax &enjoy view. Possibly visit at night/weekends

Social activities

Interact with the water/city/people

Festival events

## Question 2

### What do you most want to do at the Race Street Pier?

Have a contemplative place to experience the Delaware

Sit & hang out, eat a hot dog, drink a coffee

Lounge and relax both in lawn setting and on terrace

Passive recreation, relaxation- reading, sunning

Water access

Relax on grass

Shade

Relax

Walk, sit, look at the river

Become a distinctive feature of Philadelphia like highline

Have the design, materials and feet relate to the history & city

Escape from city

Read & relax, maybe sit down for a bit to eat

Sit on grass and read

Recreation site

Sit on grass/ escape from urbaneness

Looks like "sitting" is about it

### Question 3

Please rate the versatility/park use for each scheme on a scale of 1 (dislike) to 5 (like)

Pier Schemes	Strongly Dislike			Strongly Like		
	1	2	3	4	5	Weighted Point Total
<b>Scheme 1 - The Lawn</b>	4	8	17	39	20	<b>321</b>
<b>Scheme 2 - The Deck</b>	19	26	30	9	4	<b>193</b>
<b>Scheme 3 - The Slice</b>	2	6	11	20	49	<b>368</b>

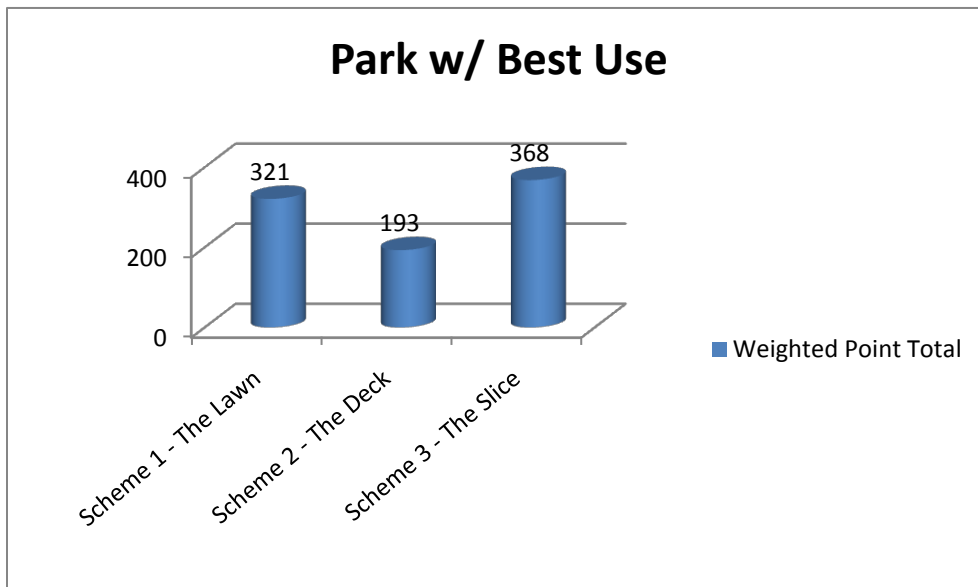



## GENERAL ADVICE TO DESIGNERS:

### Group #1

- Incorporate solar lighting in all three
- Keep focus on getting people here – connectivity!!
- Stick to the design elements
- Focus on getting a Friends of Race Street Pier group together
- Incorporate a kids area
- Think about boat access – connection to the water
- Think about all four seasons

### Group #2

- Shade and seating concerns without backs
- Can you use it all seasons or at night?
- Night lighting is great!
- Entryway is important – inviting night and day
- Real access to water
- Designs seem most successful when users design
- Connect to city
- Incentives for people to stay at end of pier
- Noise level of bridge might be a concern
- Some designated space for flyers so it's not a free for all
- Danger with design 3 for kids
- Winter draw – fireworks, alternative market space, events
- Can you host small events?
- Seasonal transformations
- Trash and recycling cans are needed
- BBQ pits?
- Concert space/stage needed
- Educational events

### Group #3

- Elements for small kids
- Sculpture – interesting elements (i.e. Battery Park)
- Getting to dock, parking for boats may present an issue
- Flip seating (top left) to lower left (near boat dock)
- Entrance to pier is important
- Ensure that there is something for everyone
- Rock wall for kids between the high point and the lower seating area – integrate it into the slope.

### Group #4

- Self sustaining
- Connecting to river through water access
- Romantic lighting
- Least maintenance
- Safety, dude!
- Dear Field Operations,

Please create a pier park that connects us to the river in a self-sustaining, safe, and romantic way.

**Group #5**

More green space is better

How can you try to make this a “signature” park for Philly (like HighLine in NYC or Millennium in Chicago) – but keep it Philly

Keep it an “escape” from the city – an oasis

Relate to the bridge, too

**Group #6**

Take wind into account

Incorporate sustainability features: wind power, solar, etc.

Potential of misuse

Maintenance

Accessibility – especially from the city to the pier.

- Traffic studies
- Outreach in close neighborhoods / community...how would they use it?
- Fit it into the master plan

Green needs to be organic, not as linear

Materials should speak to pier (grittier), more timber

Seek to balance tourism with sustainability

Incorporate access to water from pier (kayaking)

Consider year-round uses

Keep ears and eyes open; trust your judgment and experience

# **November 18, 2009: Race Street Pier Public Meeting**

## **Graffiti Wall**

### **Question Prompts:**

#### **What is more important, views or green space?**

Views = 6

Green space = 5

Equal = 2

#### **What do you love about being on the water?**

Floating

Never been but want to get closer

Makes me feel like I am on vacation

I love paddling on a river

#### **Why do you live here?**

I love Philly!

Mother grew up at 2 woods "the old neighborhood"

Cause I love the changing city

Philly is so cool!

Because there is nothing like Philly where I come from

Because I can live a full life without ever having to own a car

Always have, always will

For the benefit of being able to access everything I need within walking distance, without the price tag of other big cities

#### **What is your favorite memory of the Delaware River?**

Doing the mudwalk out to a boat

Fireworks

Flaming Lips concert at Festival Pier – very lively

Fireworks in 1999 into 2000

Bike riding over Ben Franklin Bridge

Painting the bridge blue

Walked from Schuylkill to Delaware on 1<sup>st</sup> visit – now I live here (it was a little bit cleaner)

Don't know, haven't seen much of it yet

Fishtown Neighbors Shad Festival

#### **What is your favorite part of the city? Why?**

Mount Airy

Mantua: the friendliest folk in Philly

Center City

Wissahickon Valley

Italian Market – great street life

UPenn! I love UPenn and urban street life

**Share your thoughts**

Make it memorable!

No casinos!

All this for only \$55 a square foot!

Think small boats, canoes, kayaks, sailing

Remember, the waters will rise

Work on connections to Center City

Tie-ups for small fish boats

Spots on pier for fishing

There are enough piers for every conceivable type of recreation, car free!