

Philadelphia's Central Delaware Riverfront Vision Plan

civic engagement

- 3,200 people attended events: riverfront walks, value sessions, principles sessions, best practices, charrette presentation
- project website with more than 2,200 people subscribed
- over 90 news articles
- multiple briefings with developers

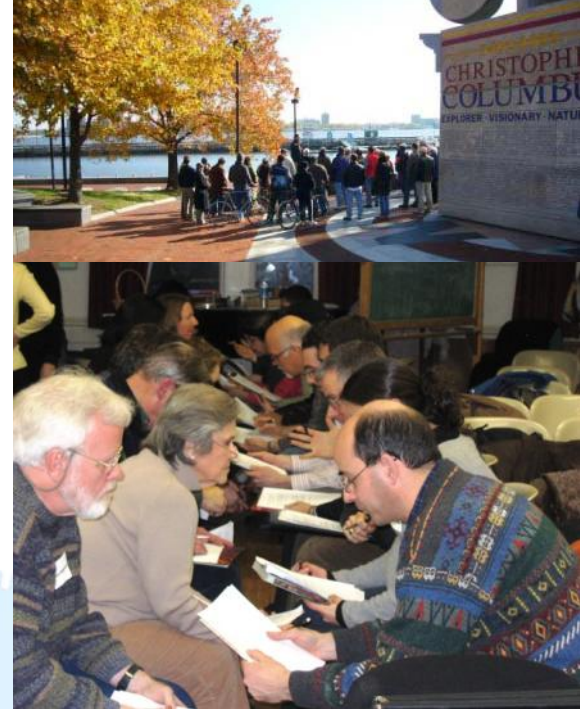

RETHINKING THE RIVER, WITH YOUR HELP

WALKER, WALKER, everywhere, not any dog to drink... (text continues)

THREE WALKS ON THE WILD SIDE

1. Saturday, Oct. 26, 10 a.m. to 1 p.m. Walk from Penn's Landing to Penn Treaty Park with... (text continues)

2. Saturday, Nov. 4, 10 a.m. to 1 p.m. Walk from Penn's Landing to... (text continues)

3. Saturday, Nov. 11, 10 a.m. to 1 p.m. Walk from Penn's Landing to... (text continues)

KEY:

- Walk 1 (Green)
- Walk 2 (Yellow)
- Walk 3 (Orange)

WITH YOUR HELP, create priority... (text continues)

civic principles

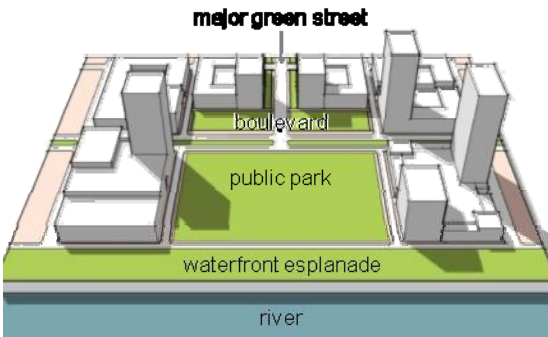

- Reconnect the city to the river's edge
- Honor the river
- Design with nature
- Strike the right balance
- Take the long view
- Protect the public good
- Make it real, Philadelphia

circulation framework



open space framework



development framework

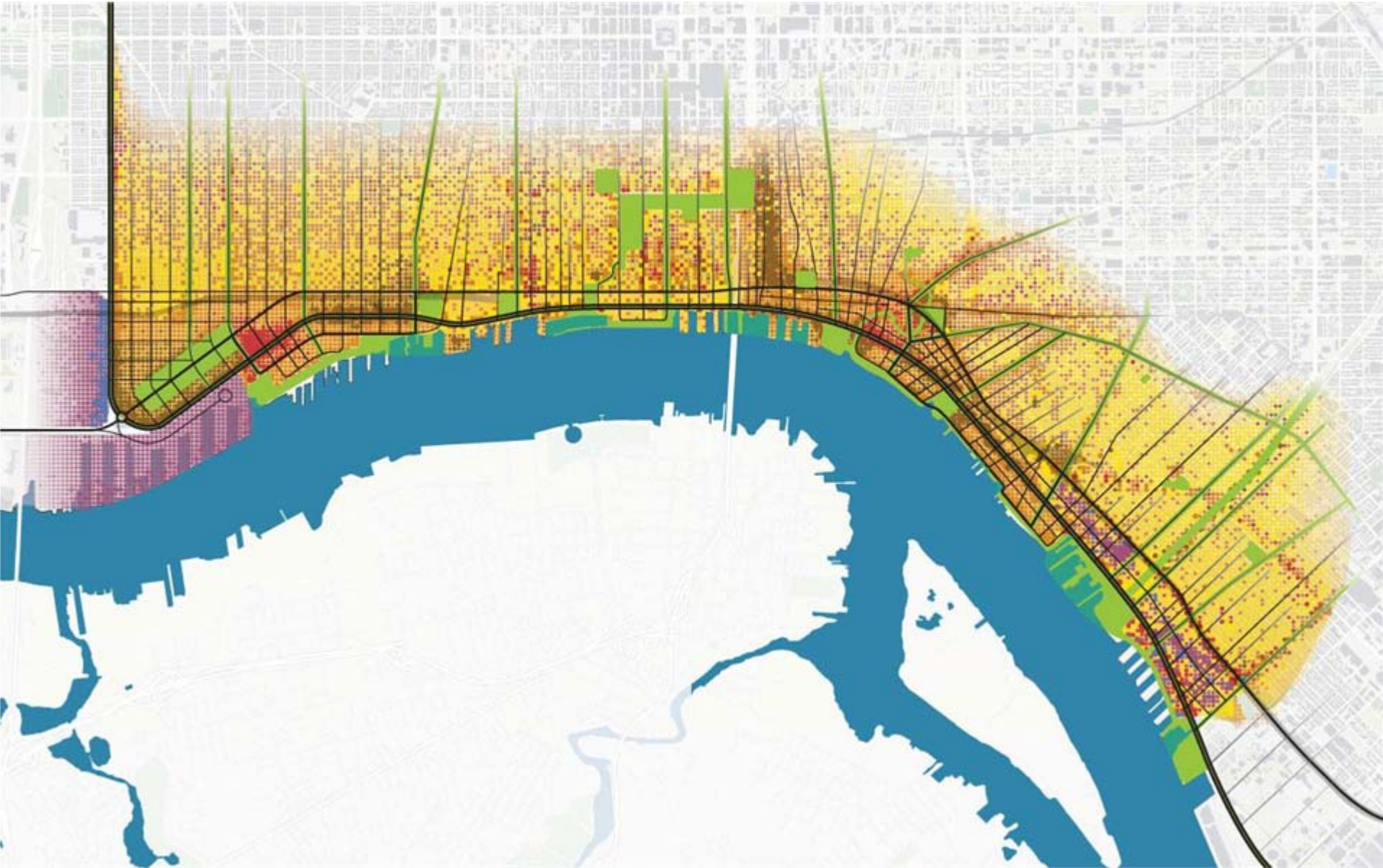

guidelines for development

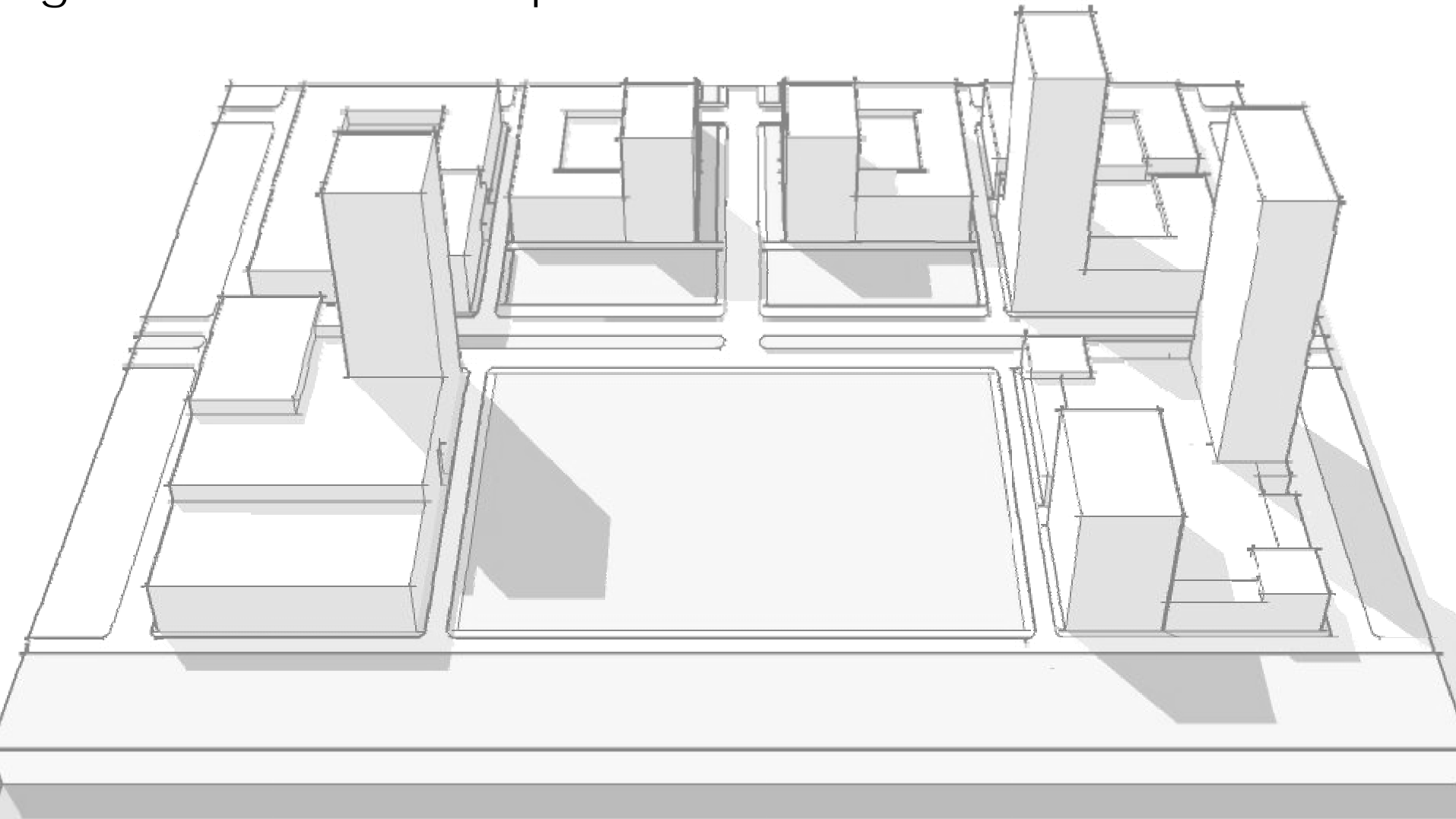

street grid

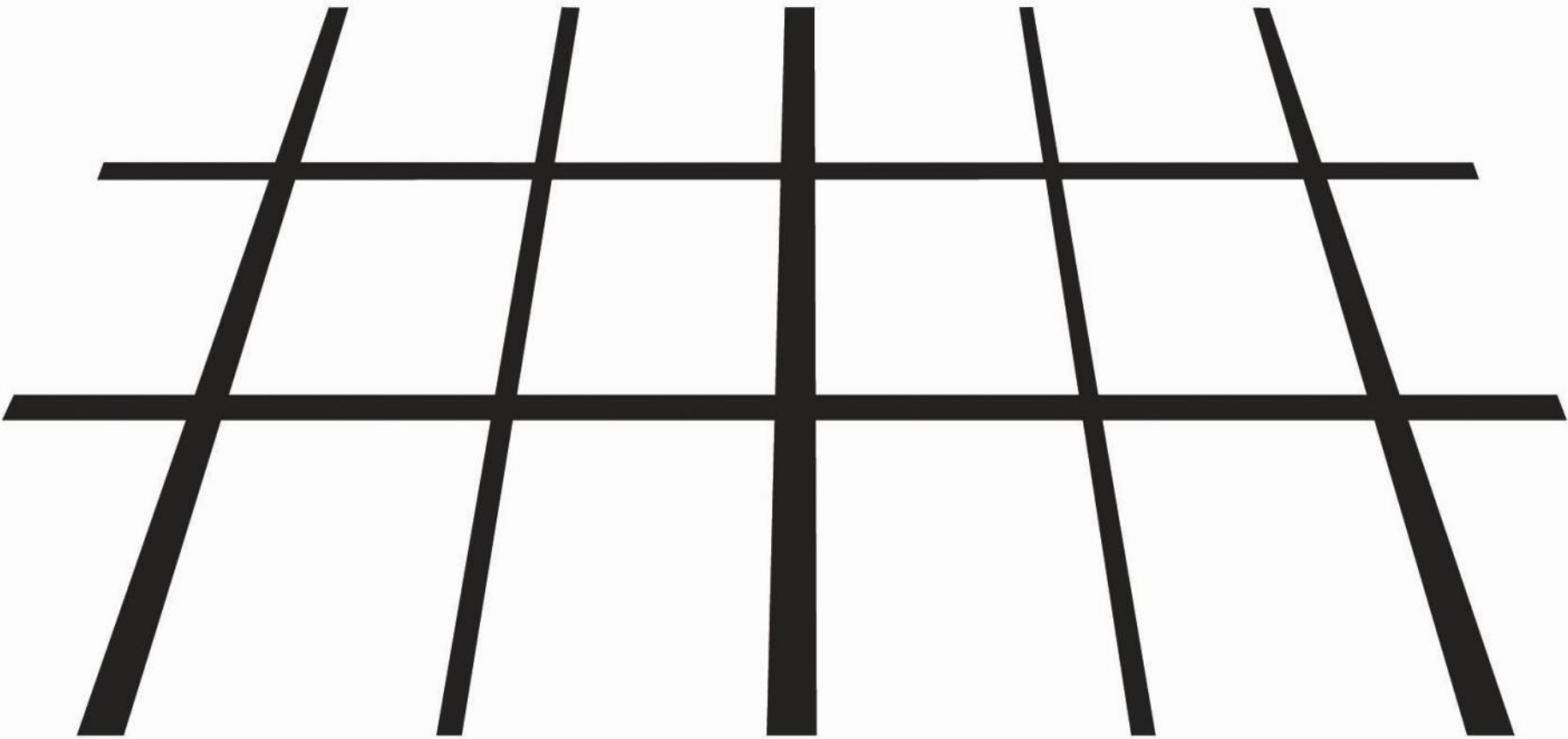

boulevard / mass transit

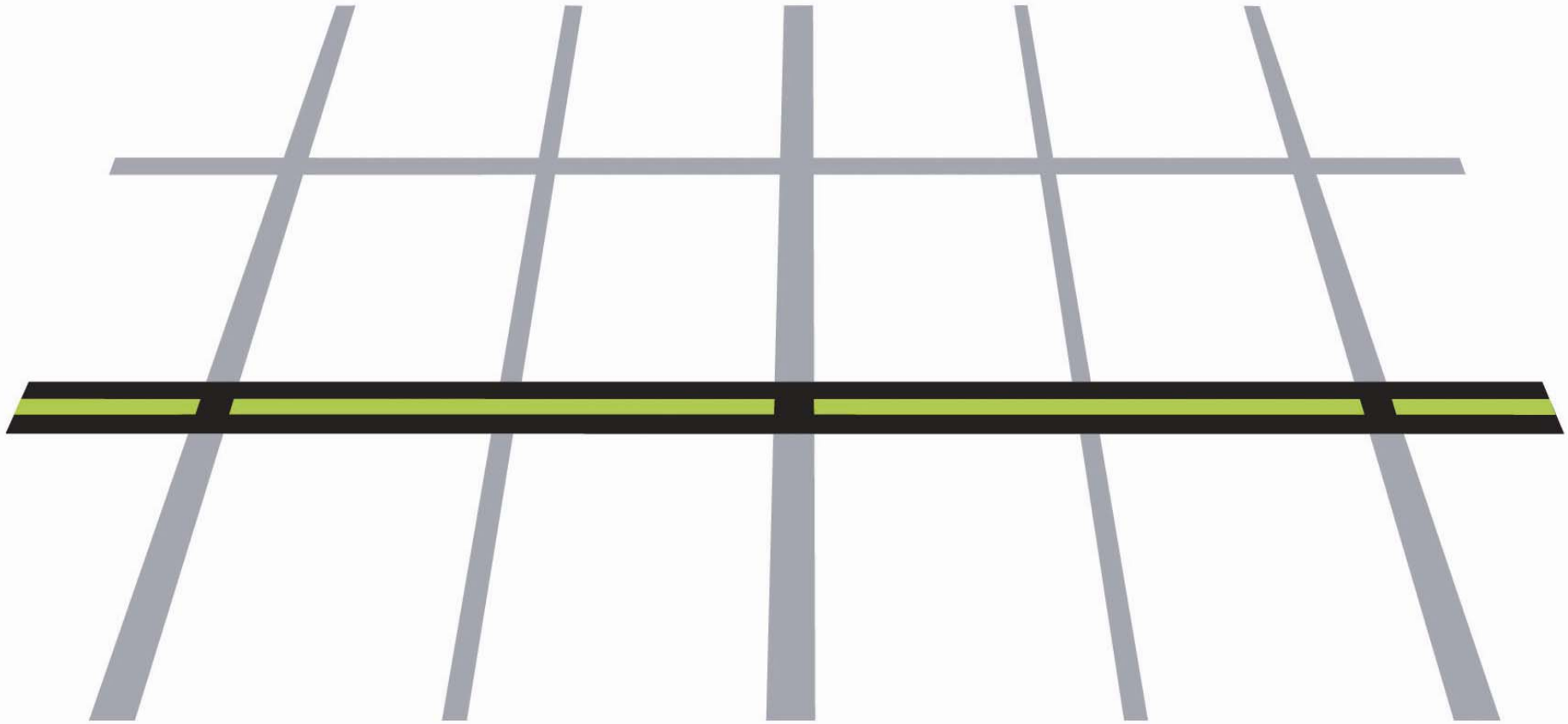

parcel size

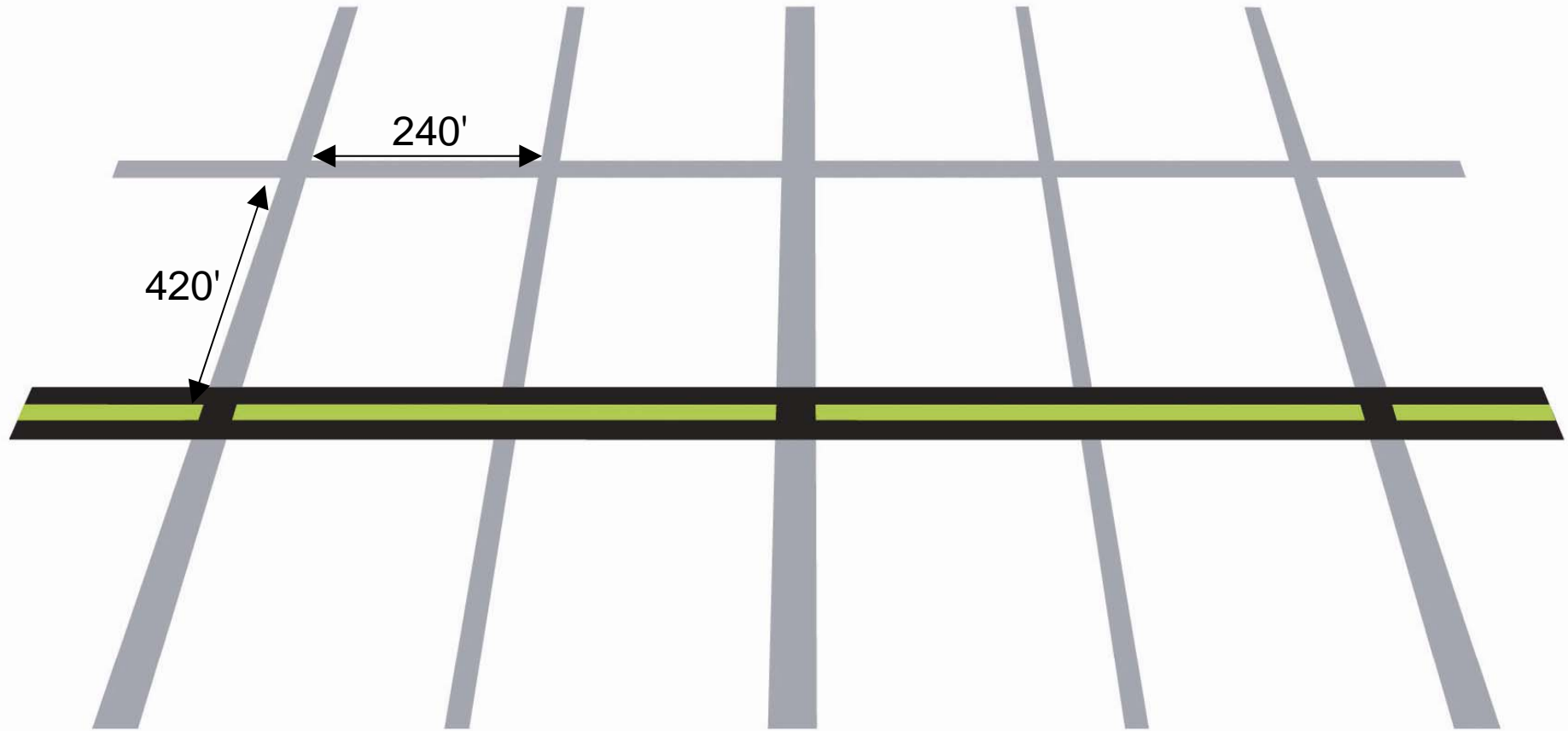

public waterfront access

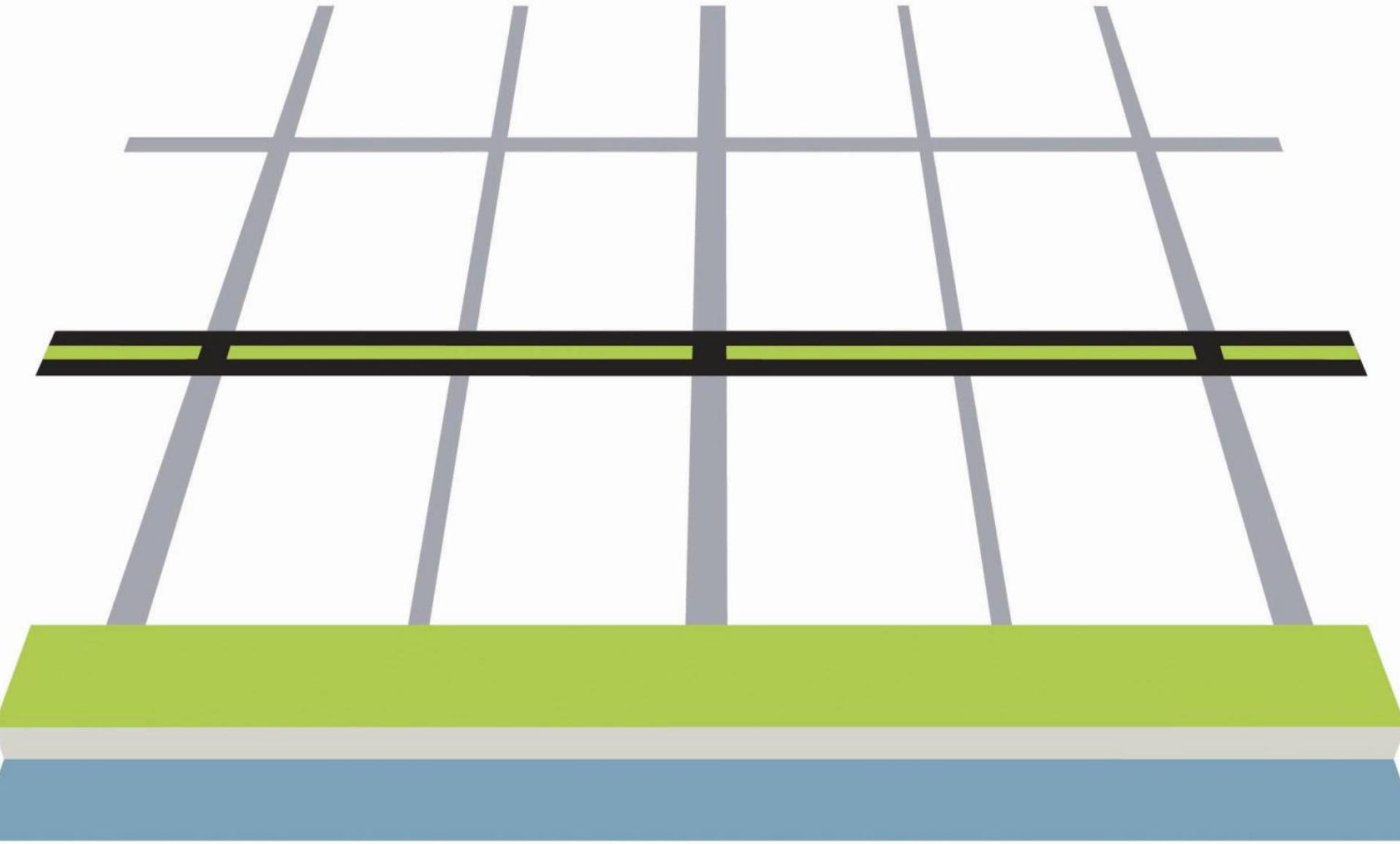

open space

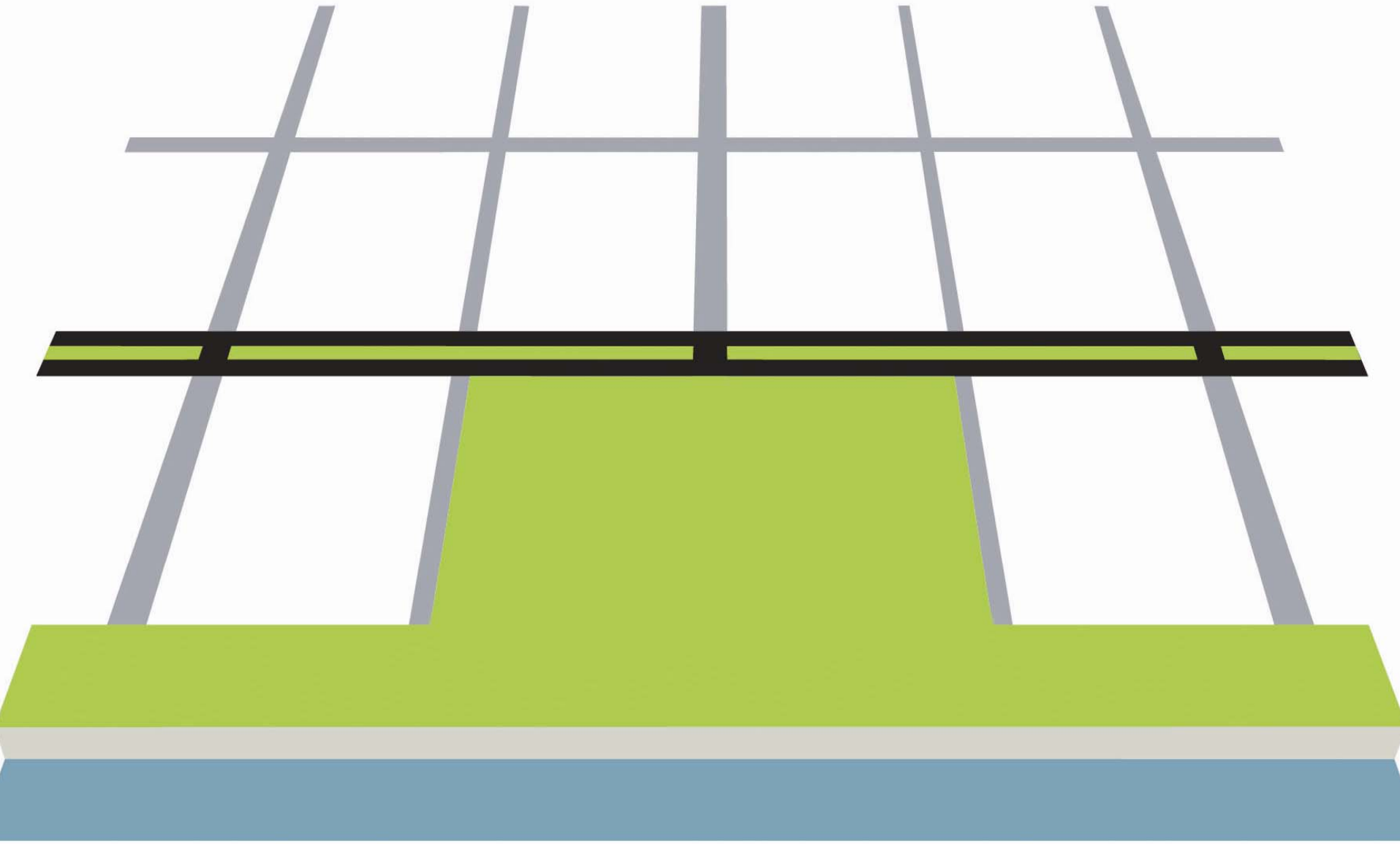

view sheds

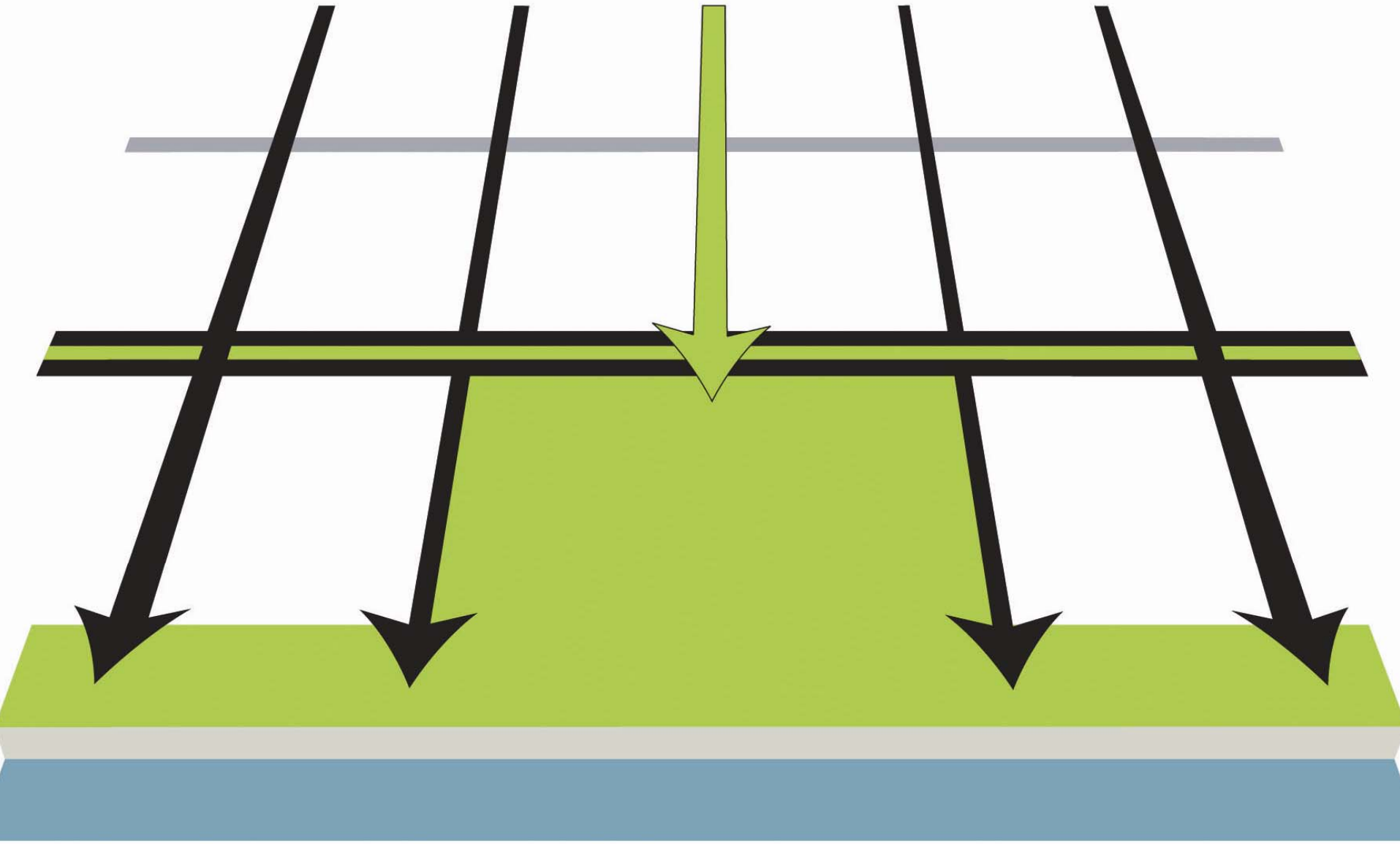

setbacks

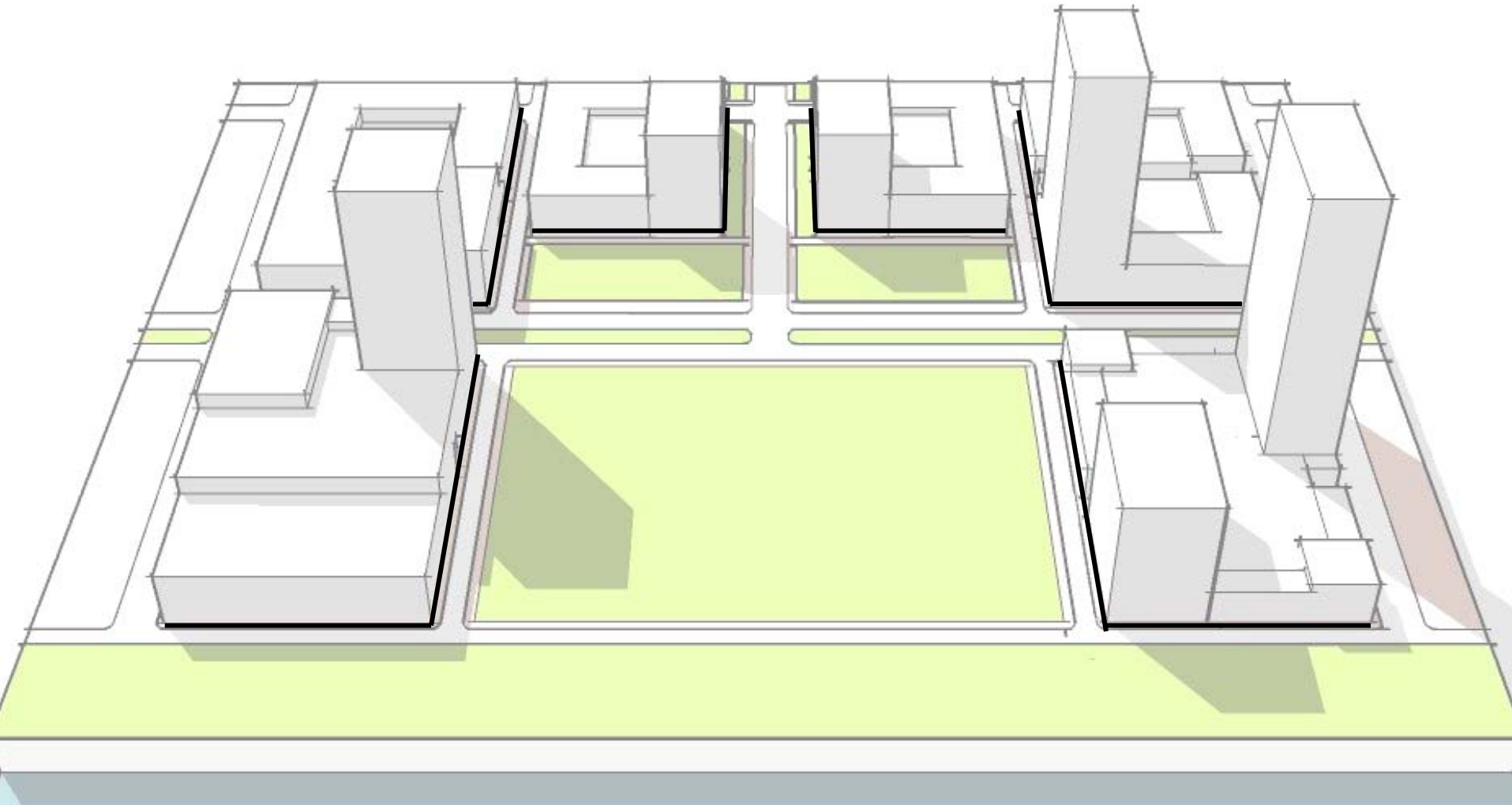

setbacks

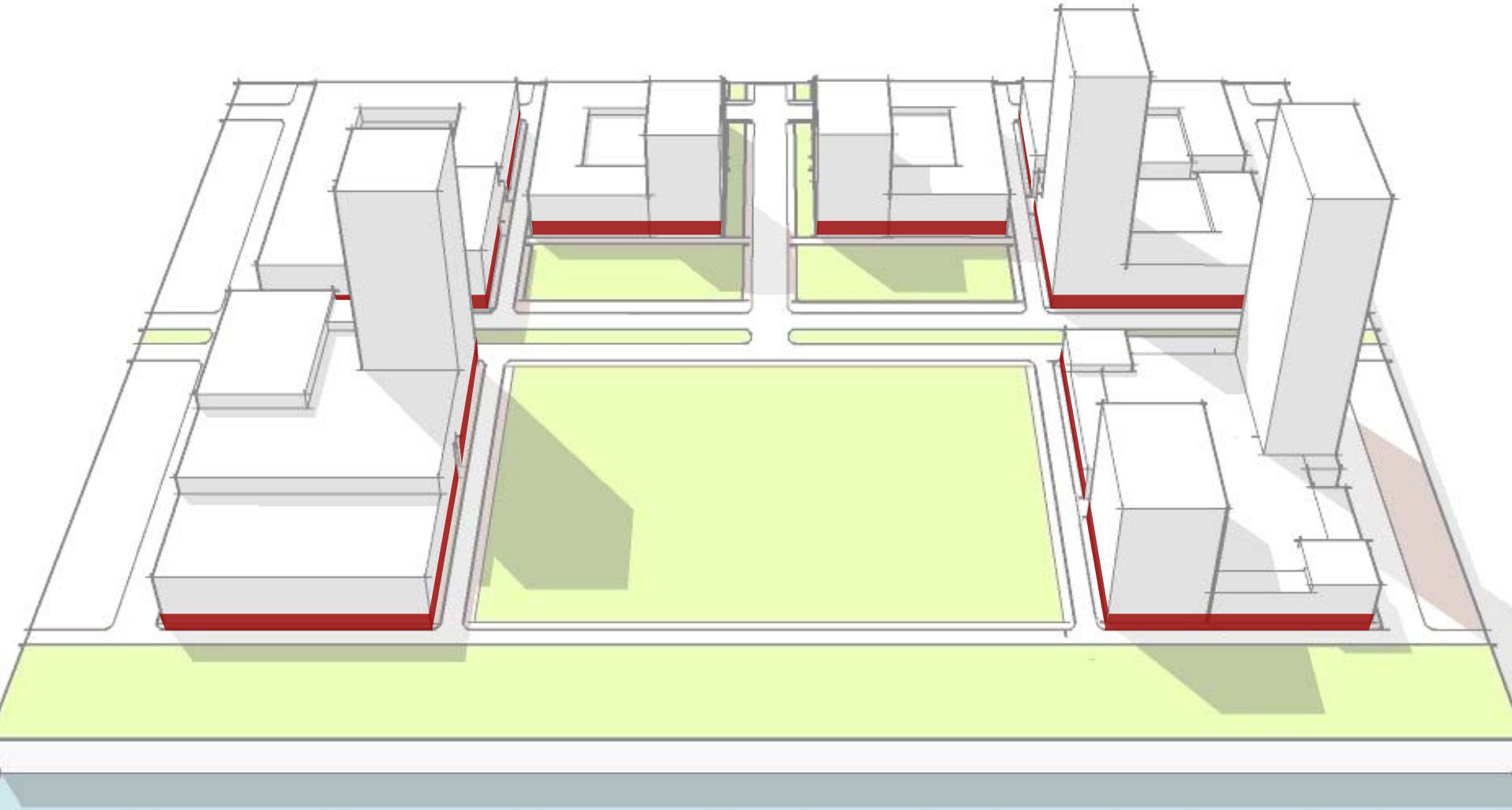

parking

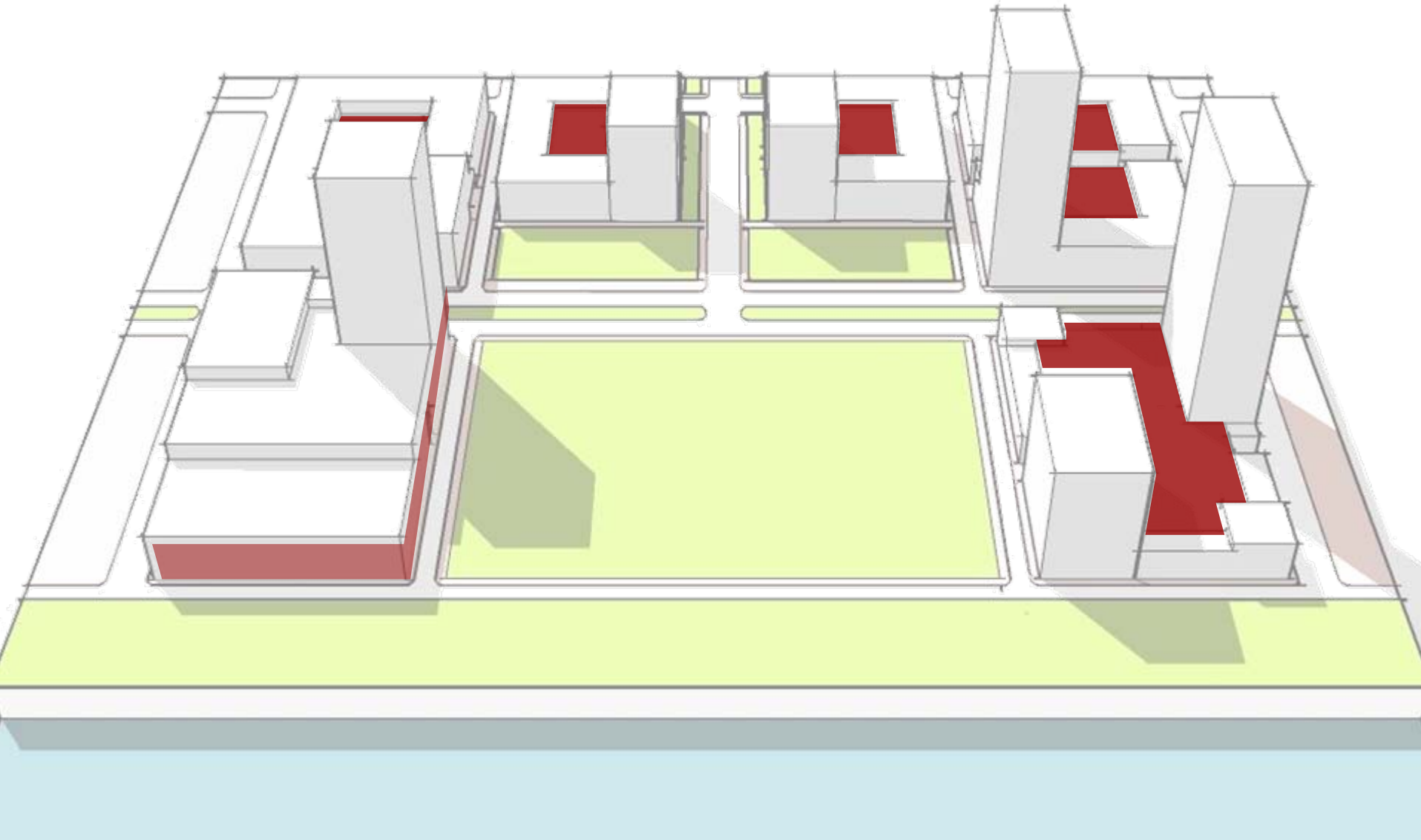

open space

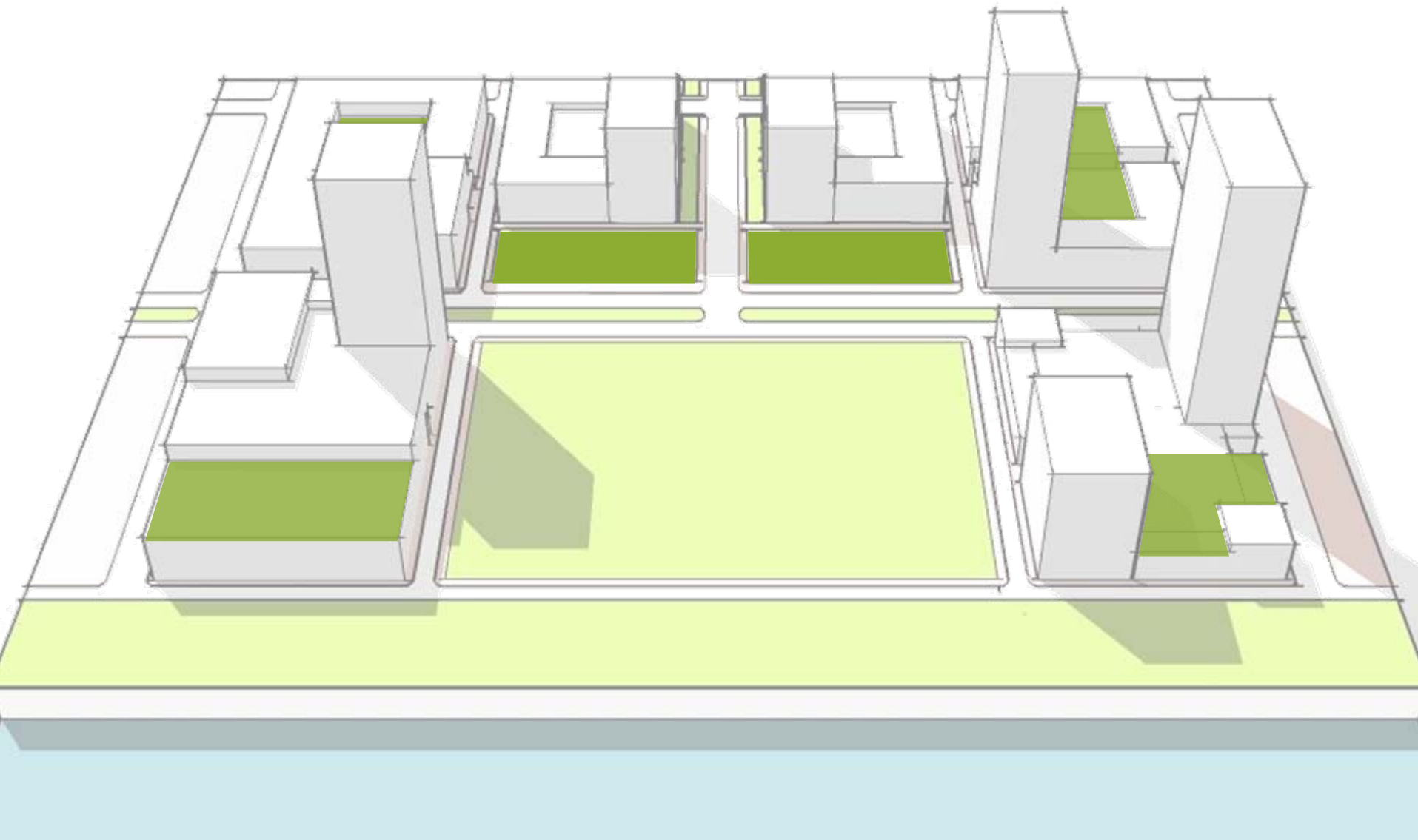

encourage taller buildings along open space

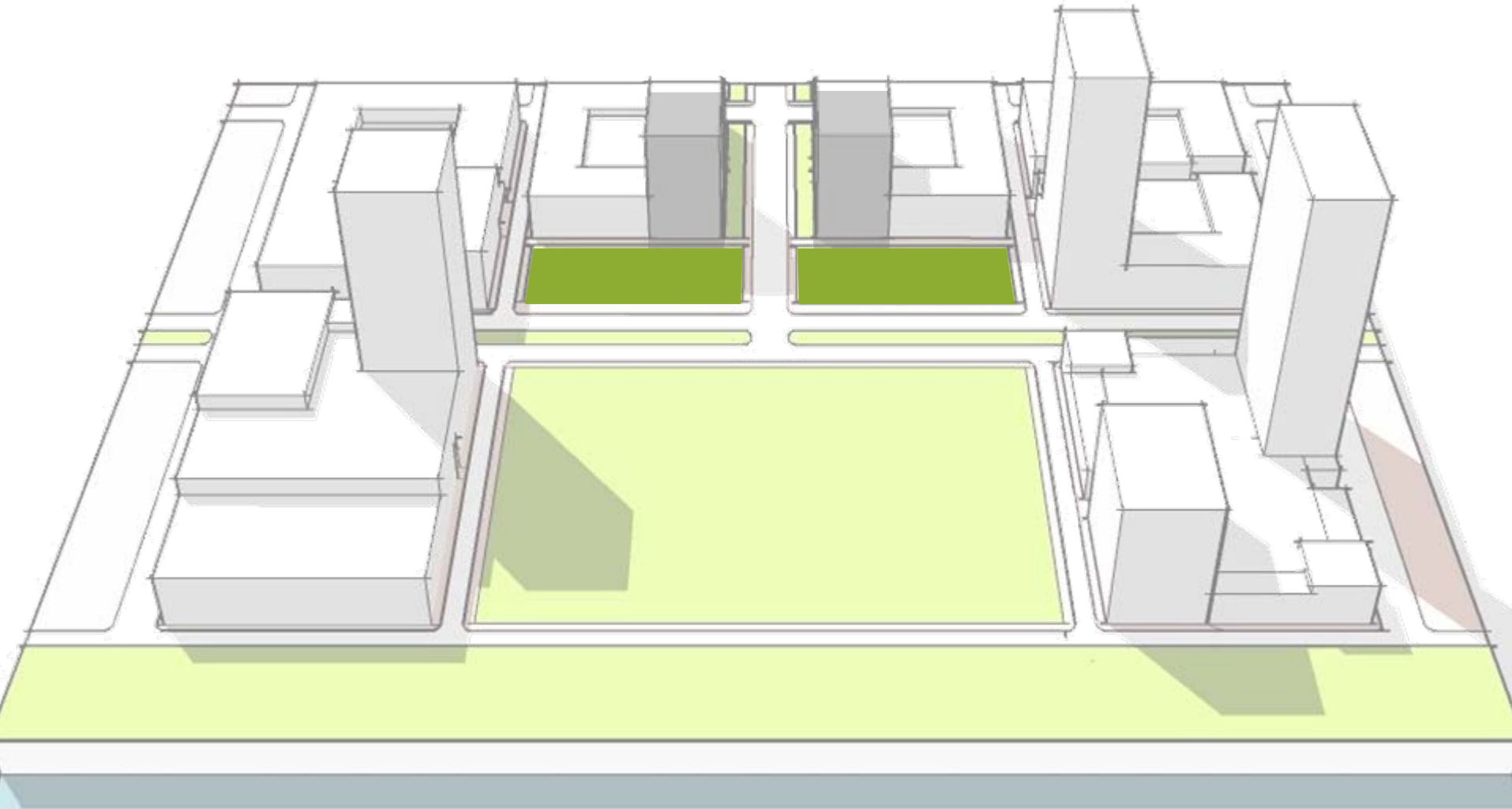

stagger towers and step buildings down to preserve views

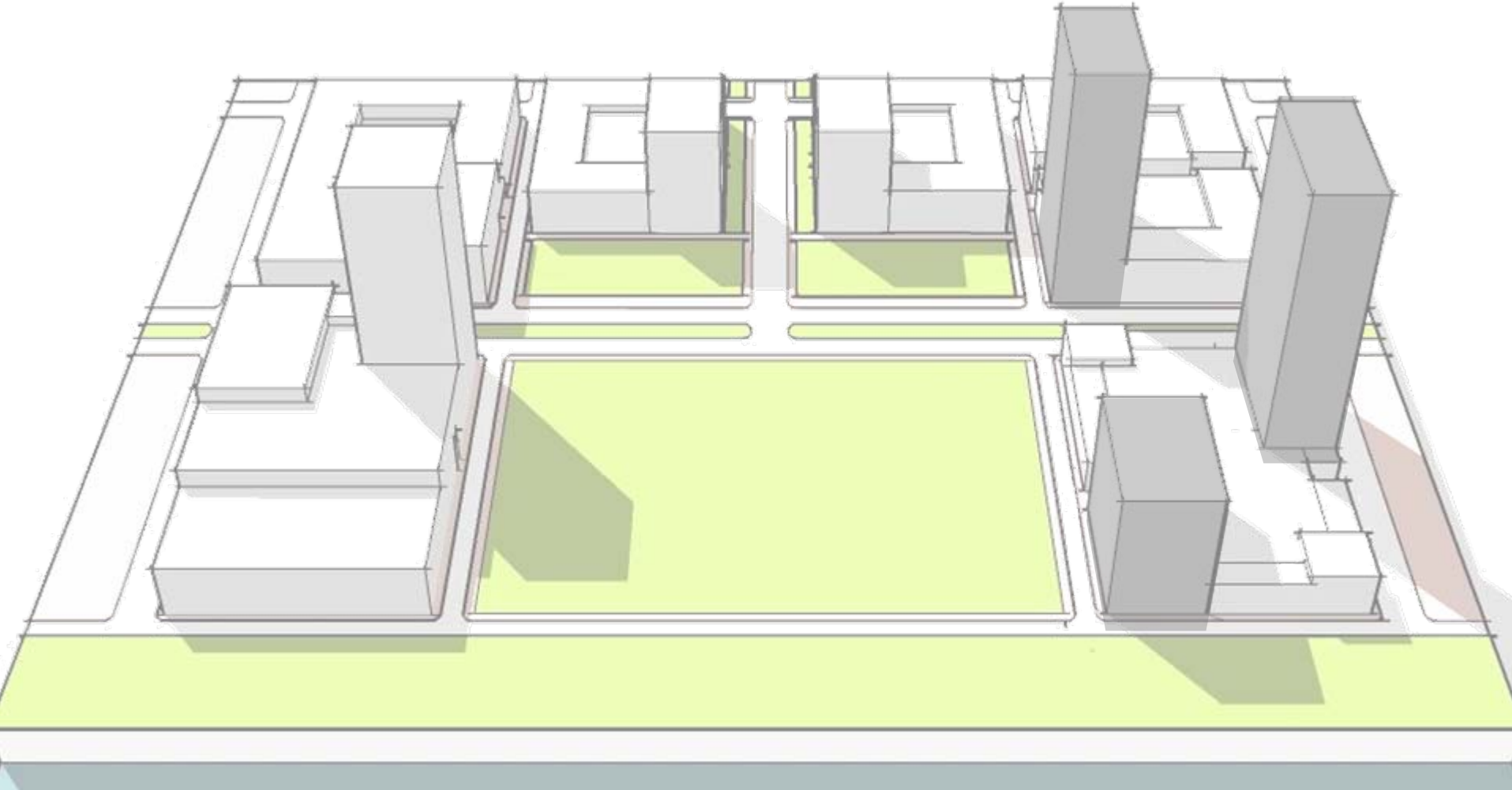

development design guidelines

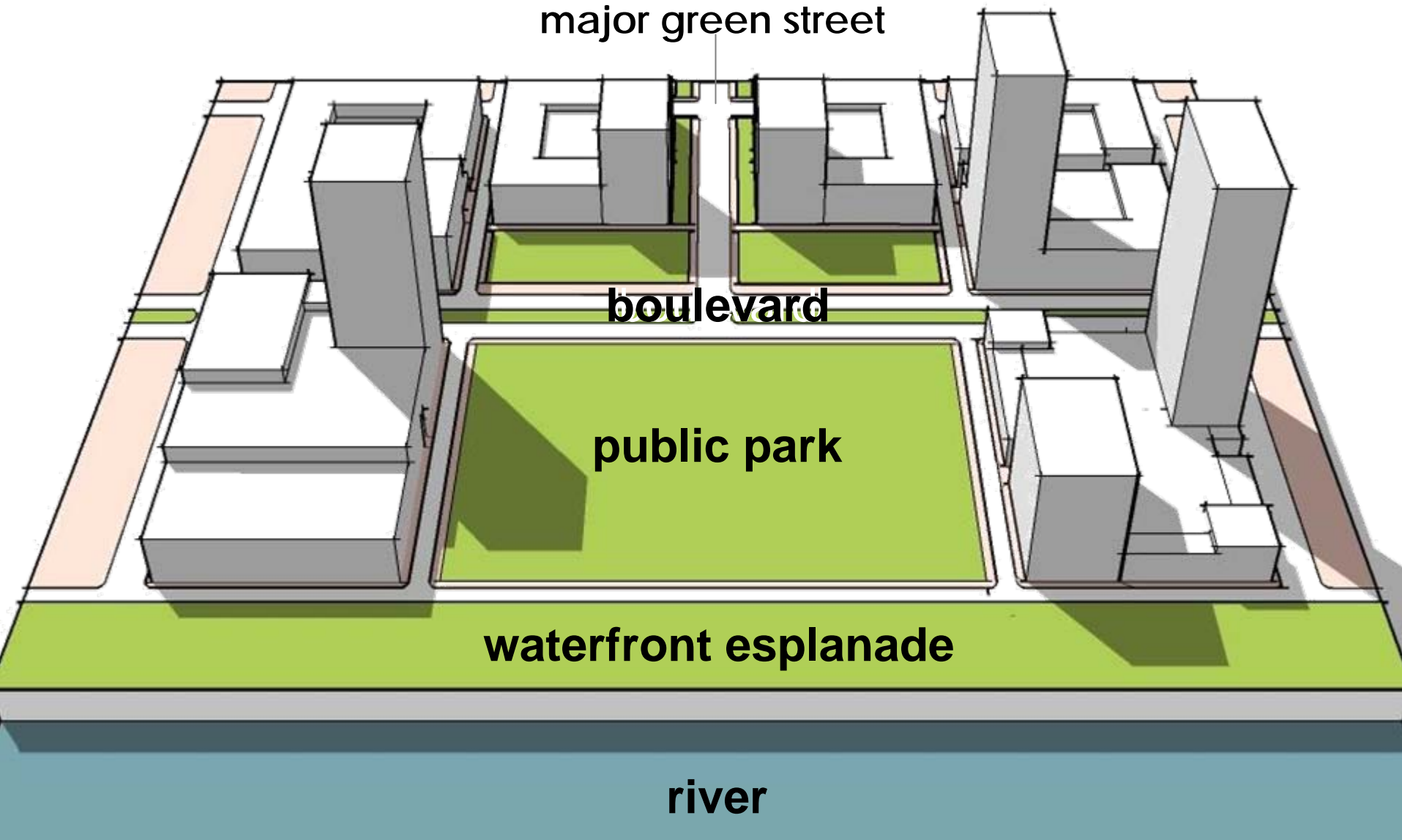

pier design guidelines - low density

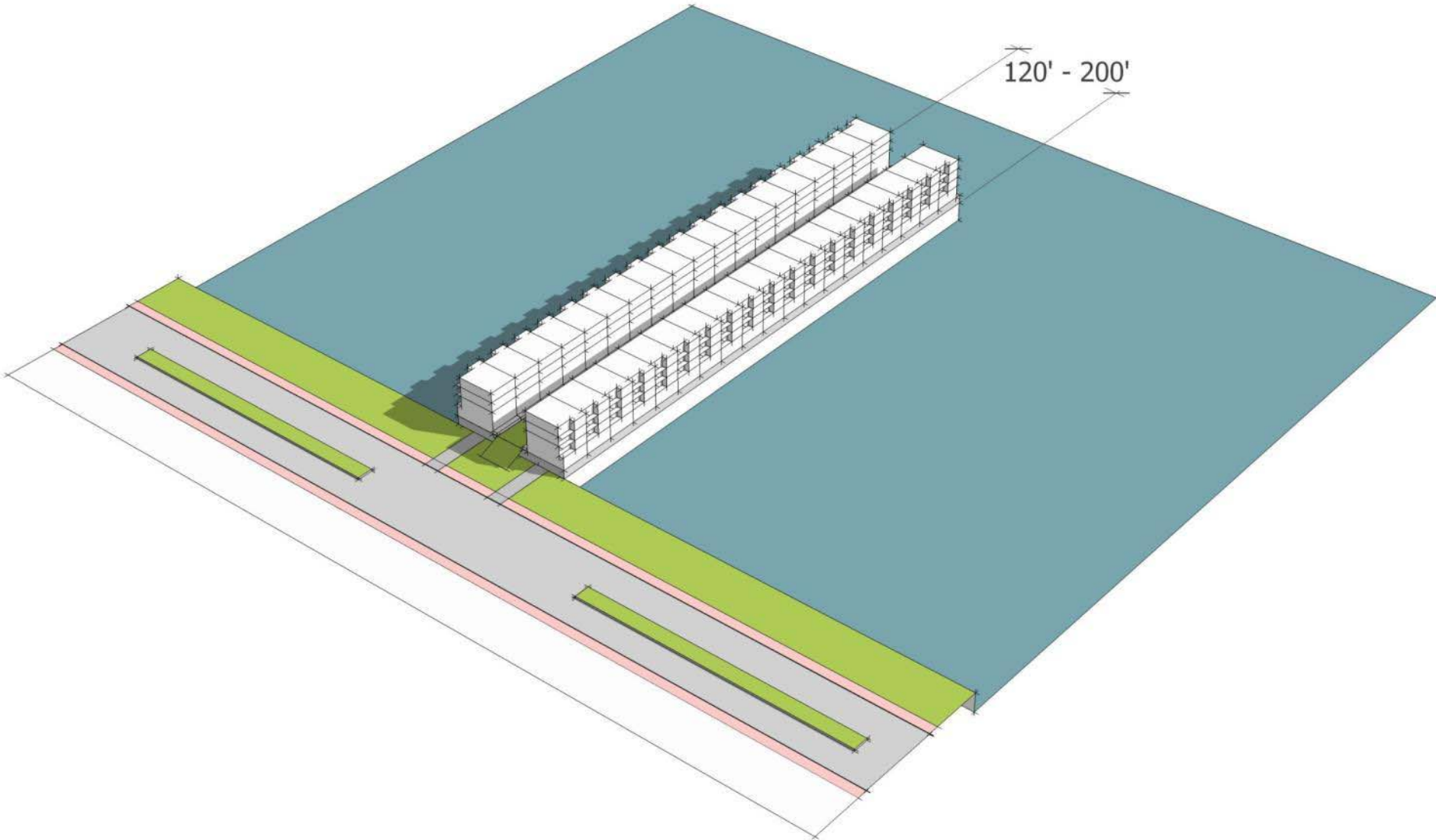

pier design guidelines - medium density

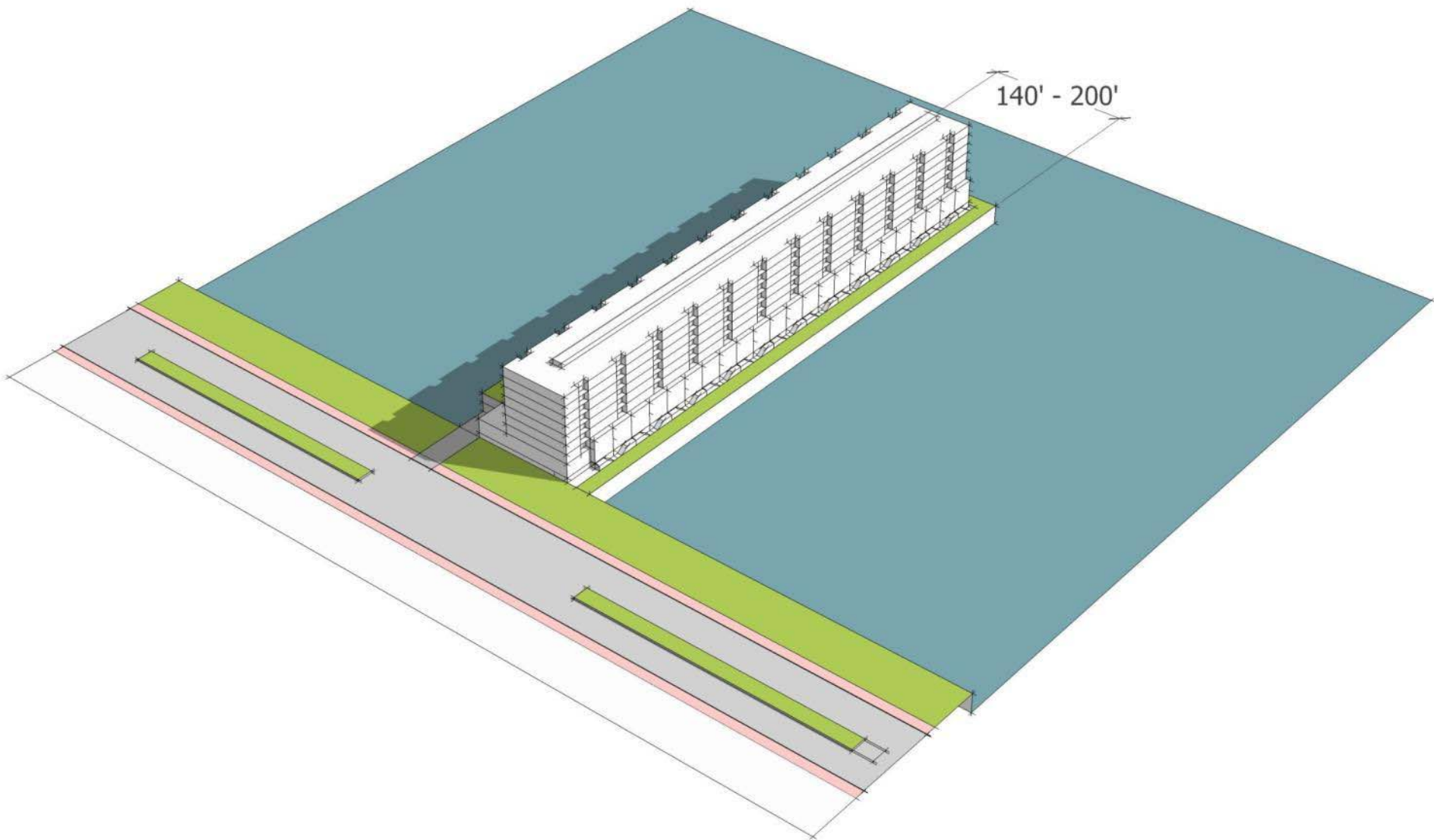

pier design guidelines – high density

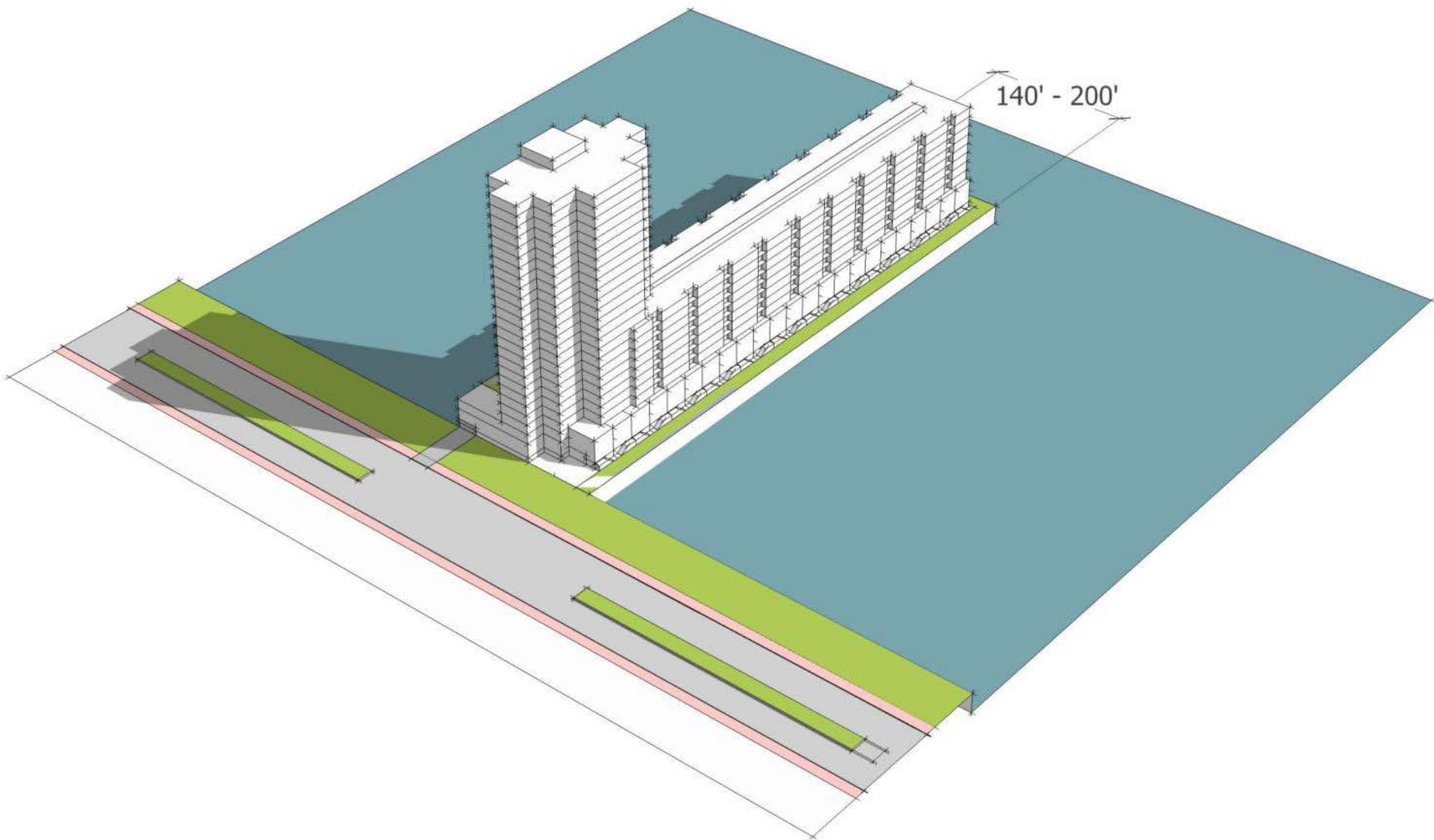

vision plan – existing conditions

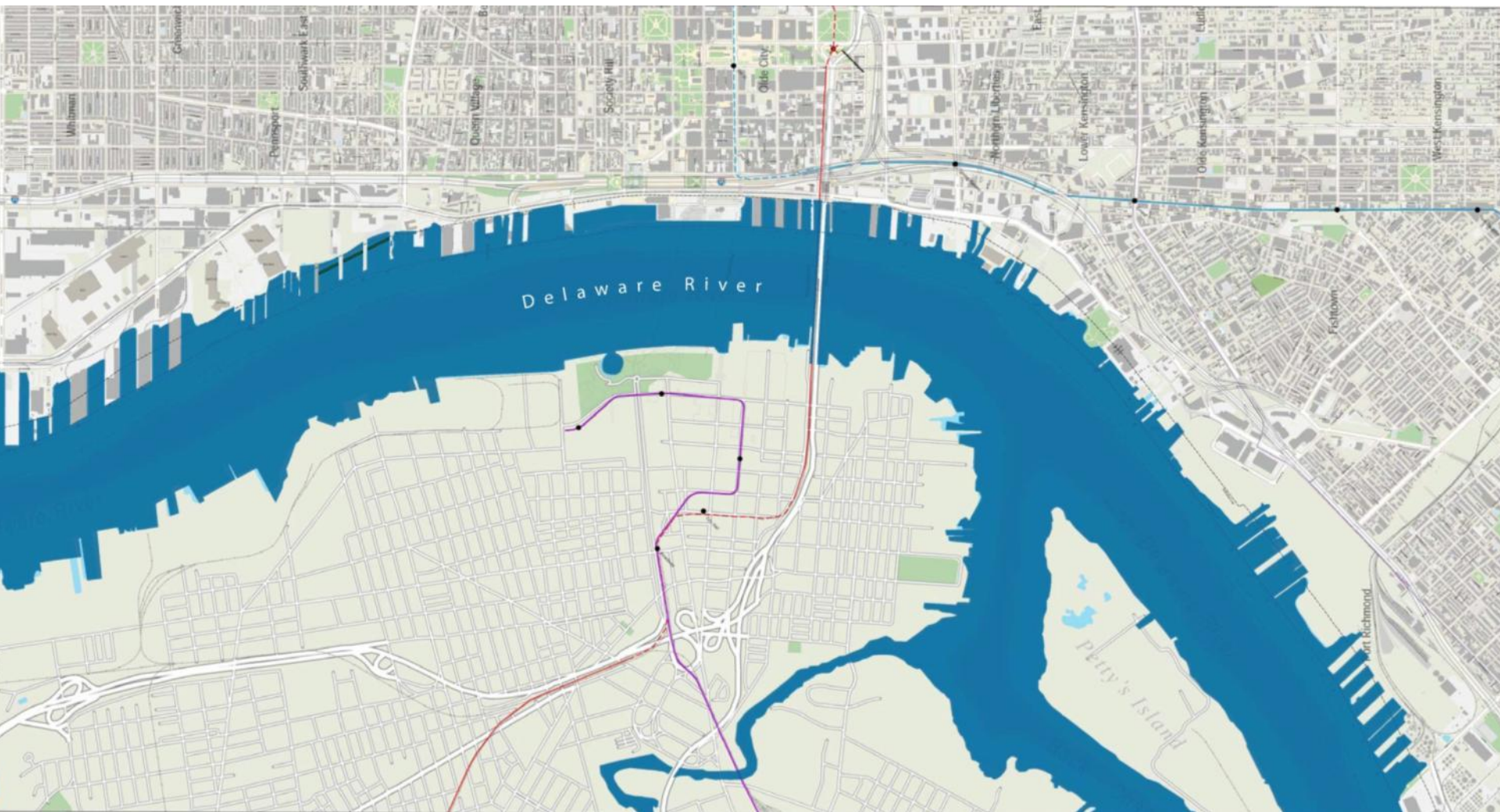

vision plan - draft

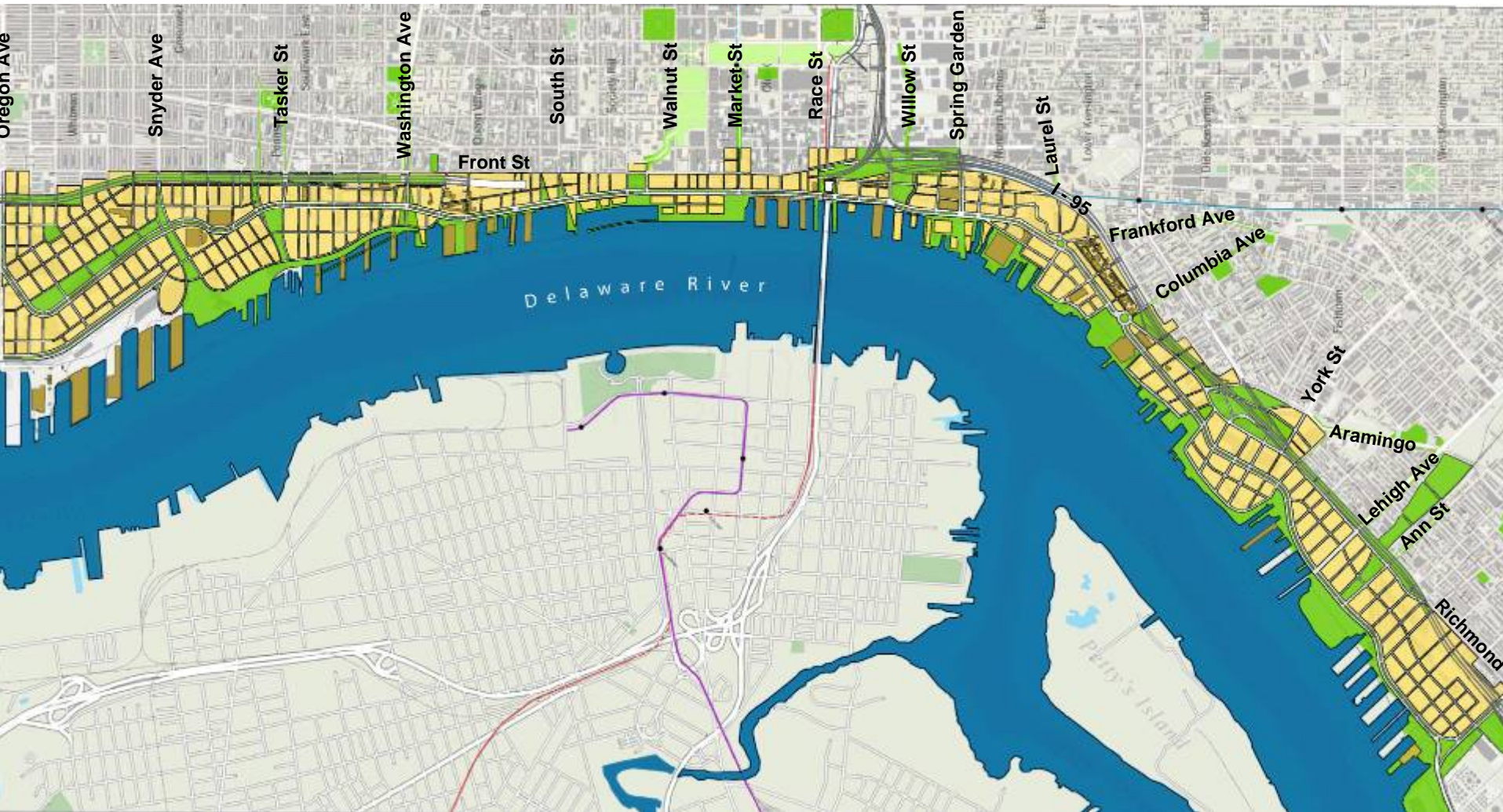

southern framework

existing

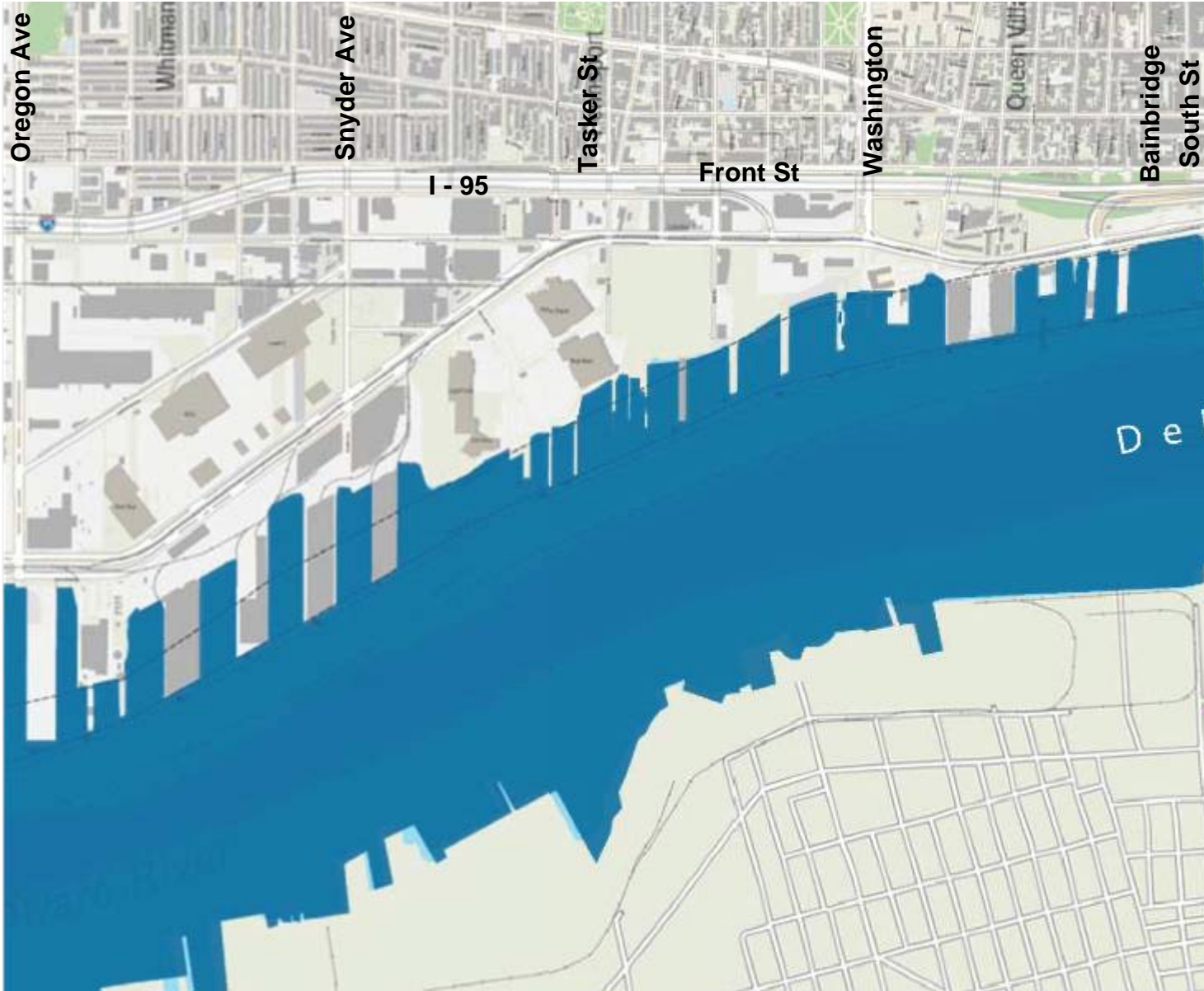

southern framework

proposed

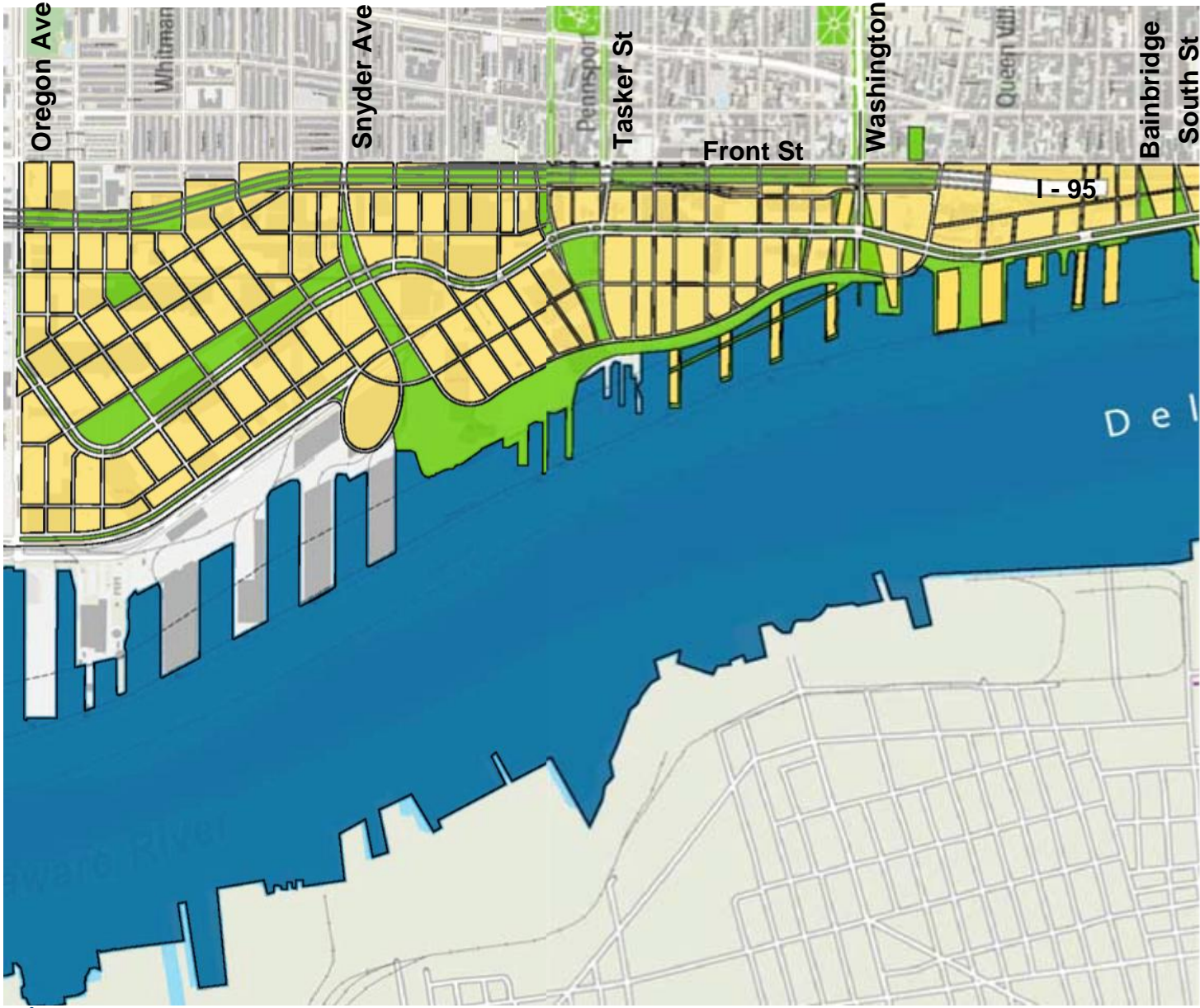

central framework

existing

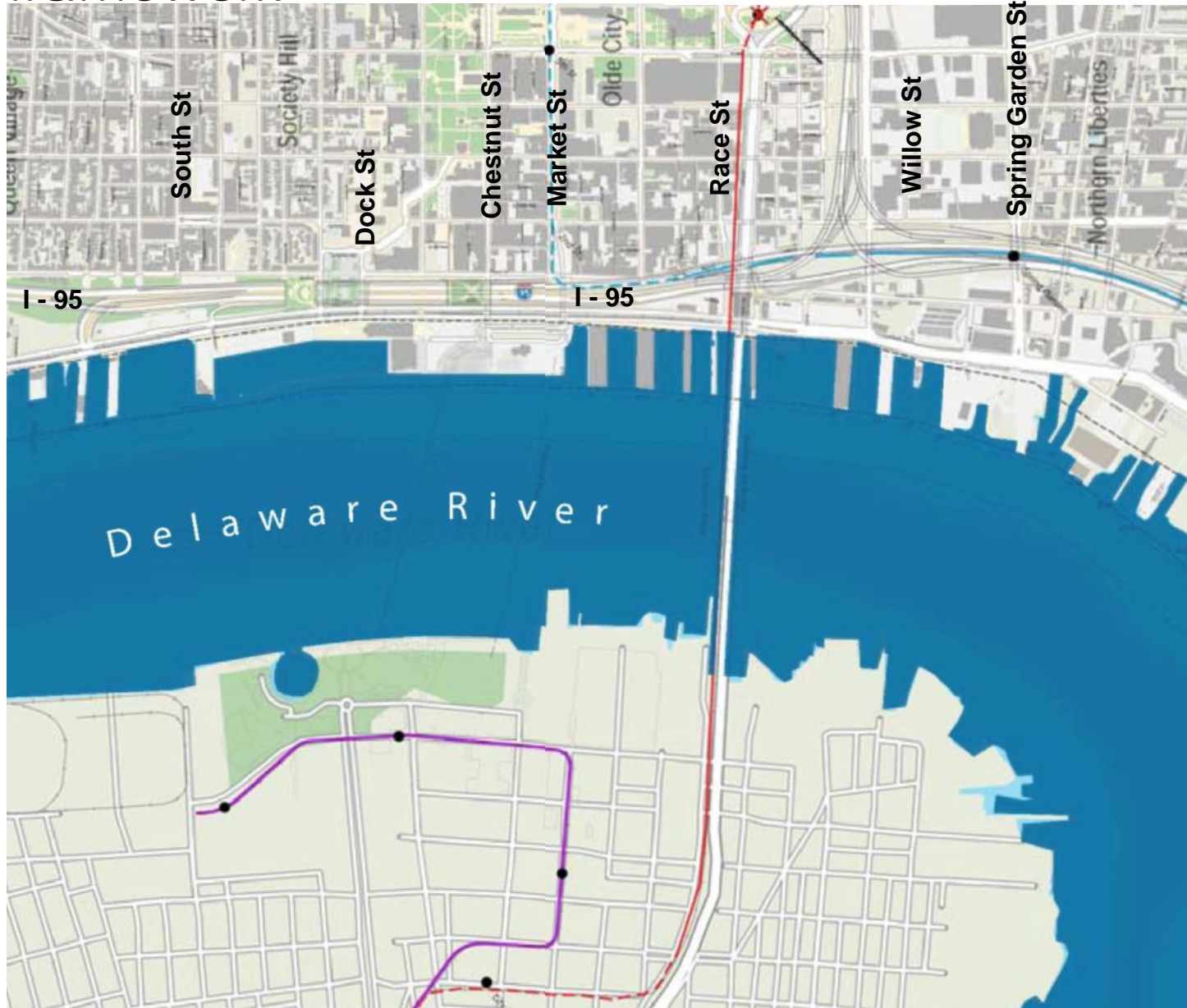

central framework

proposed

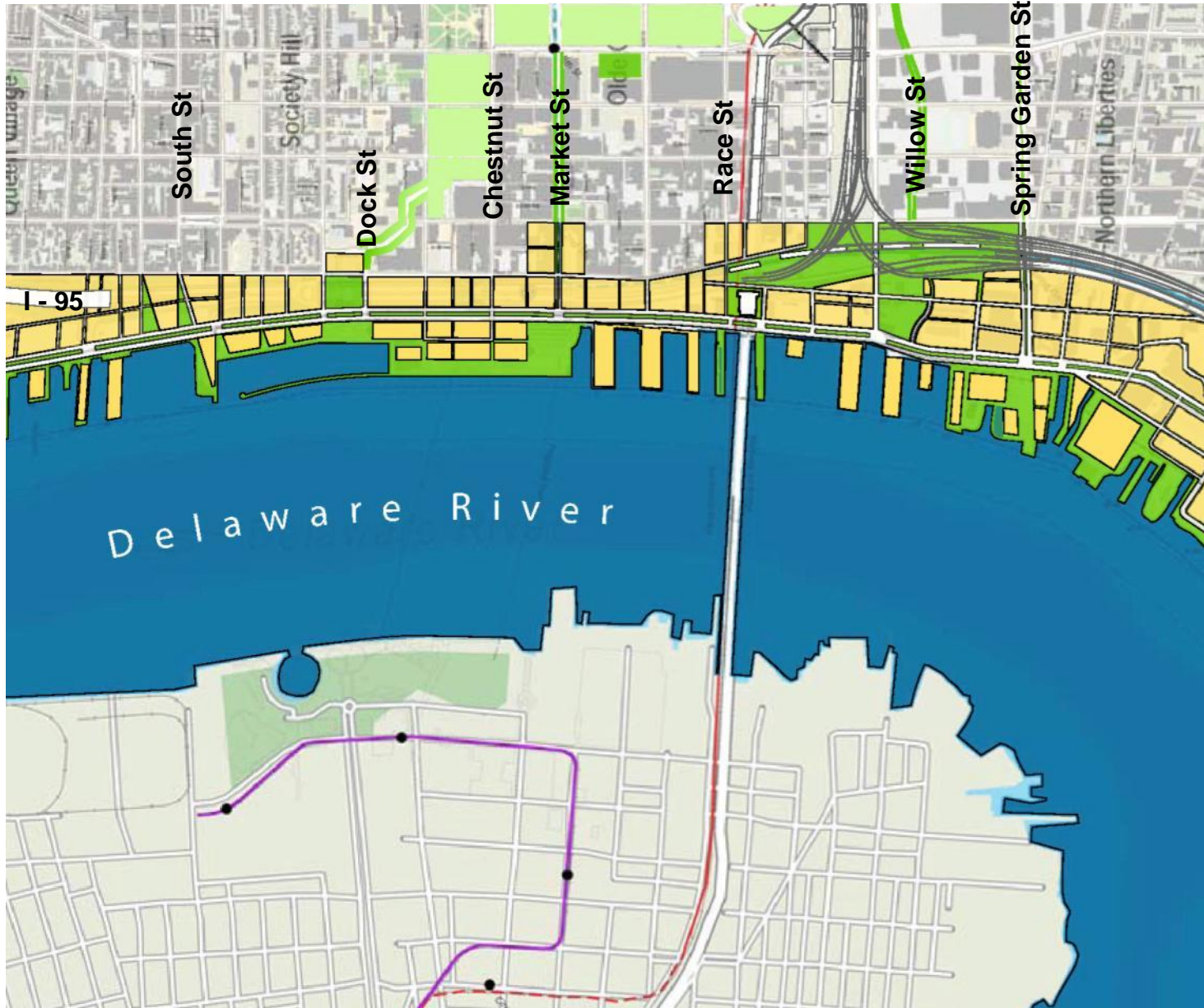

northern framework

existing

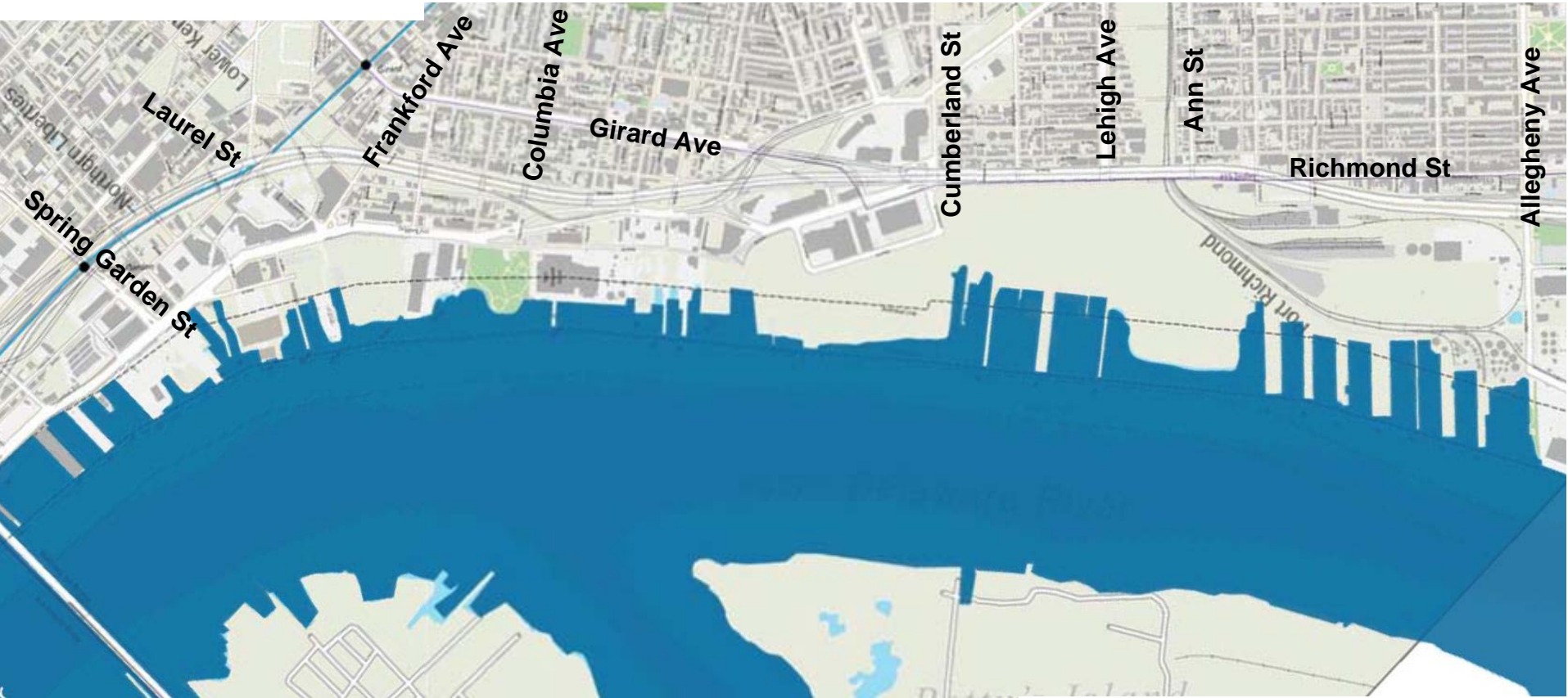

northern framework - 1

proposed



vision plan – draft

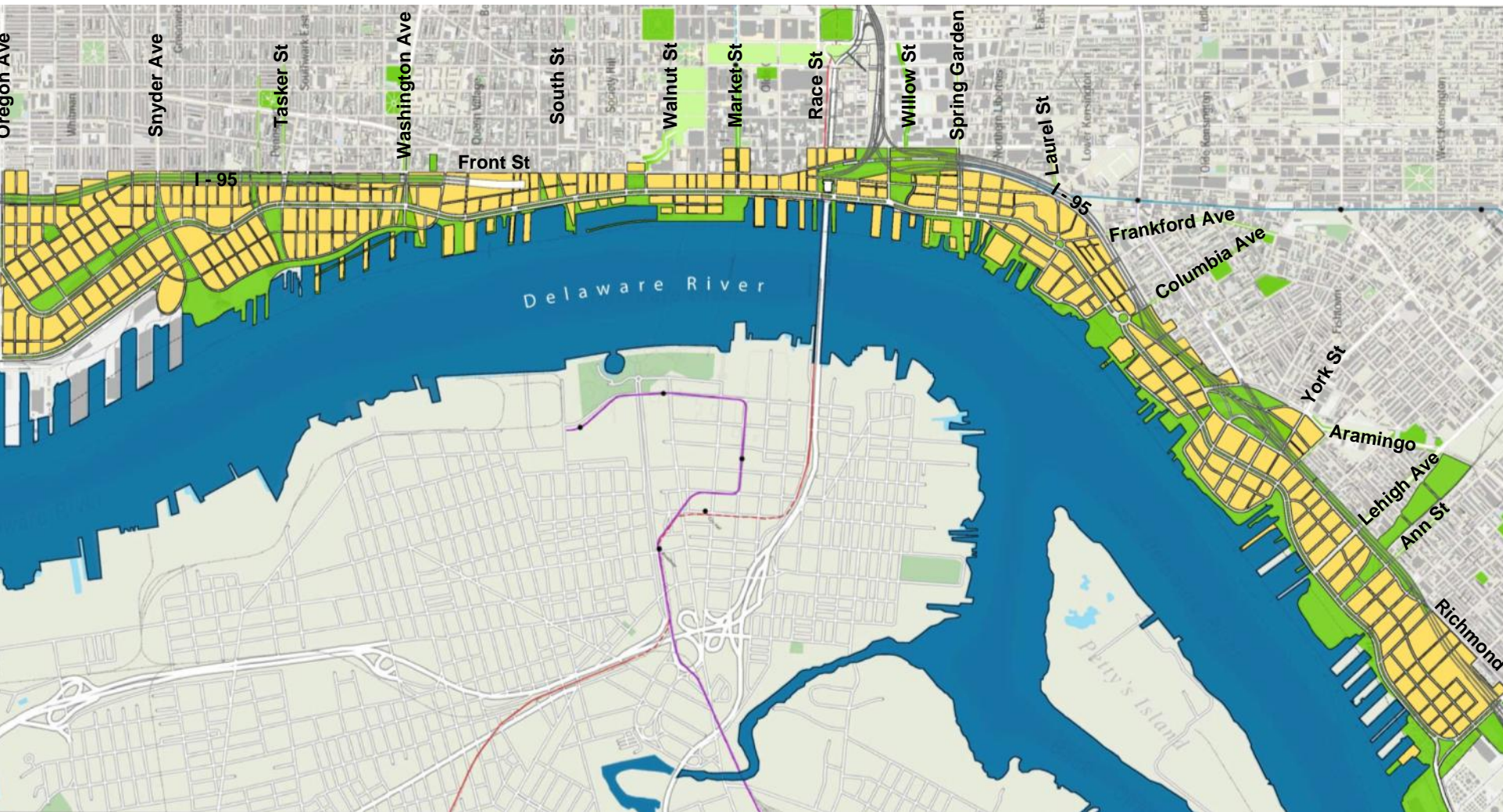



Millennium Park, Chicago



Duisburg Nord – Emscher Park



Seattle – Sculpture Park



Seattle



Hudson River Park



Milwaukee



Middle Harbor Shoreline Park, Oakland, CA



Saint-Pierre Park, Amiens, France



The Netherlands



Baltimore



© SOM / Steinkamp Ballogg Photography

State Street Chicago



© www.aviewoncities.com

New York: South Street Seaport Mall



Hammersmith, London



Barcelona



San Francisco



San Francisco



New York



Eastlake Park, Netherlands



South London



Madrid, Spain

next steps

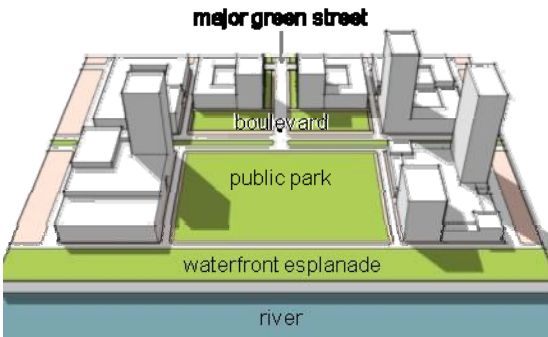

- implementation study and research
- zoning overlay
- continued stakeholder engagement
- technical document November 2007
- interim demonstration projects

Vision plan

